

**V35**

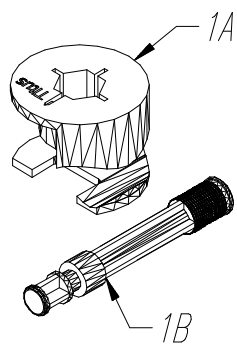

20x

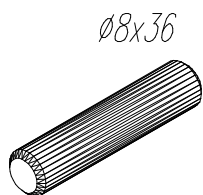

22x

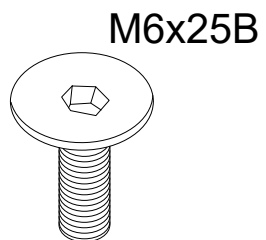

16x

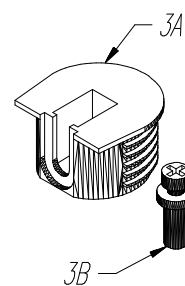

8x

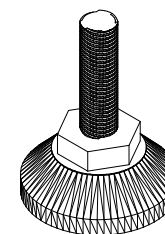

6x

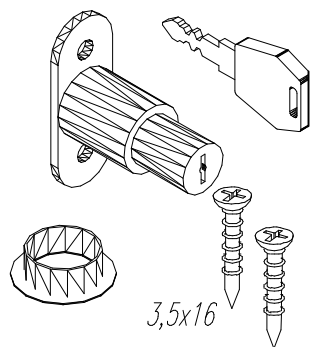

1x

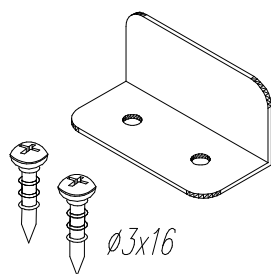

1x

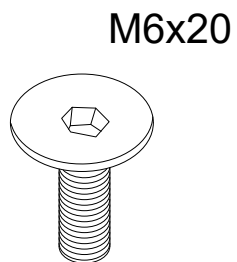

16x

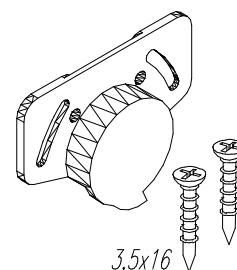

2x

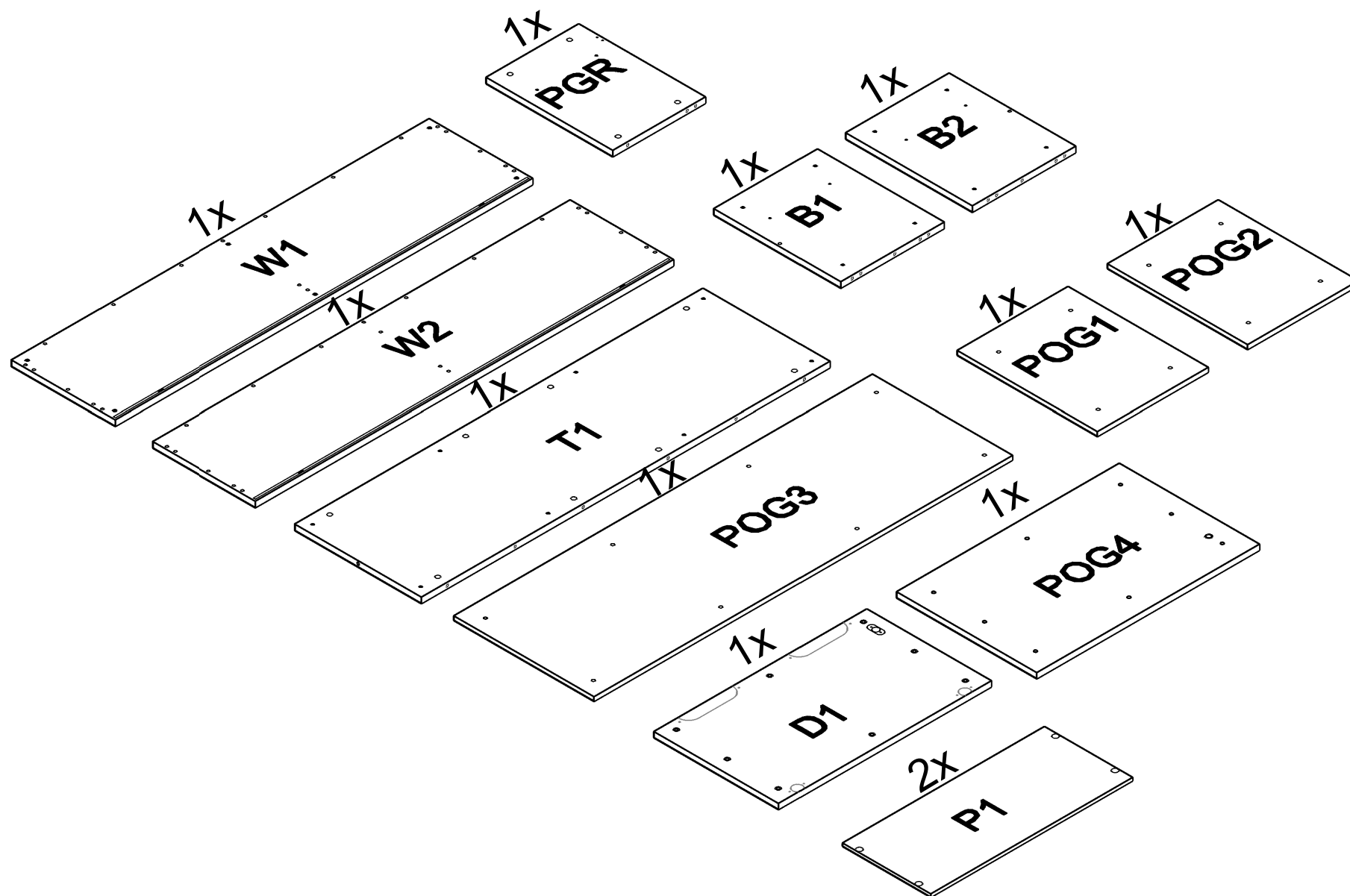

A

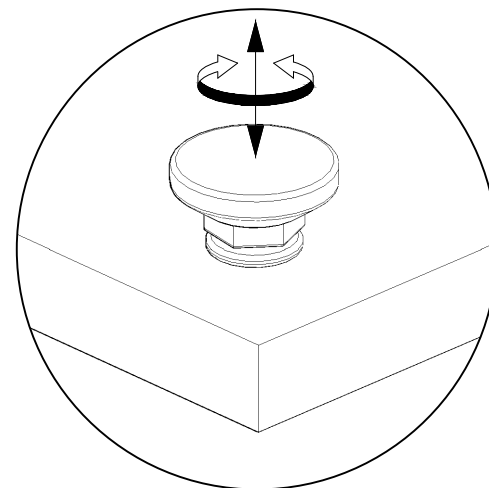
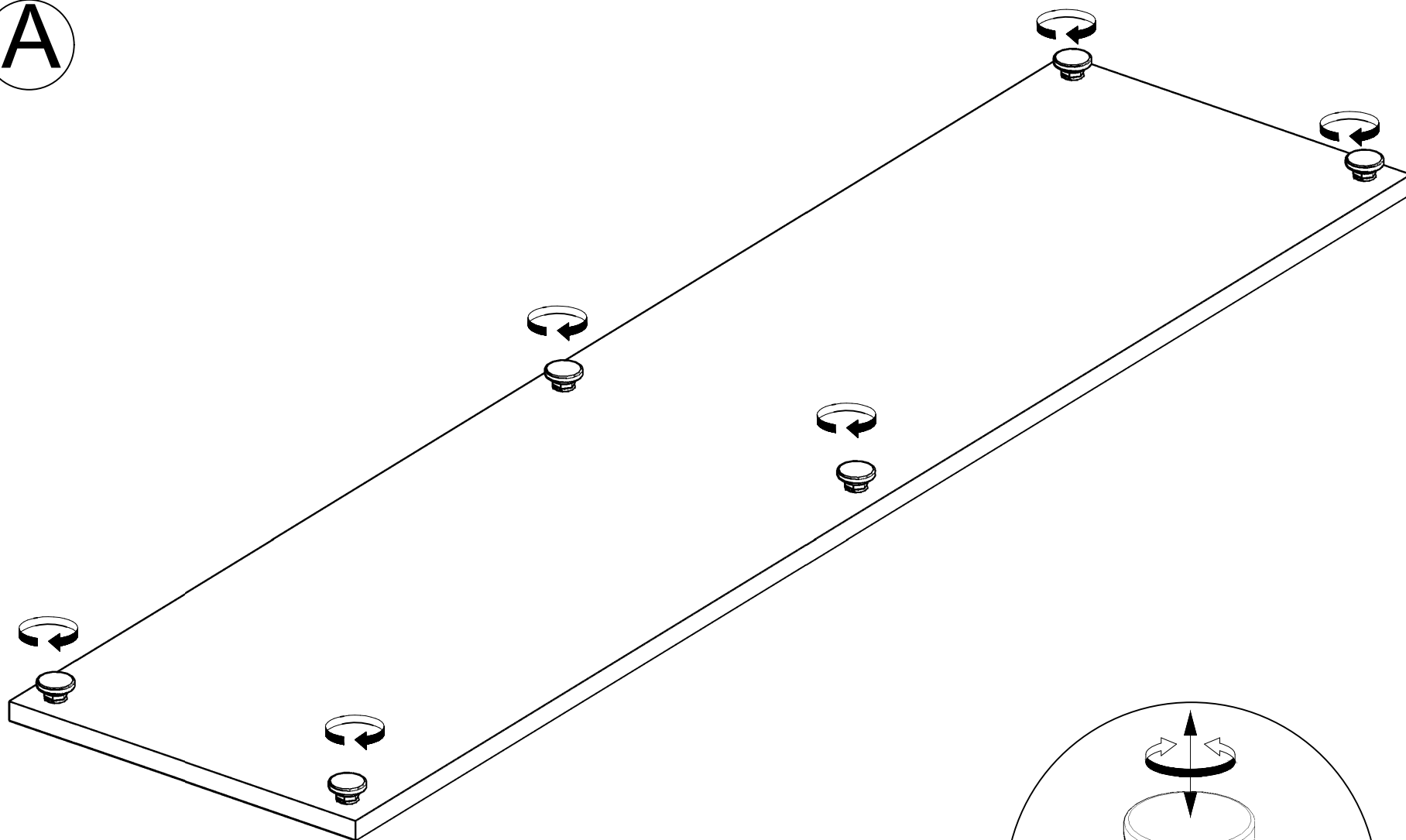

**B**

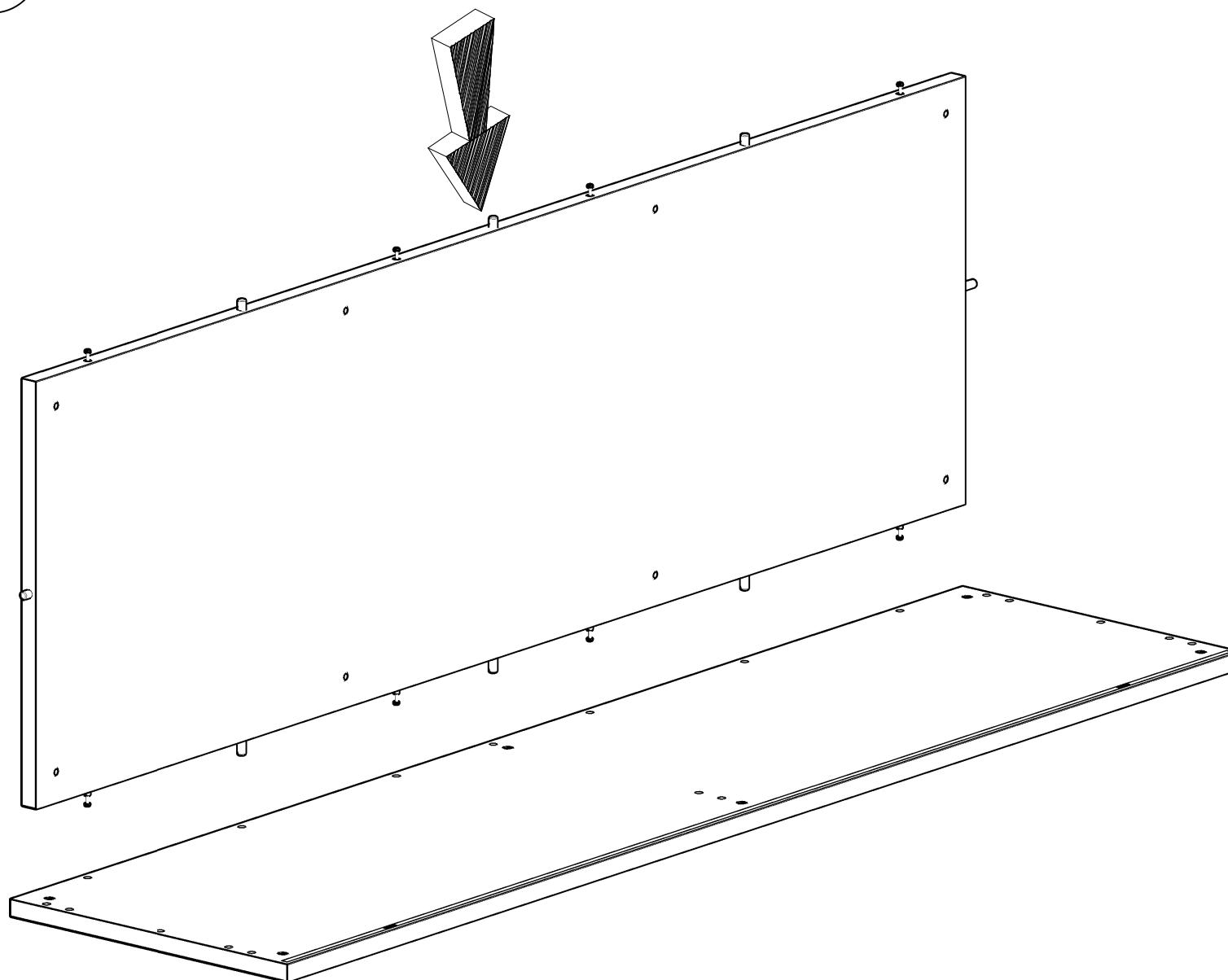

KOLEJNOŚĆ MONTAŻU  
MIMOSRODÓW I KOŁKÓW.  
THE FITTINGS SEQUENCE OF THE  
CAMS AND DOWELS.  
DIE MONTAGEABFOLGE VON  
EXZENTERN UND DÜBELN.

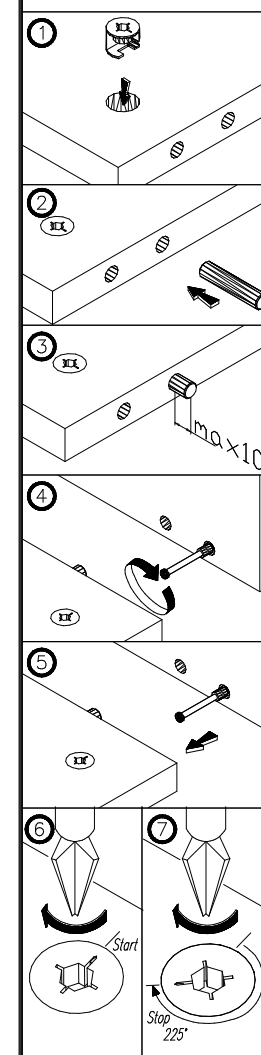

C

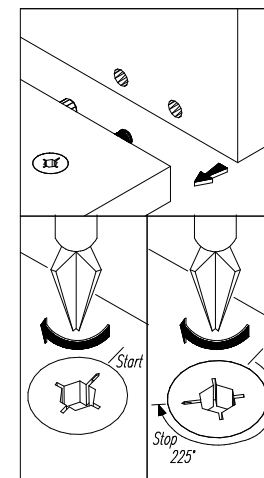
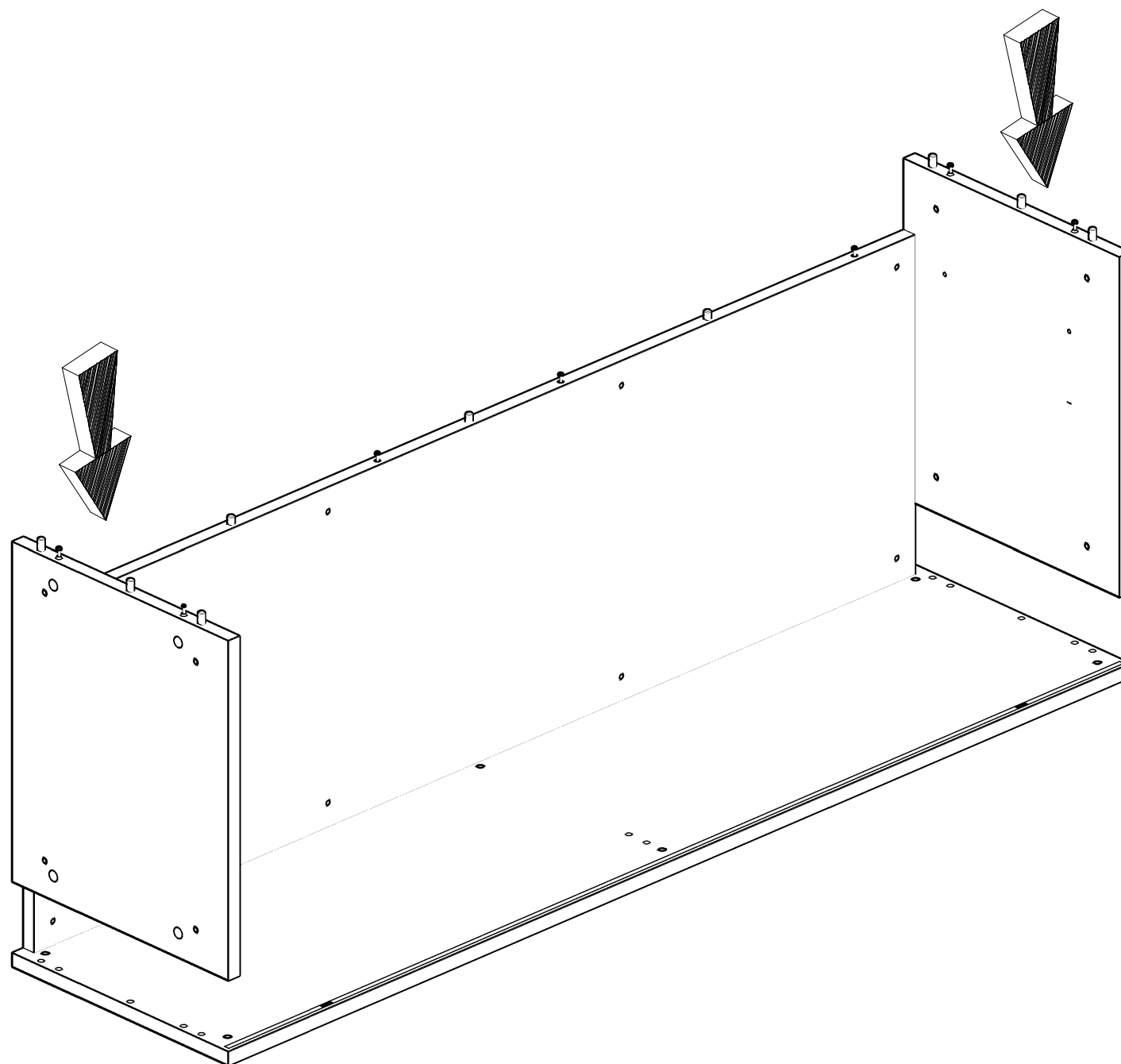

D

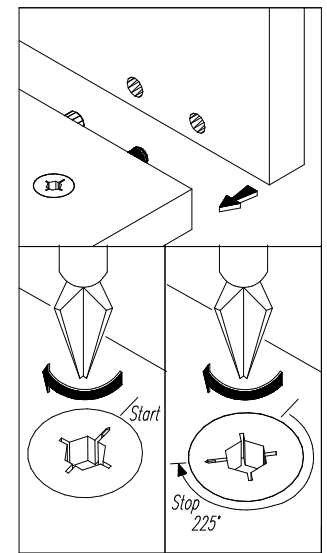
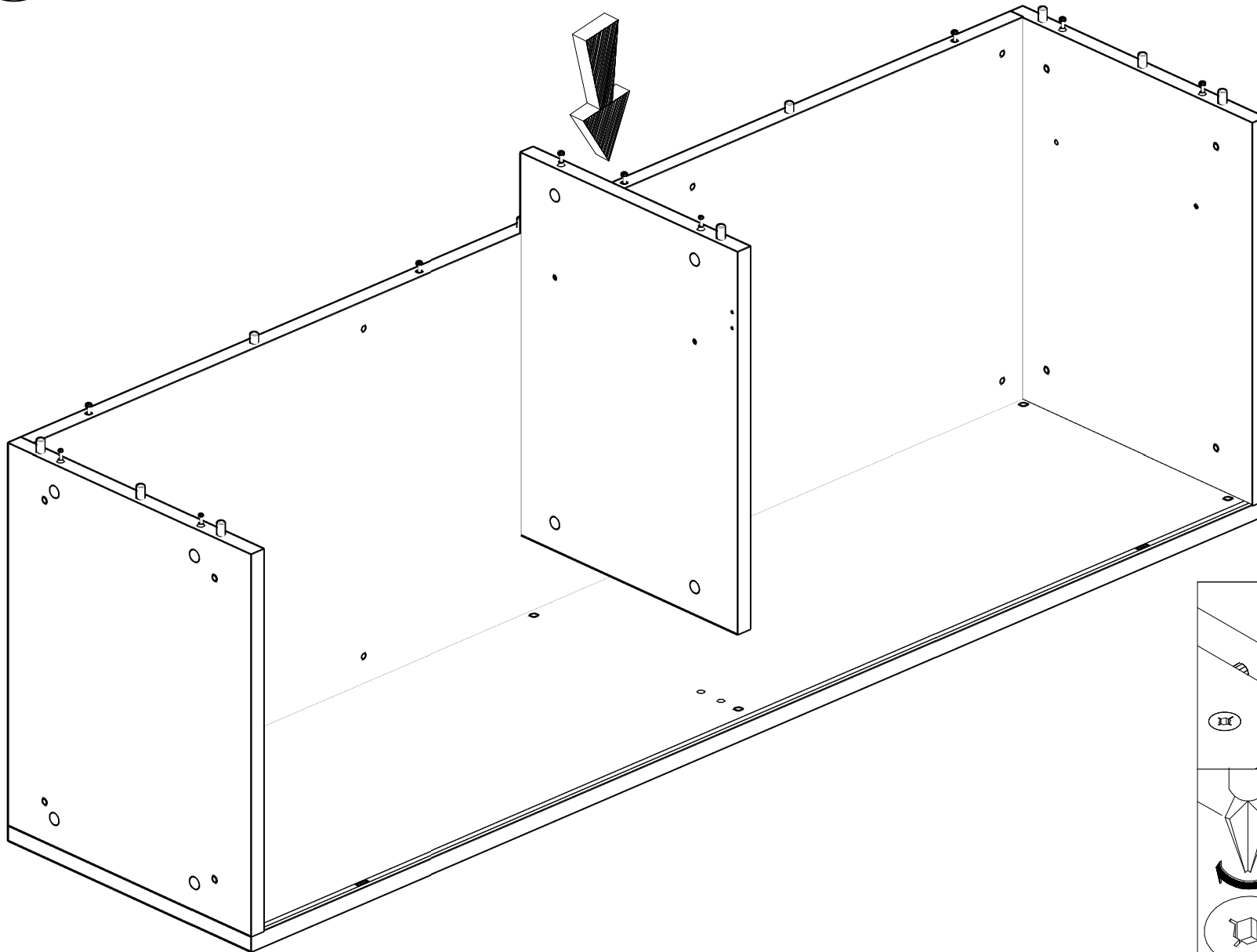

E

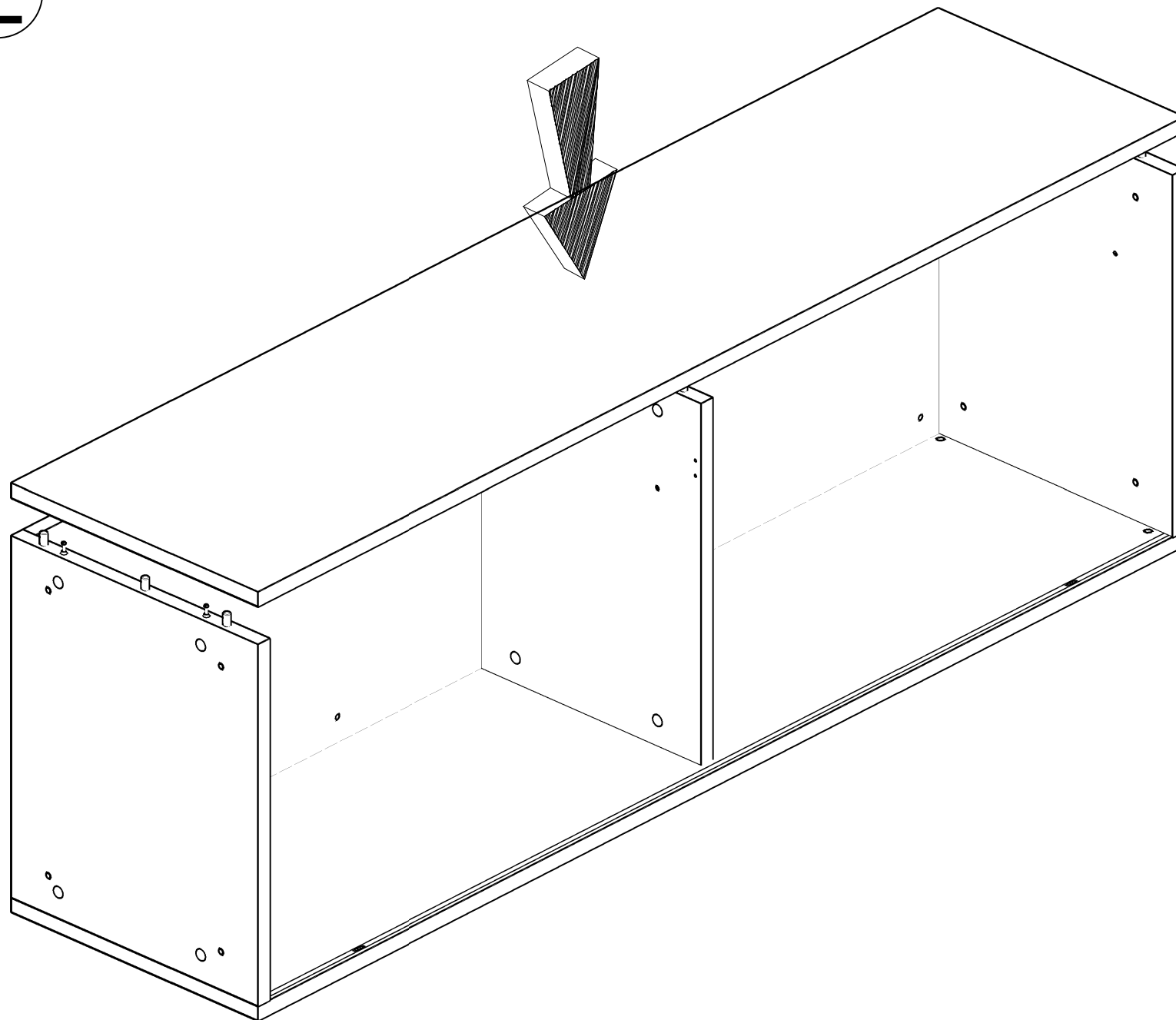

KOLEJNOŚĆ MONTAŻU  
MIMOŚRODÓW I KOŁKÓW.  
THE FITTINGS SEQUENCE OF THE  
CAMS AND DOWELS.  
DIE MONTAGEABFOLGE VON  
EXZENTERN UND DÜBELN.

1

2

3

4

5

6



F

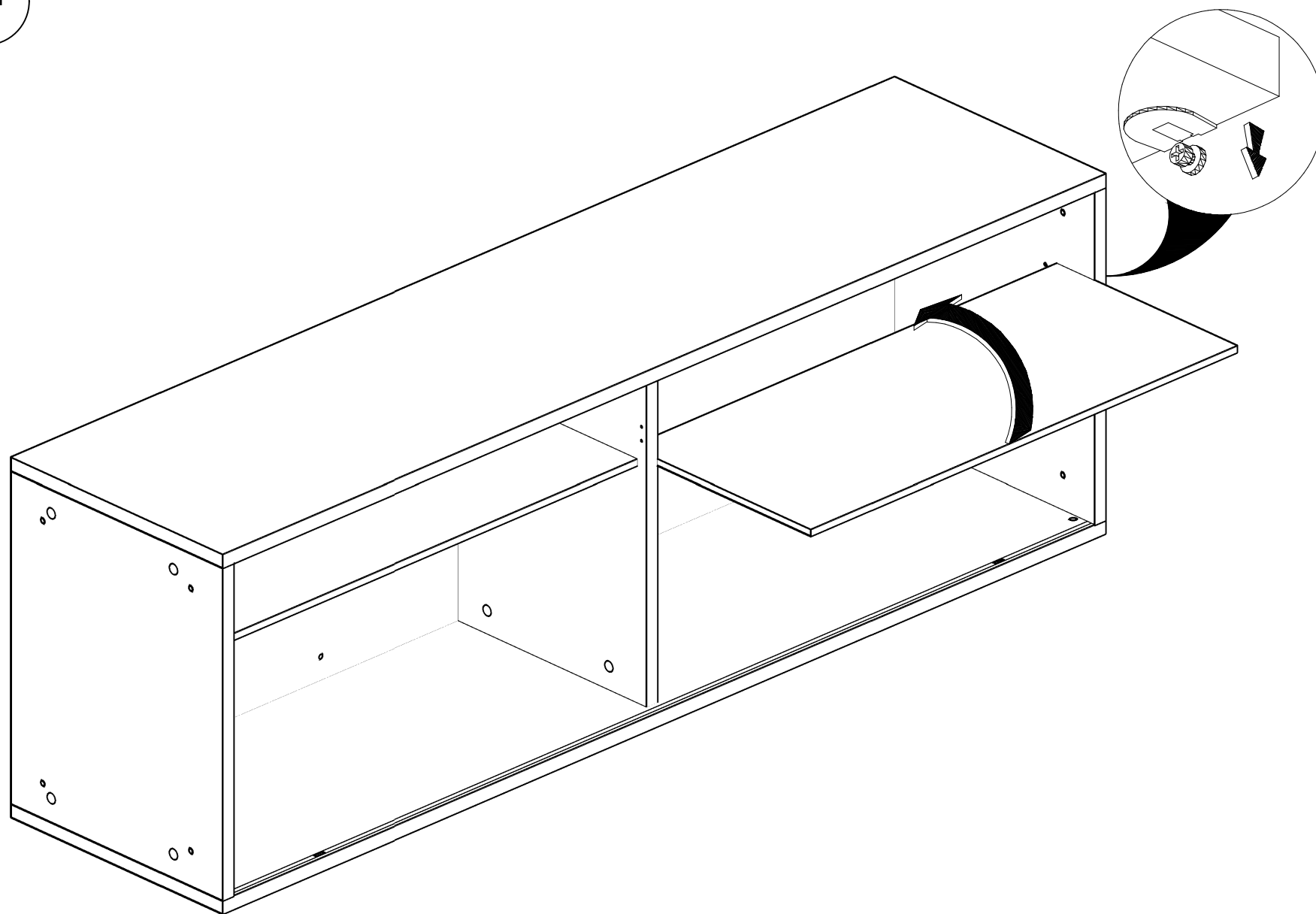

G

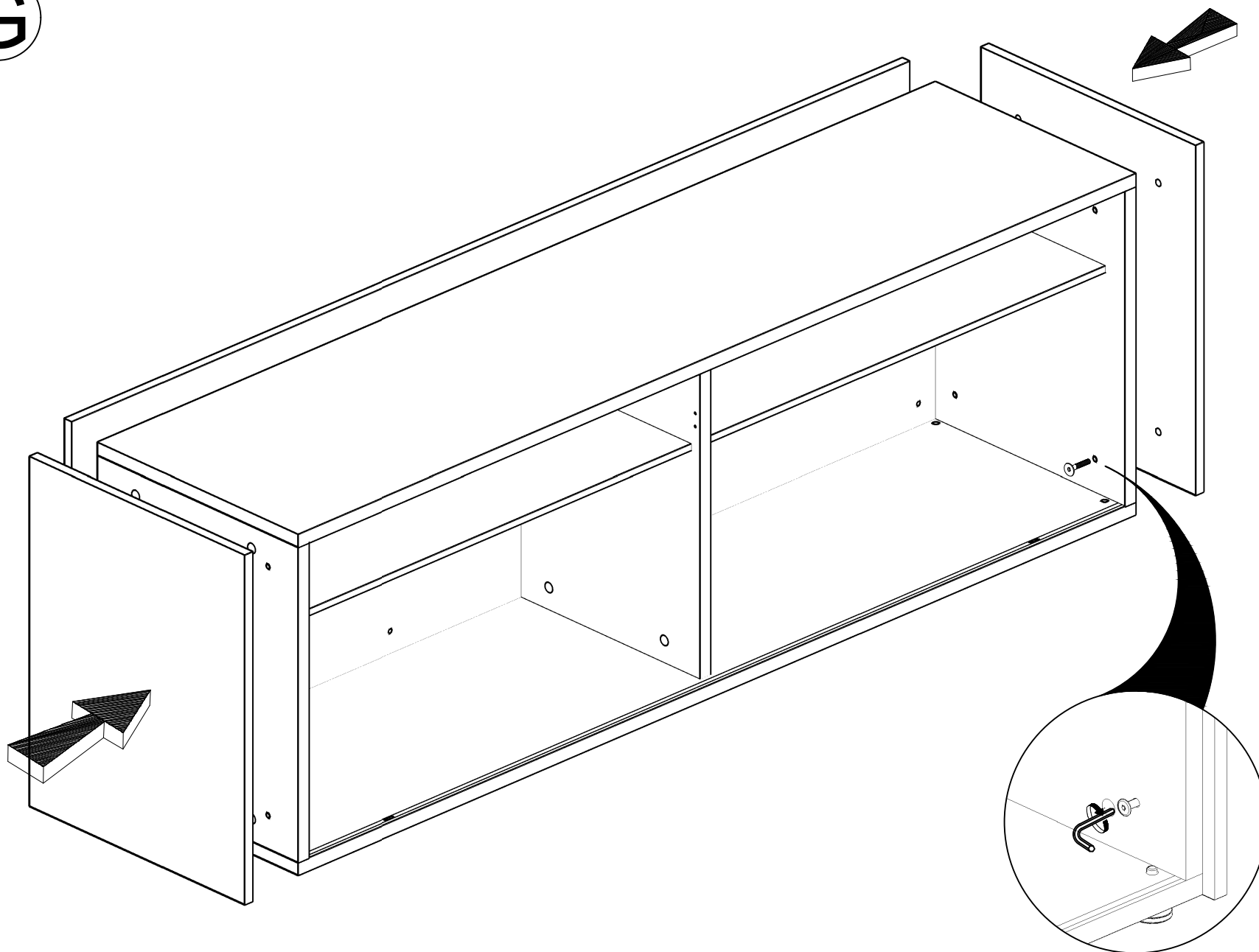

H

