

1	
2	
3	
4	
5	
6	
7	
8	
9	
10	
11	

MIT3_4_9

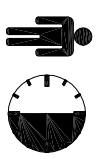

KOLEMIŃOŚĆ MONTAŻU
MIMOŚRODOW.
THE FITTINGS SEQUENCE OF THE
CAMS.
DIE MONTAGEABFOLGE VON
EXZENTERN.

(A)

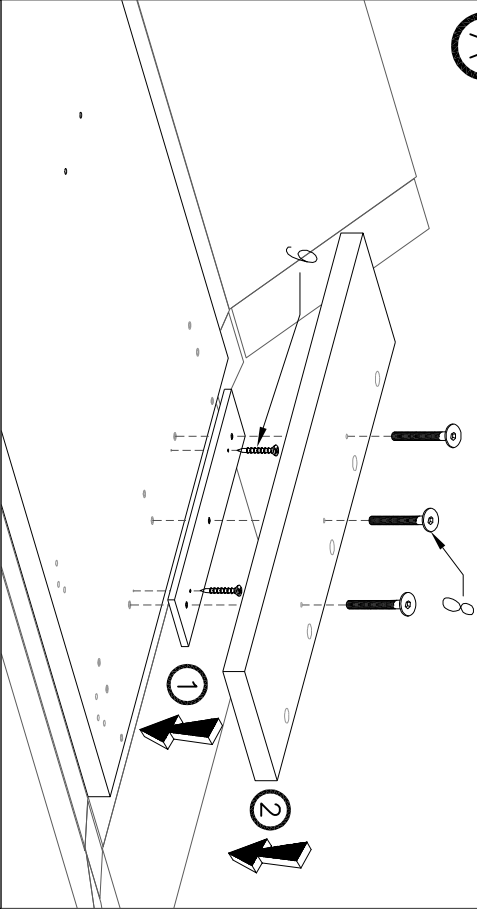

(C)

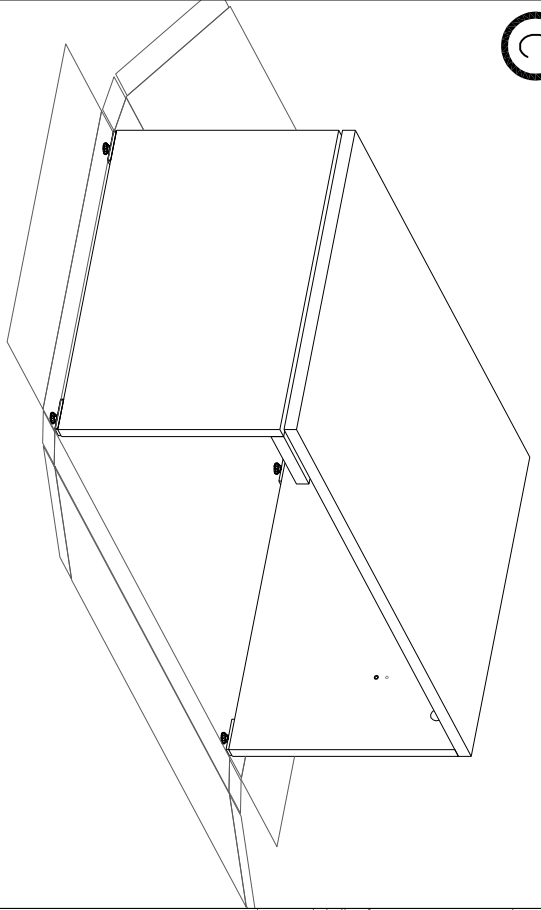

(B)

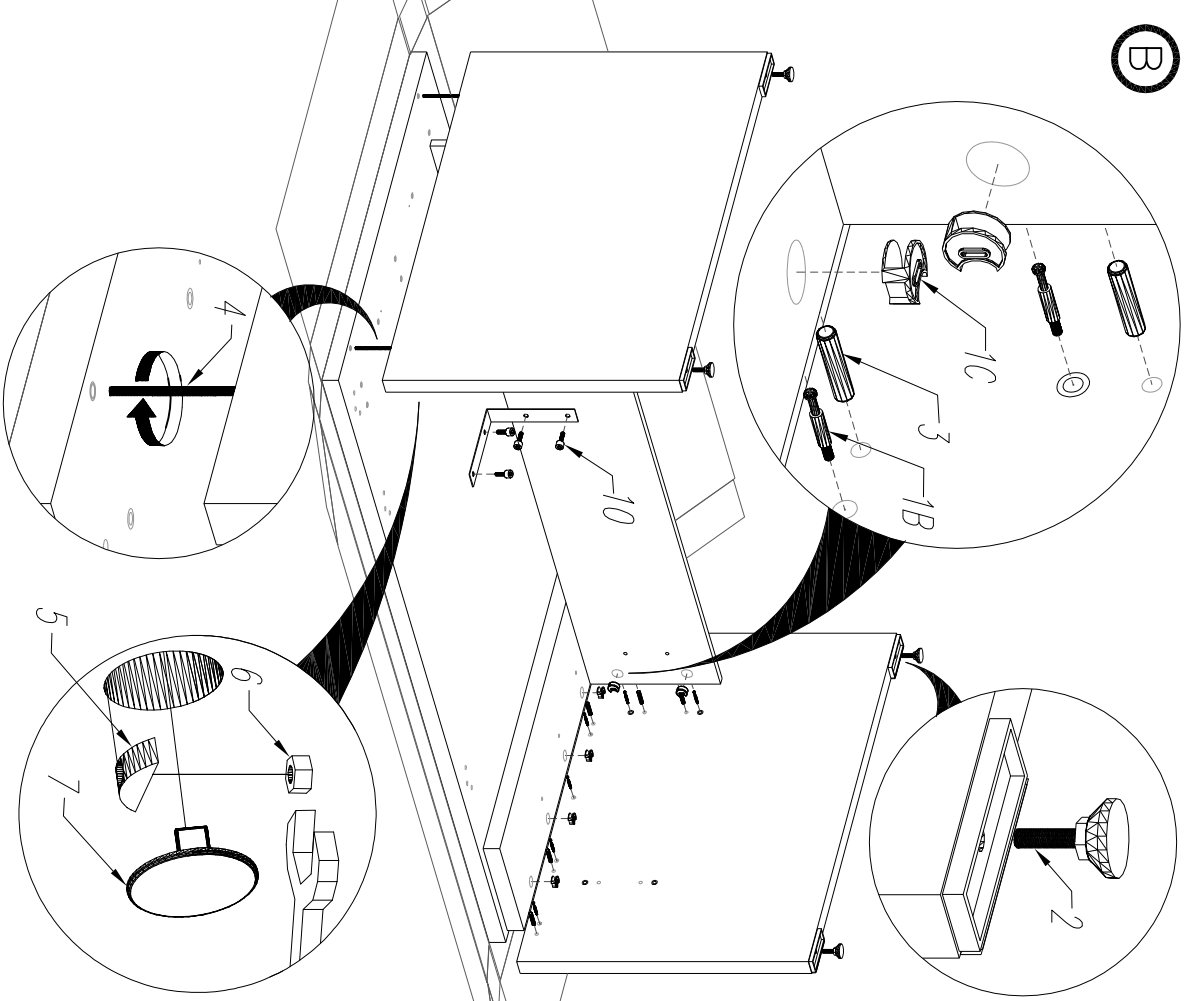

①

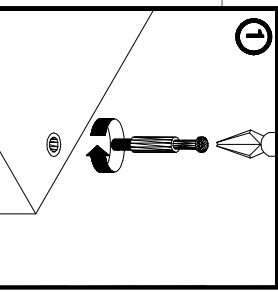

②

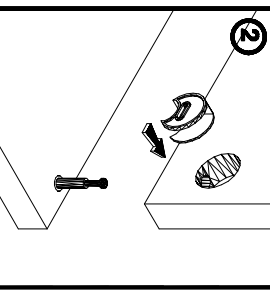

③

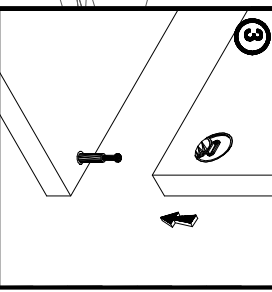

④

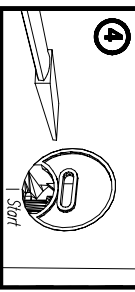

⑤

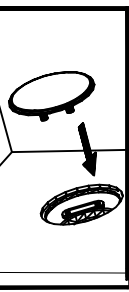
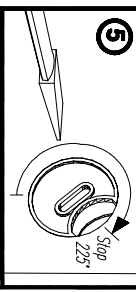

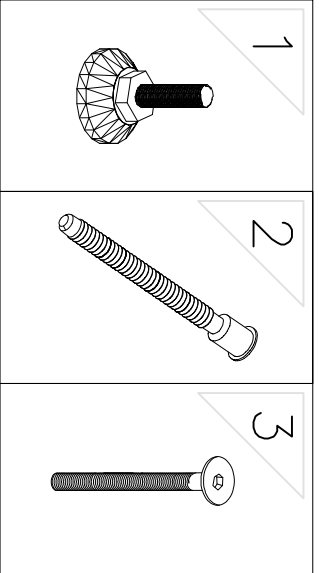

MIT1,2,3,4K

A

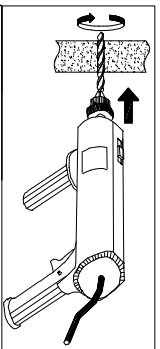
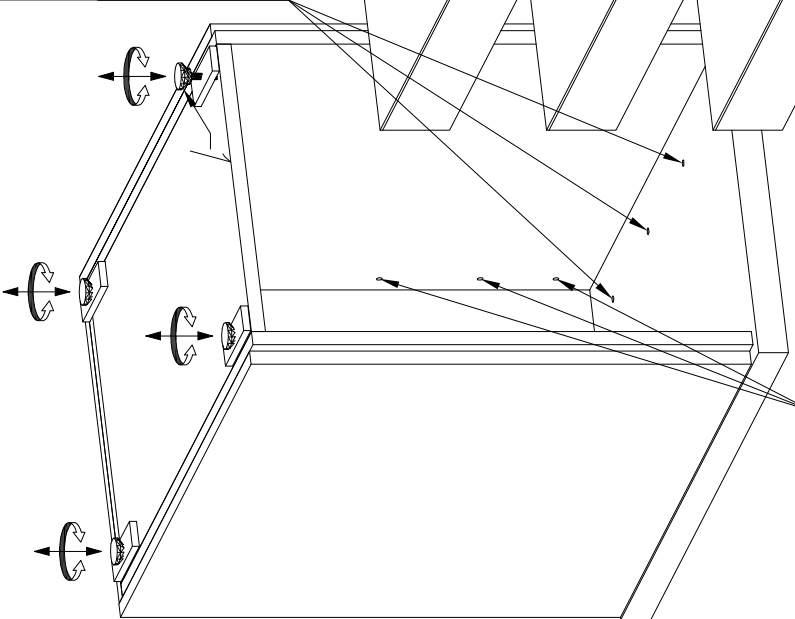
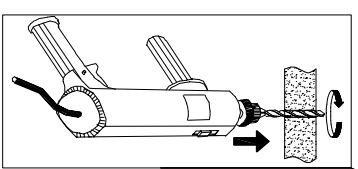

LEFT

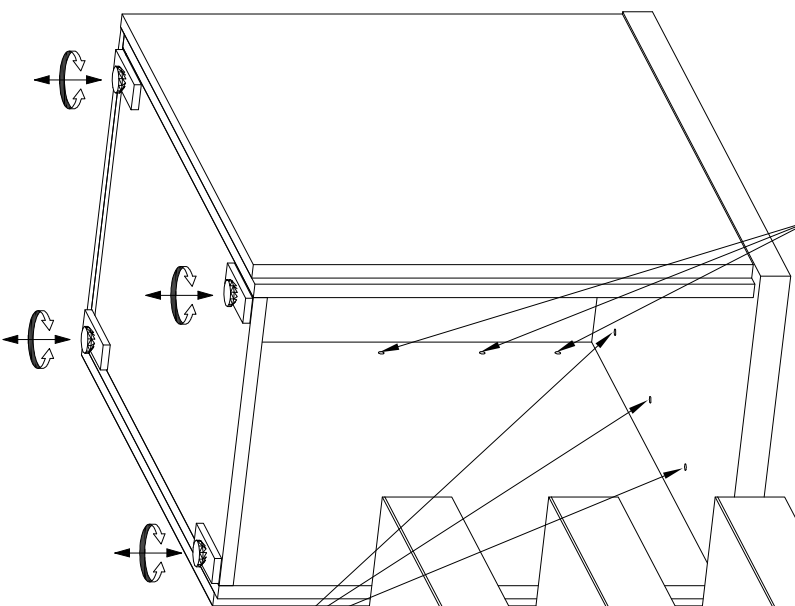
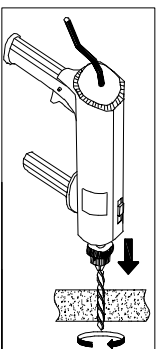
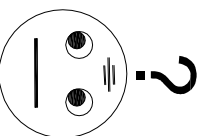

RIGHT

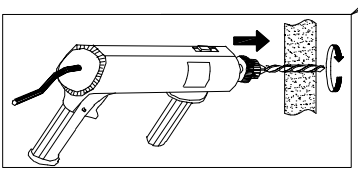

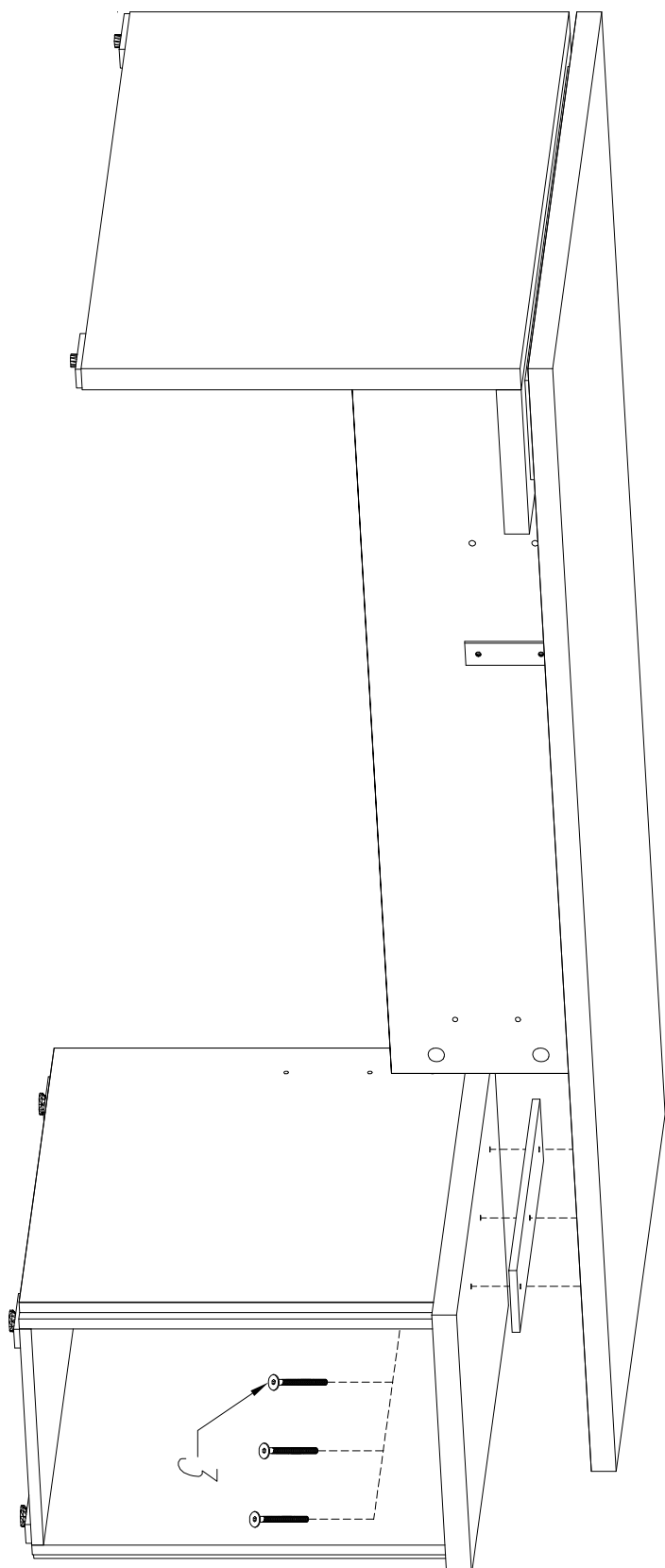
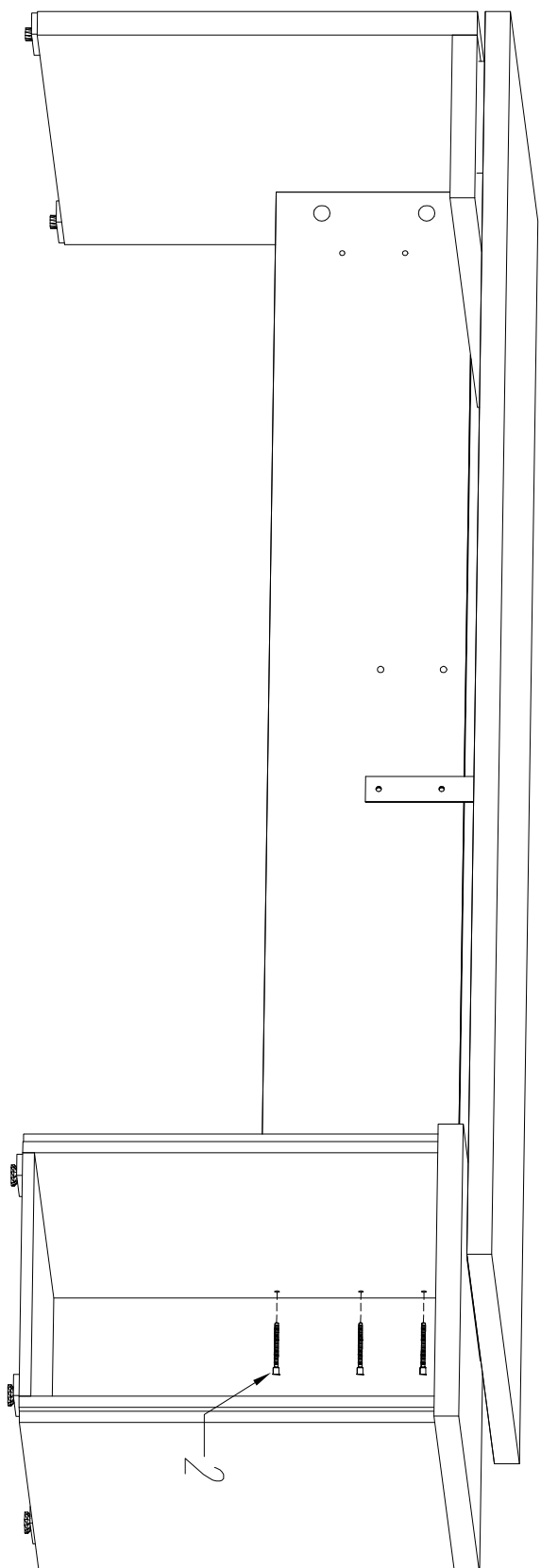

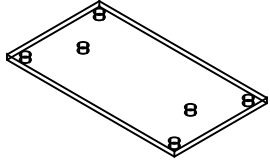

E40

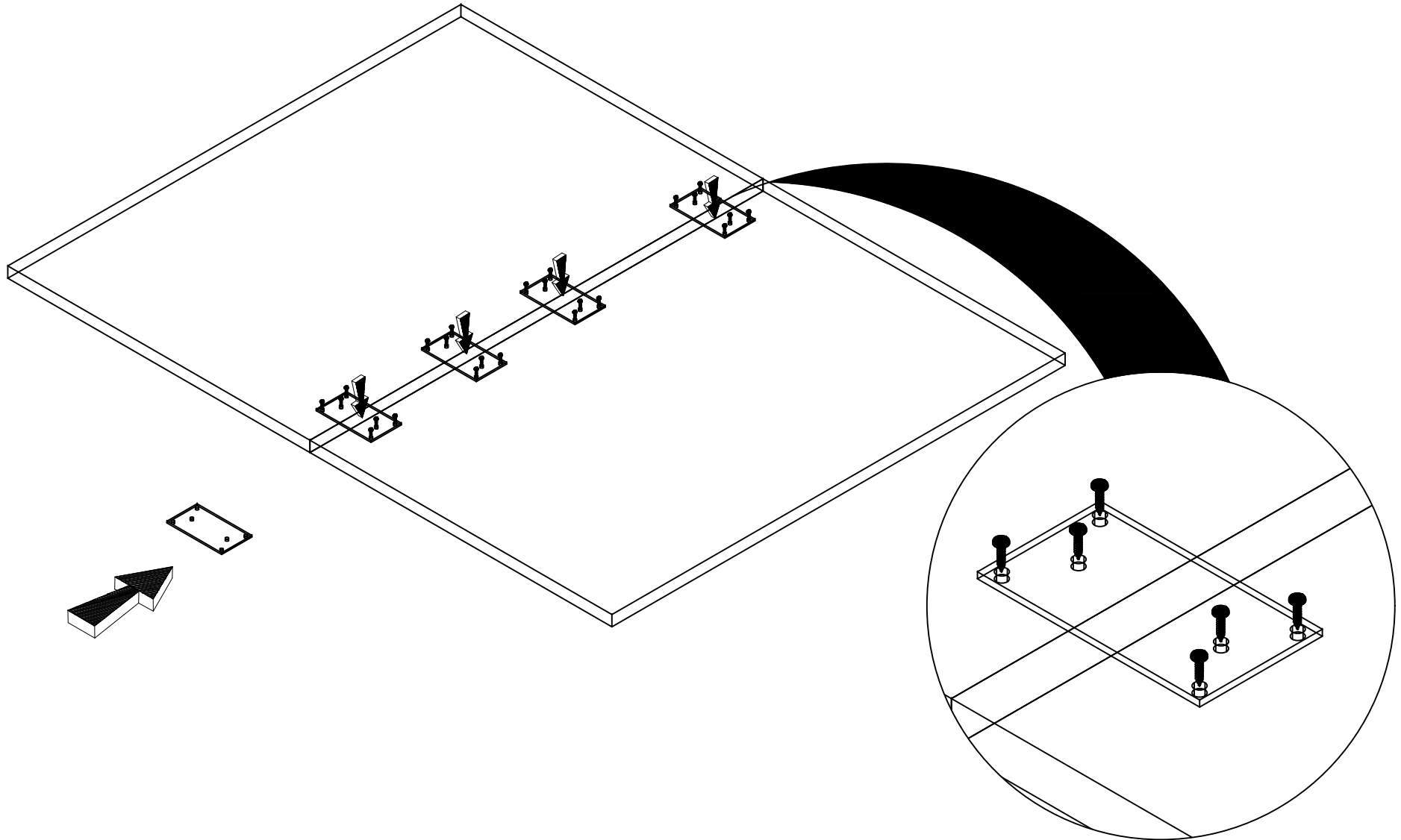

1



M05

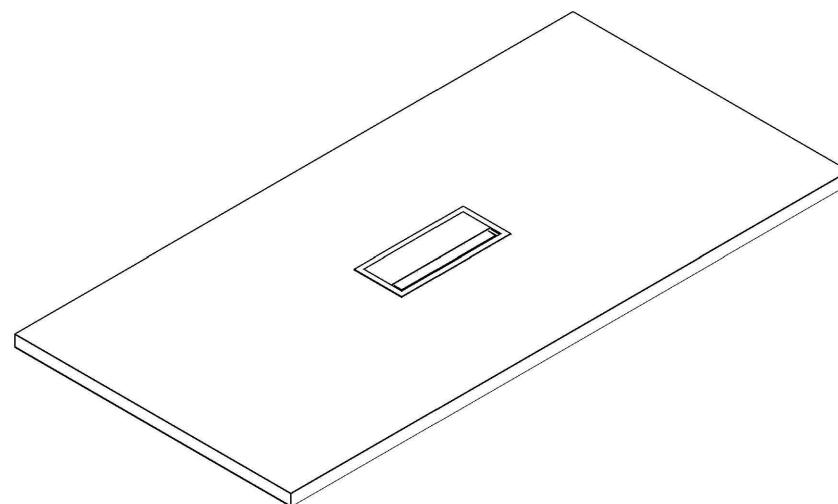
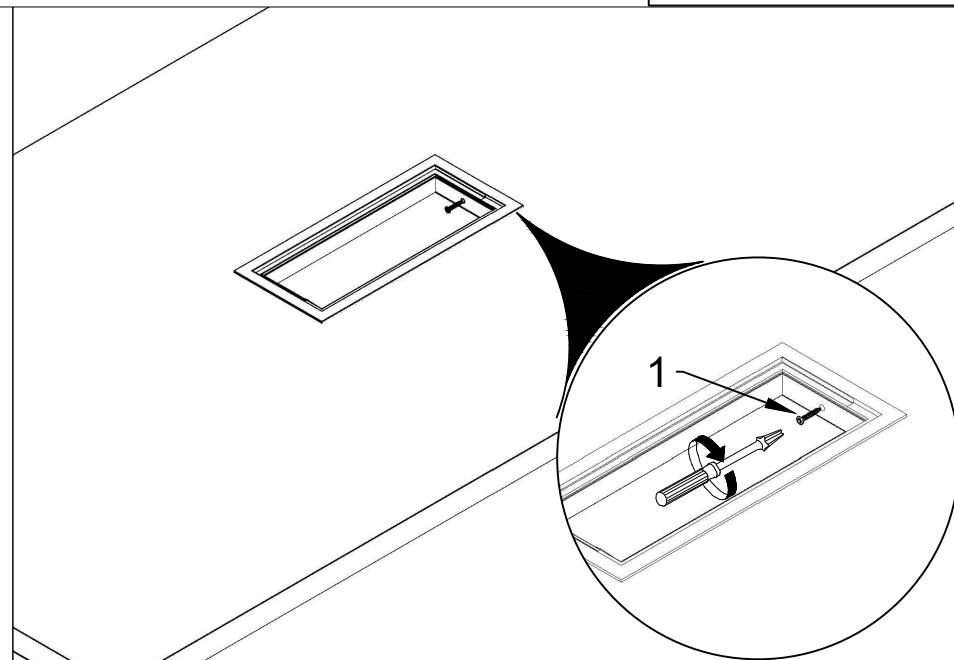
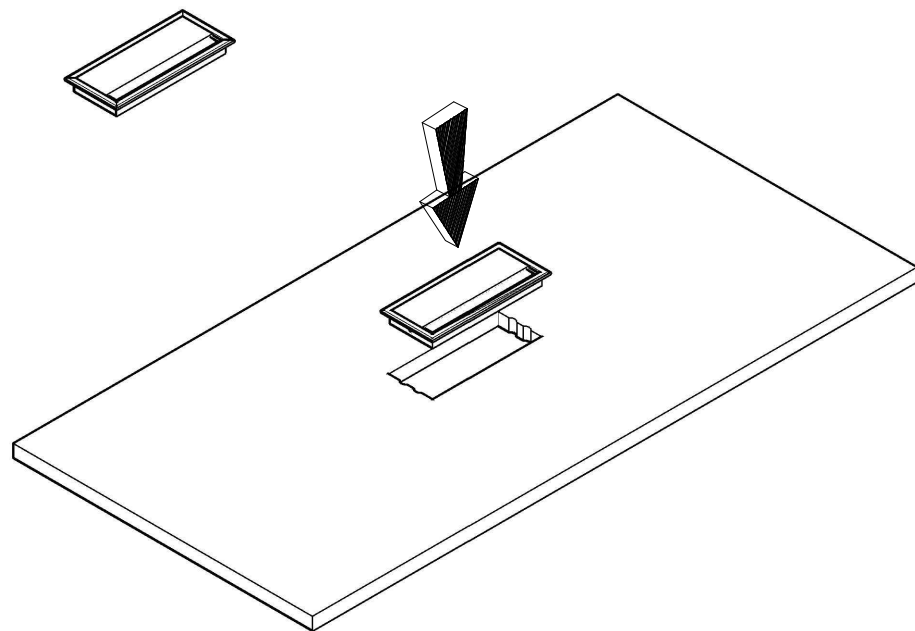

1

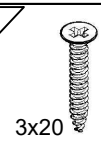

3x20

M04

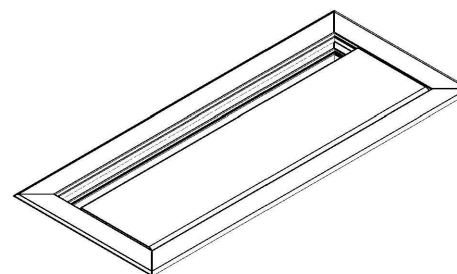
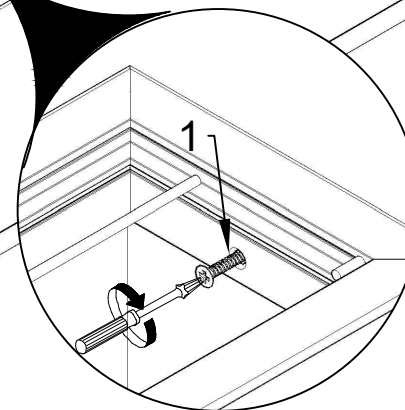
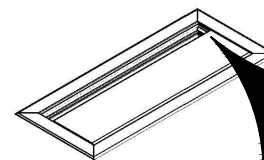
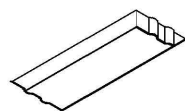
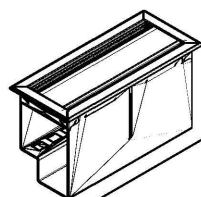
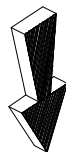

1



M04

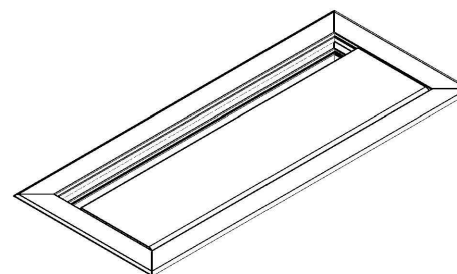
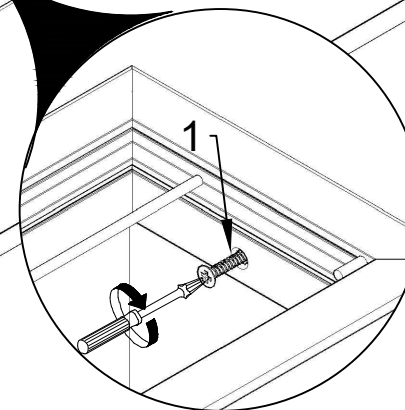
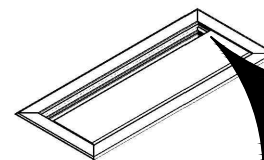
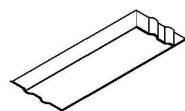
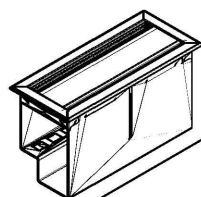
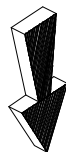

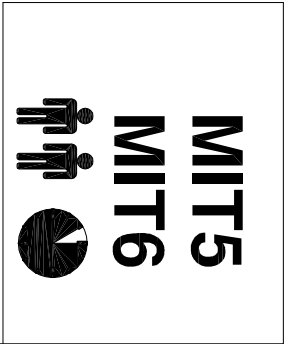

- | | |
|----|--|
| 1 | |
| 2 | |
| 3 | |
| 4 | |
| 5 | |
| 6 | |
| 7 | |
| 8 | |
| 9 | |
| 10 | |

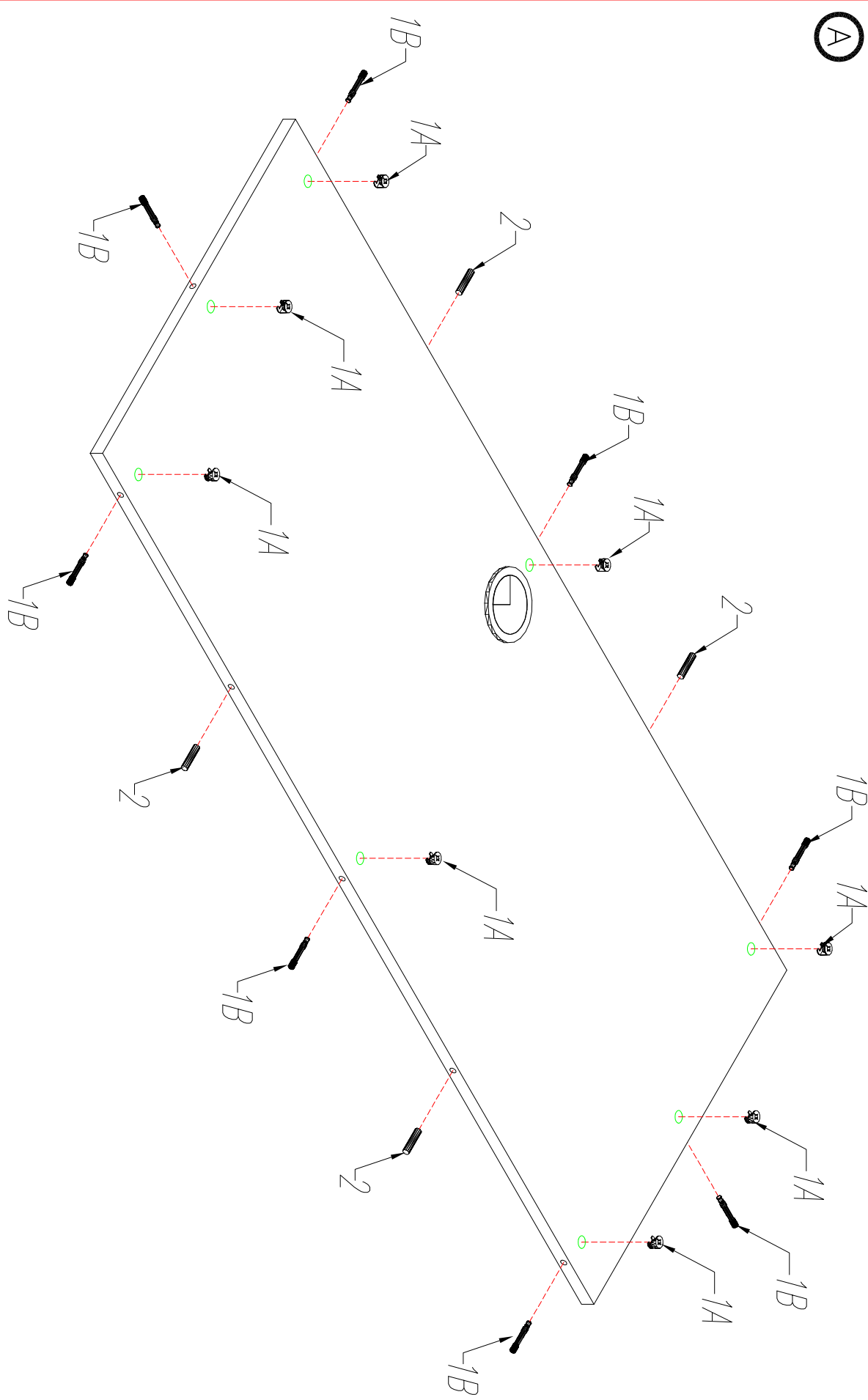

KOLEJNOŚĆ MONTAŻU
MIMOŚRODKÓW I KOLKÓW.
THE FITTINGS SEQUENCE OF THE
CAMS AND DOWELS.
DIE MONTAGEFOLGE VON
EXZENTERN UND DUEBELN.

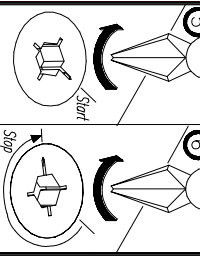
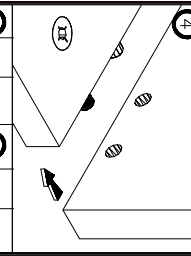
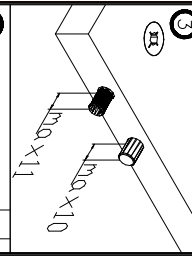
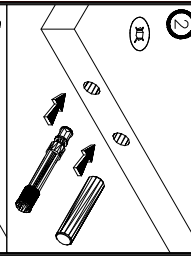
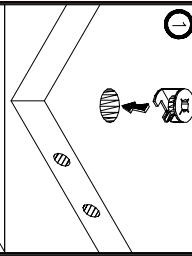

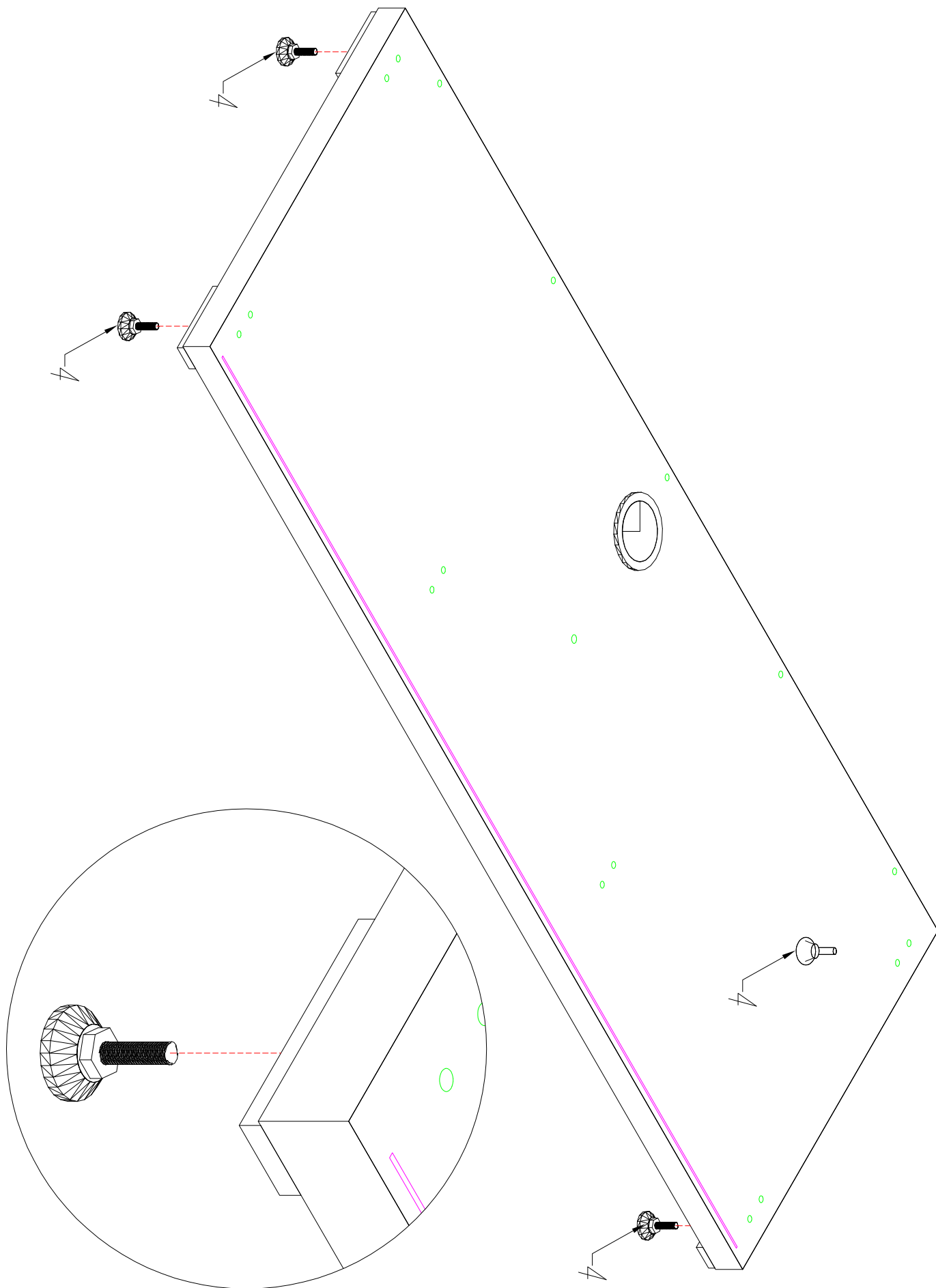

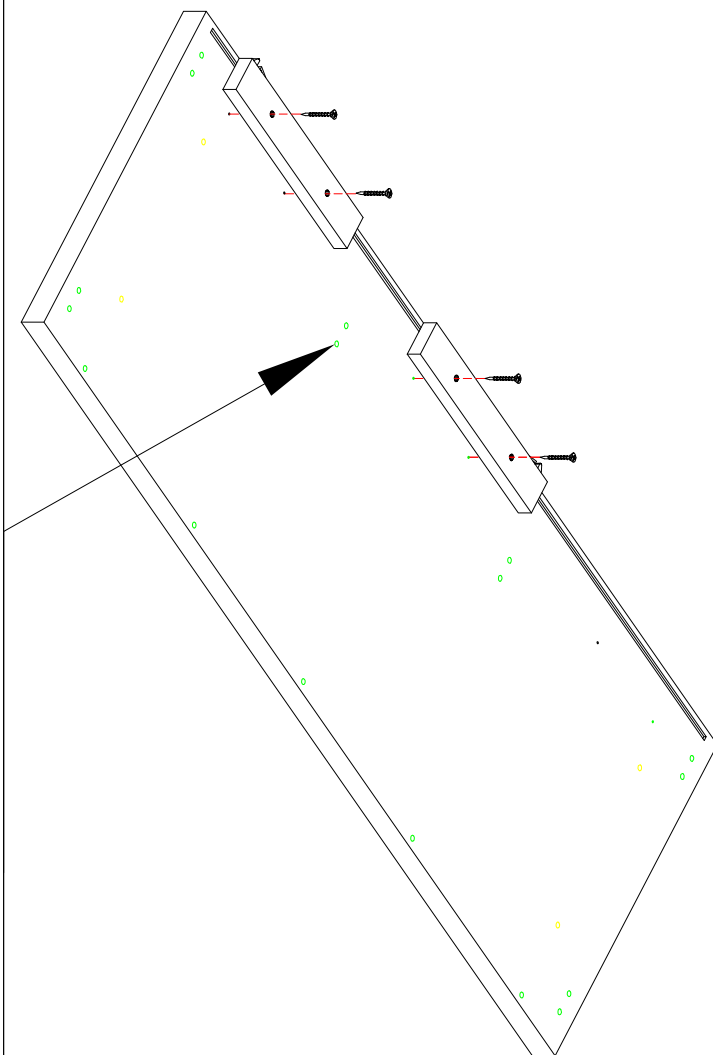
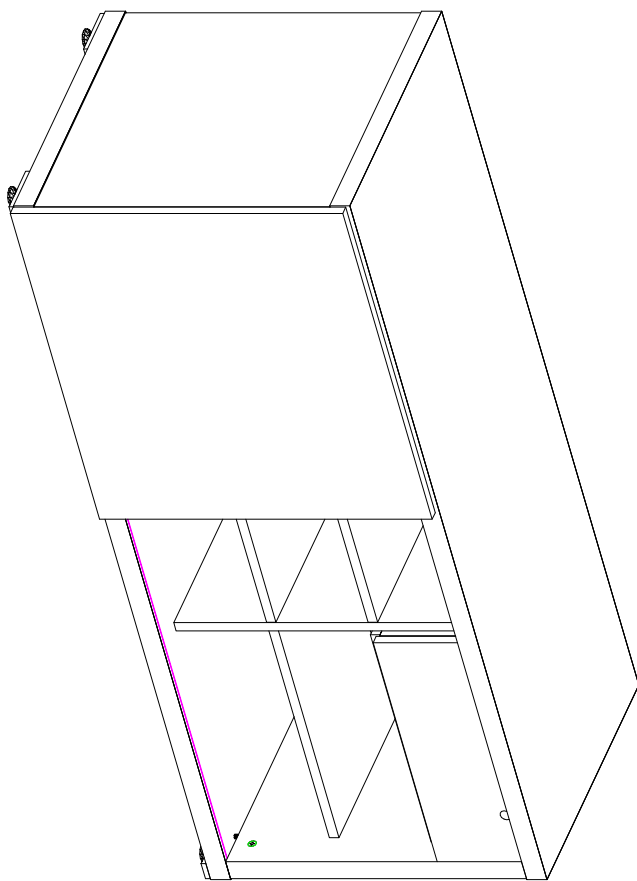
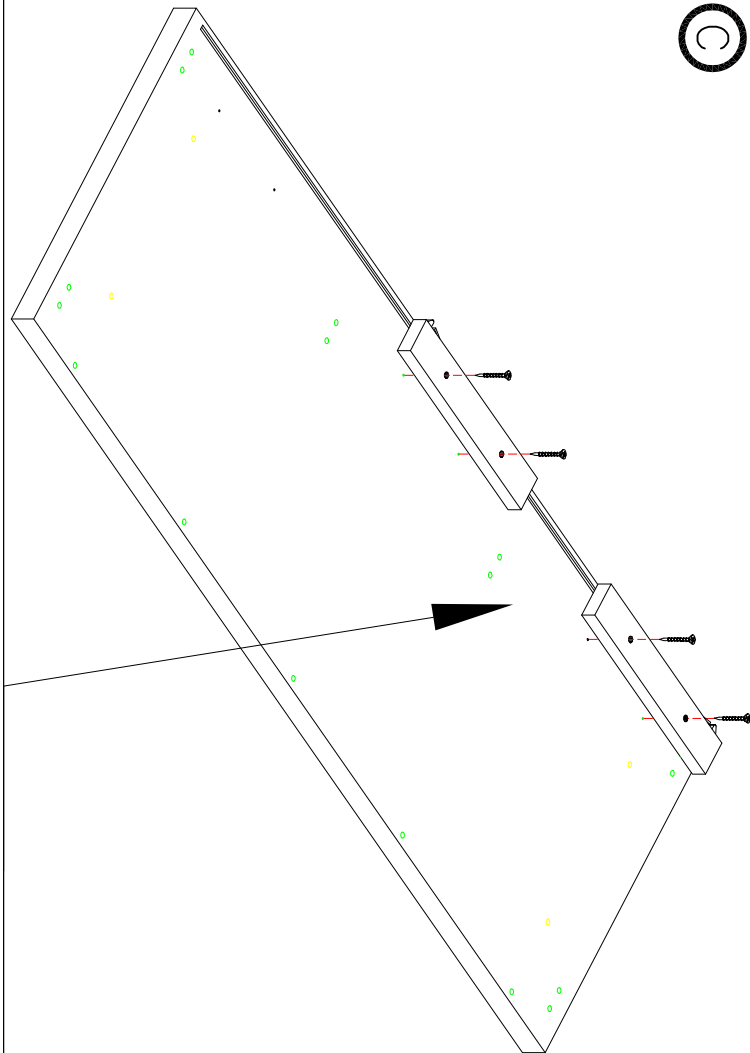
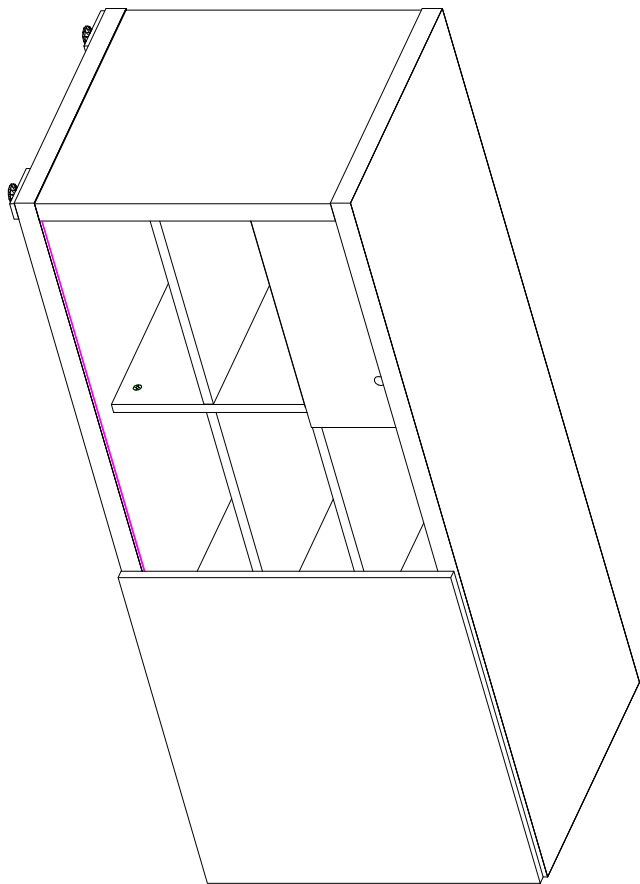

D

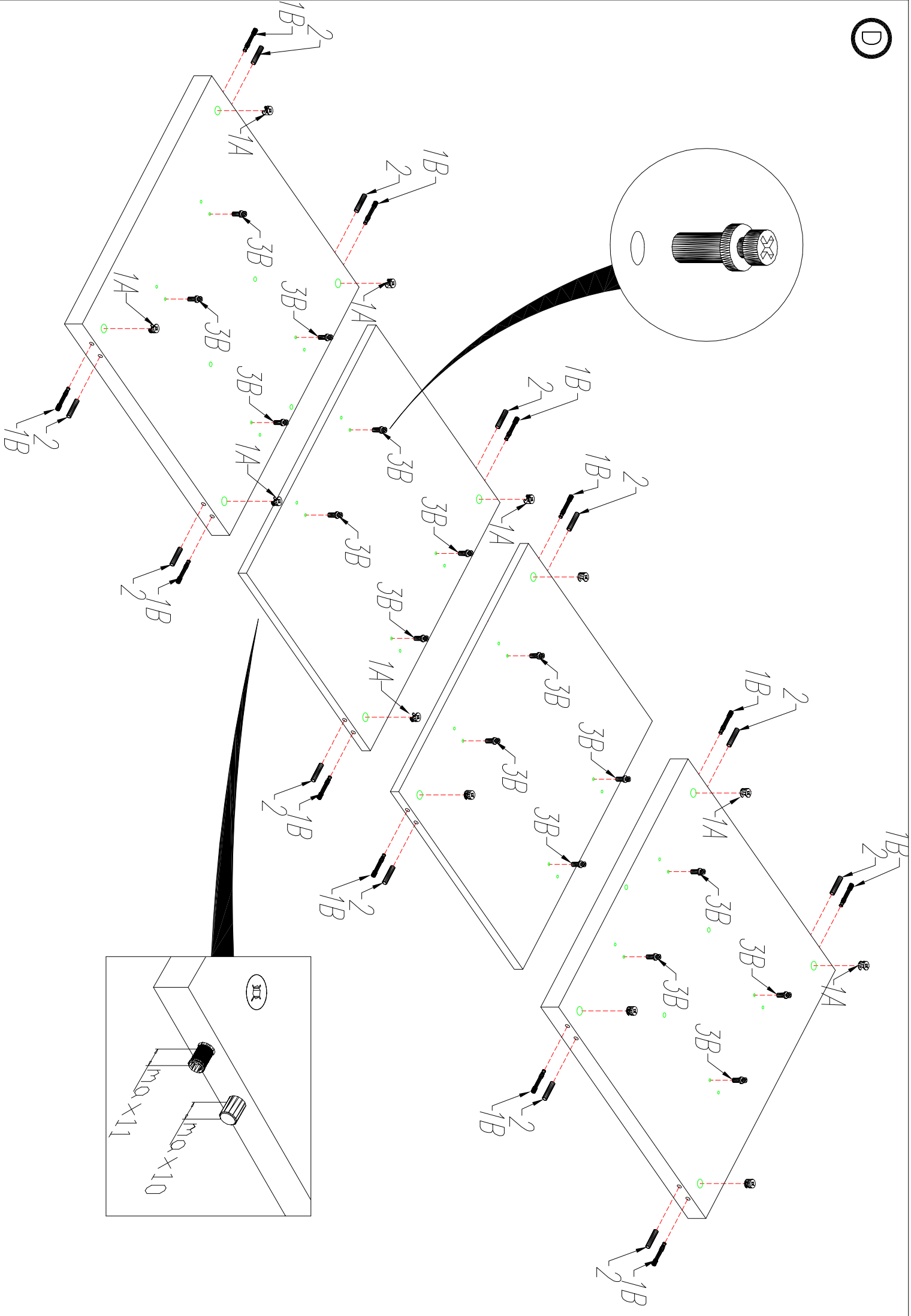

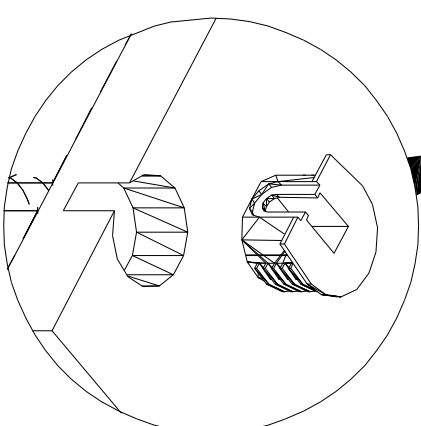
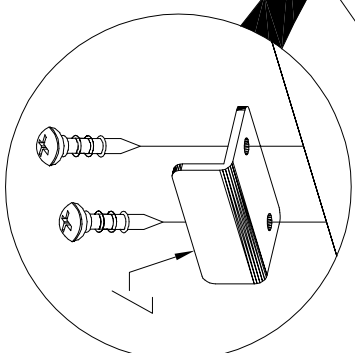
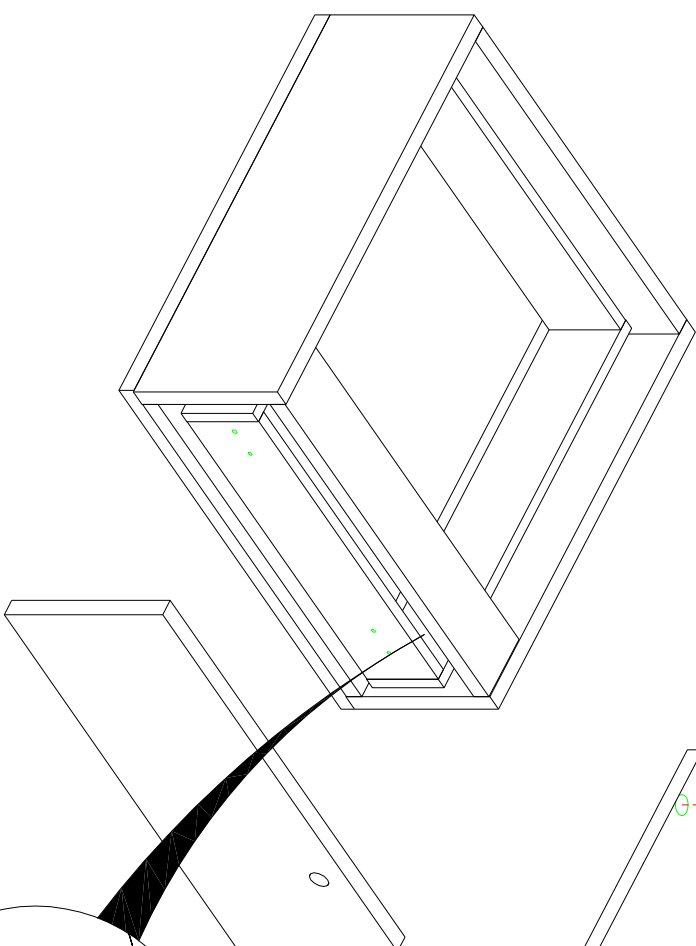
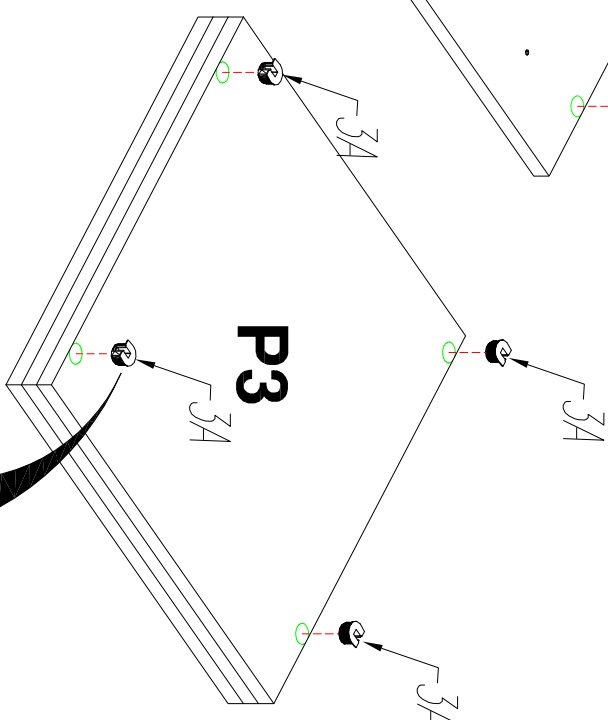
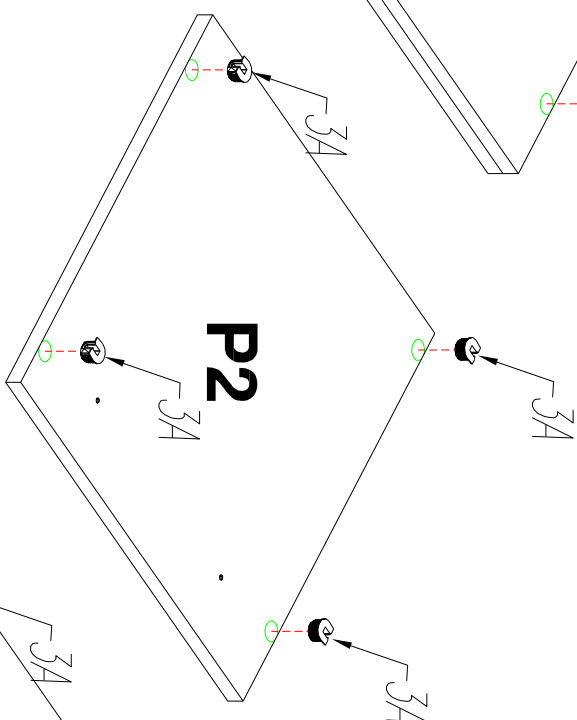
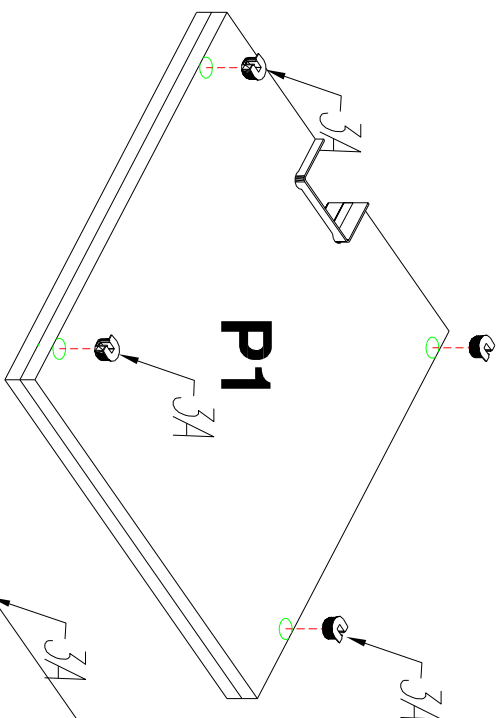

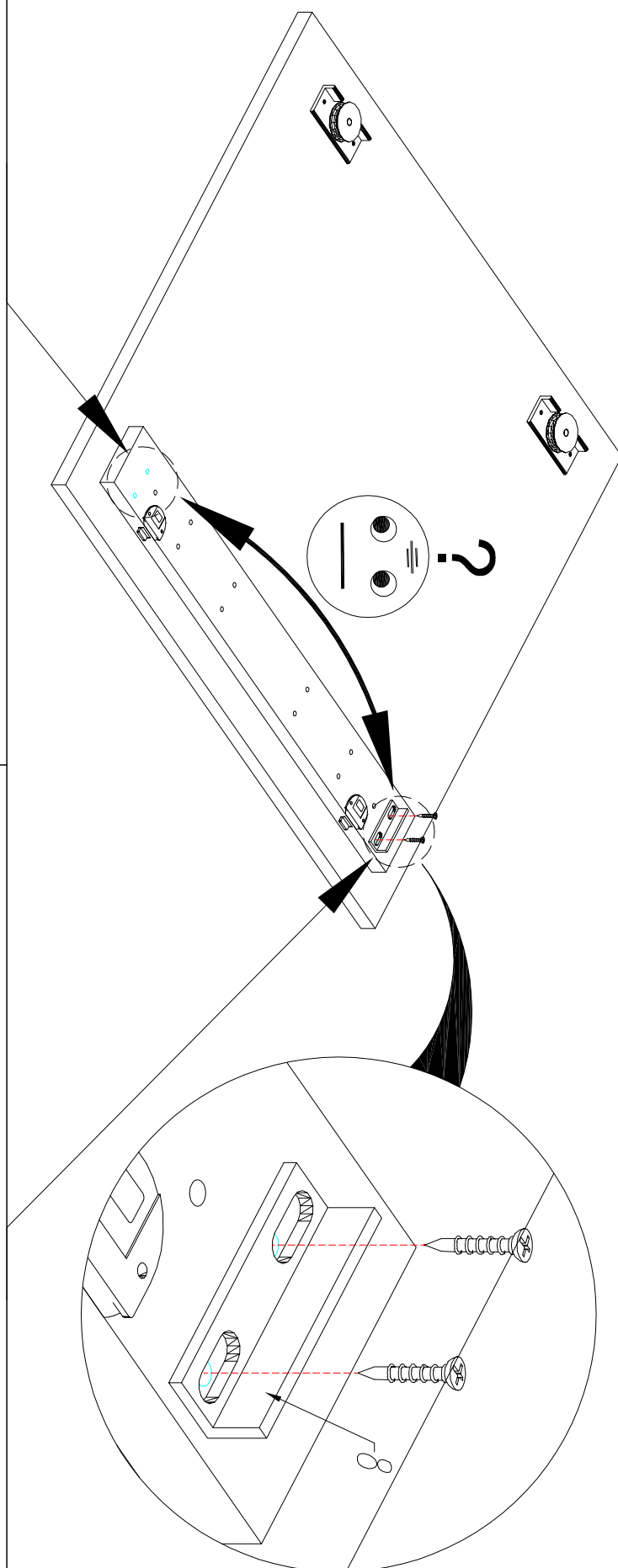
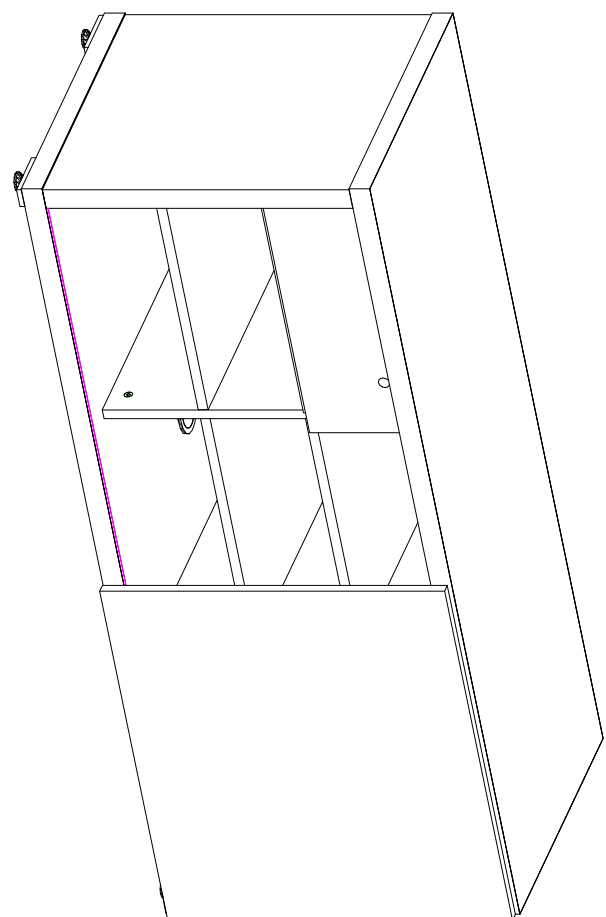
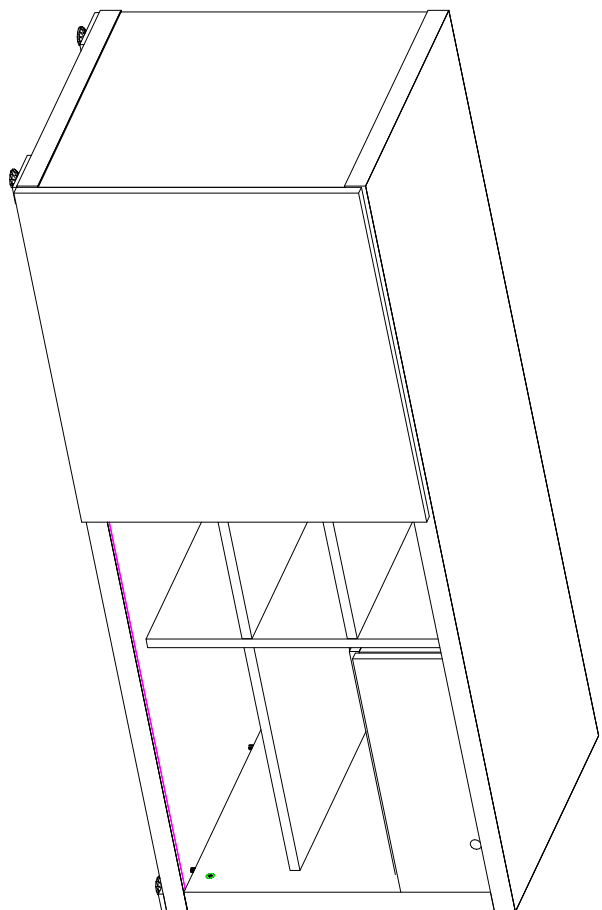

1

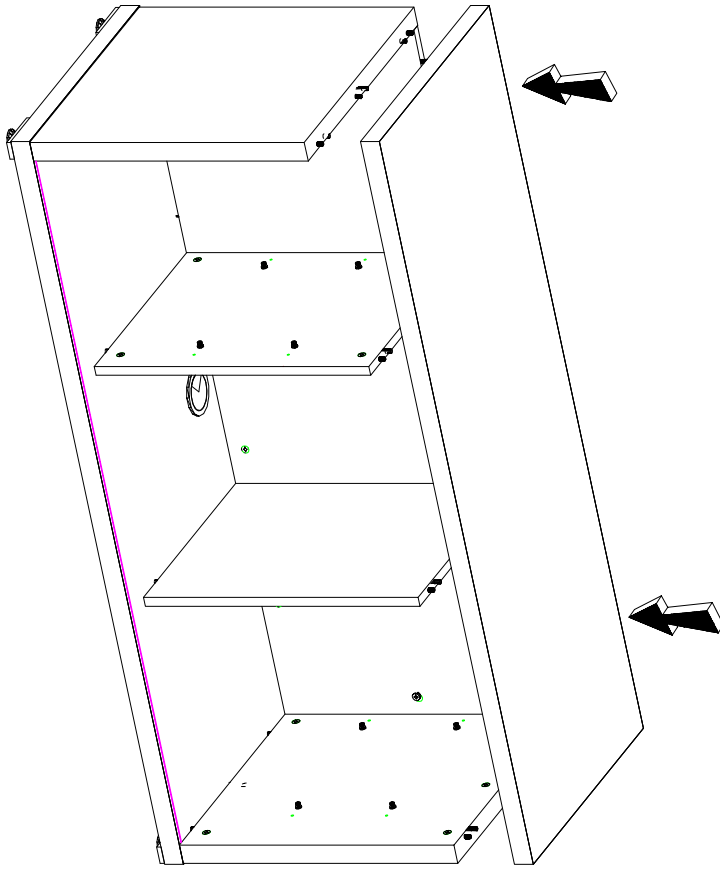

2

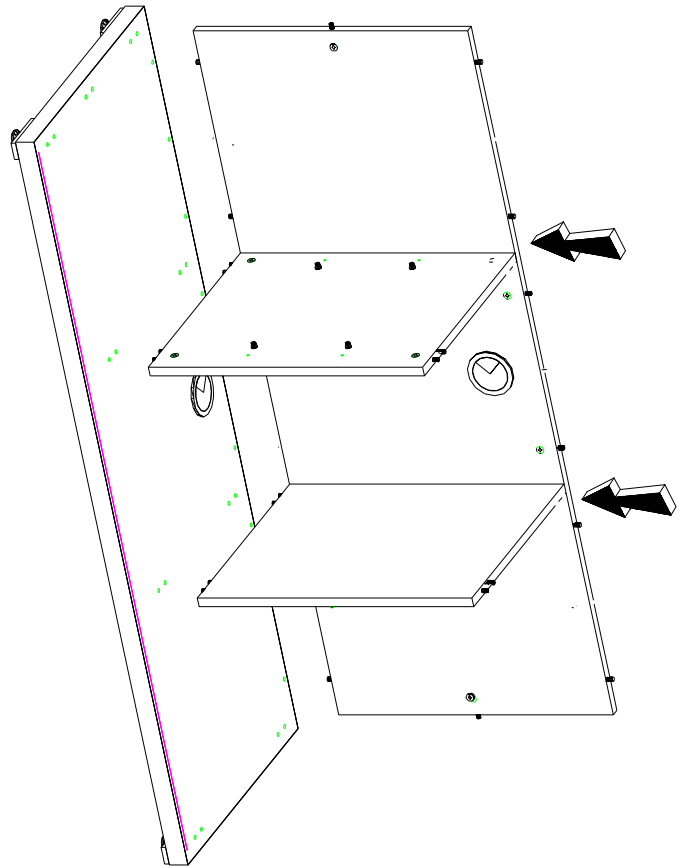

3

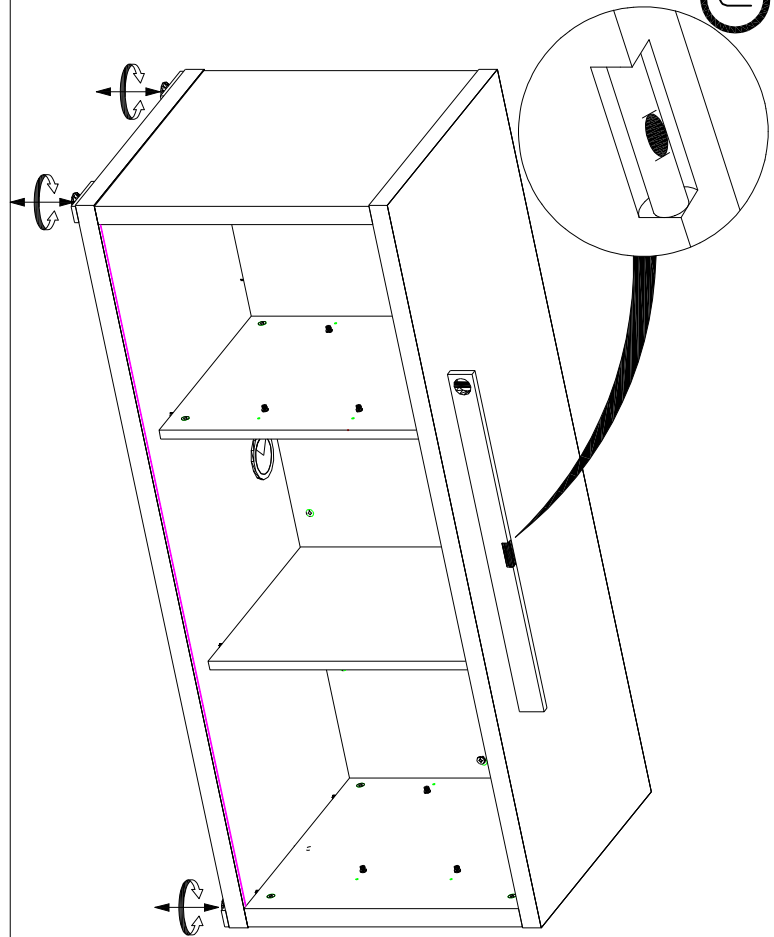

4

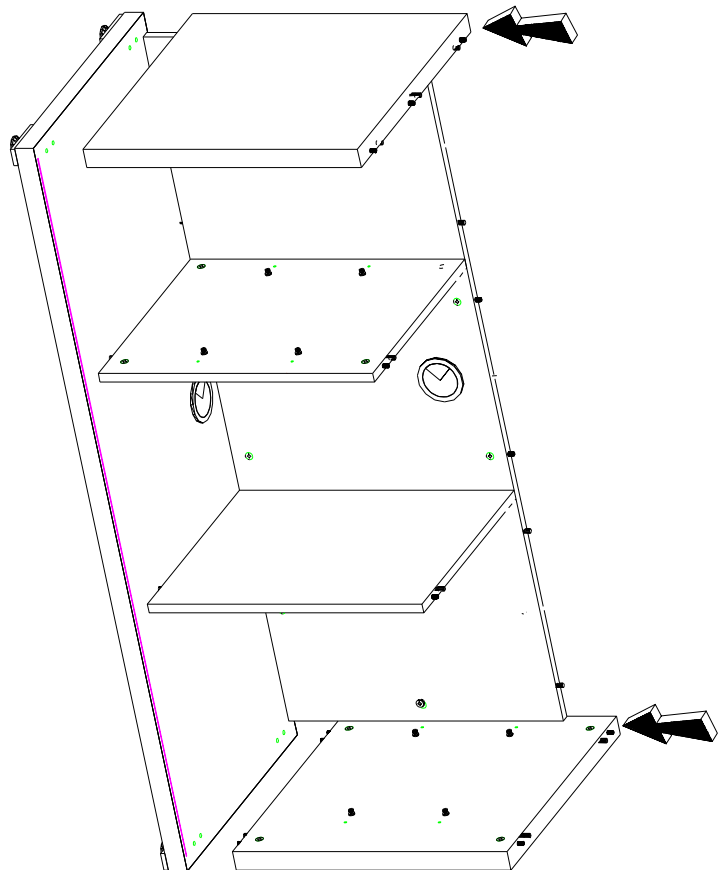

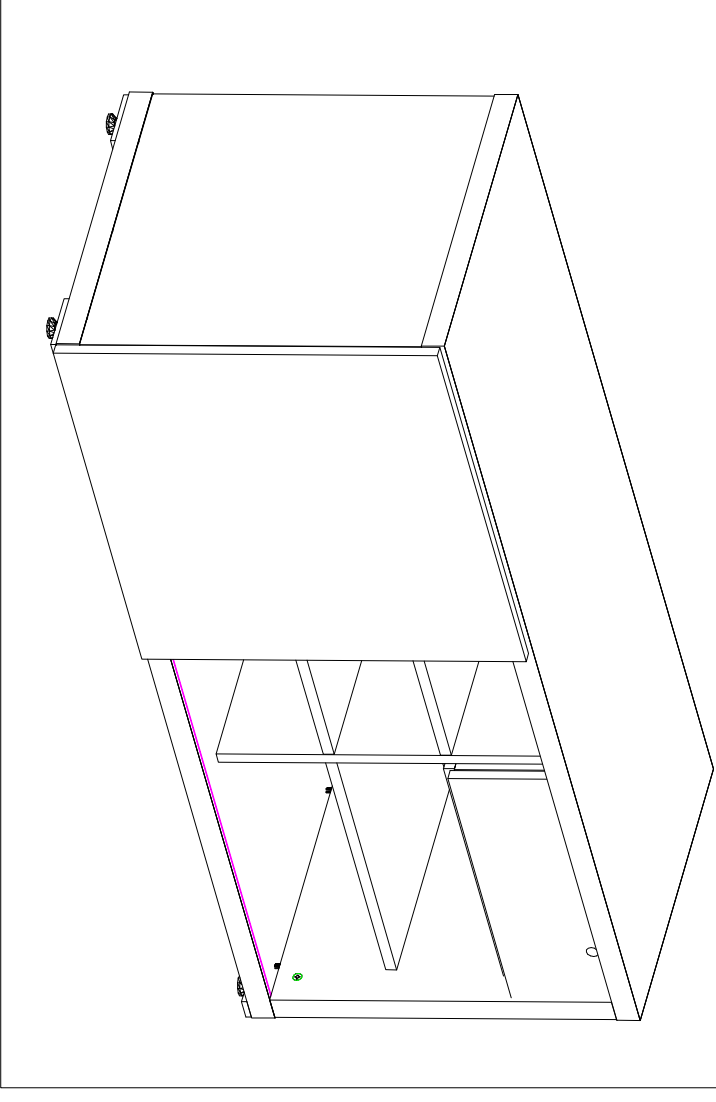
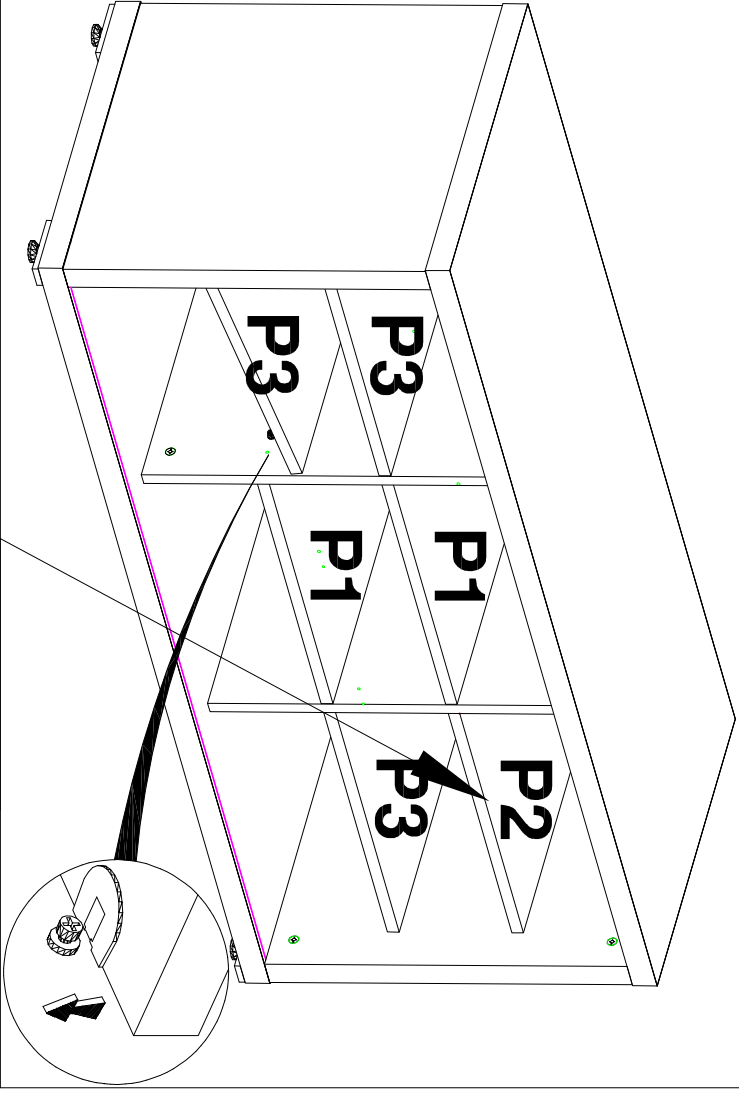
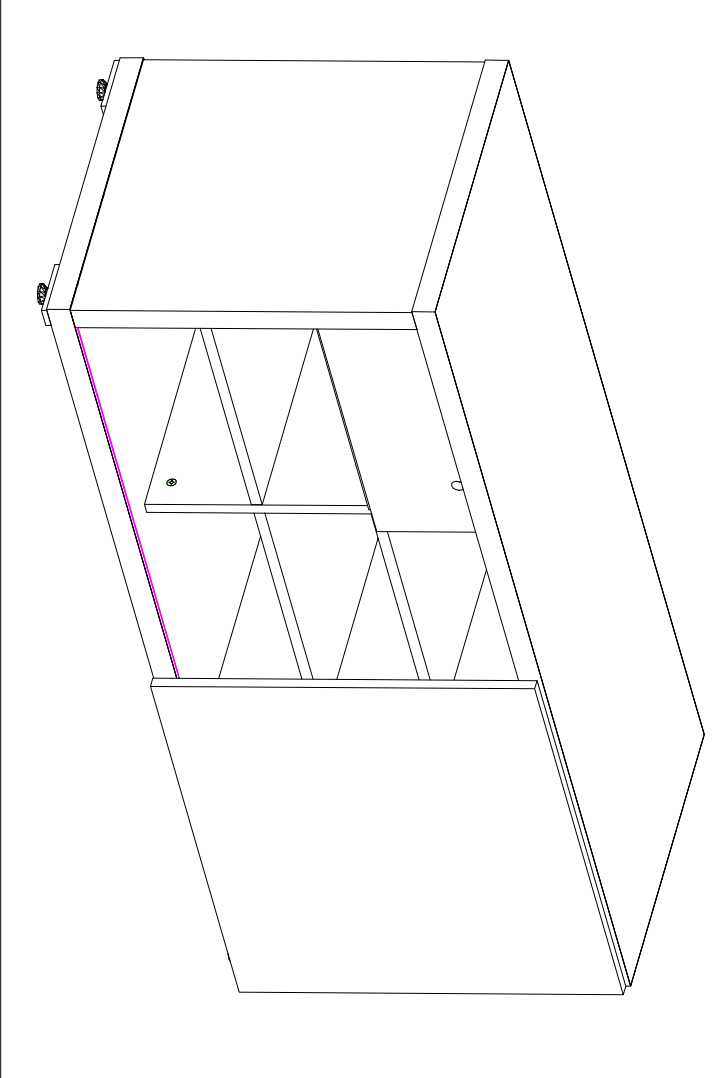
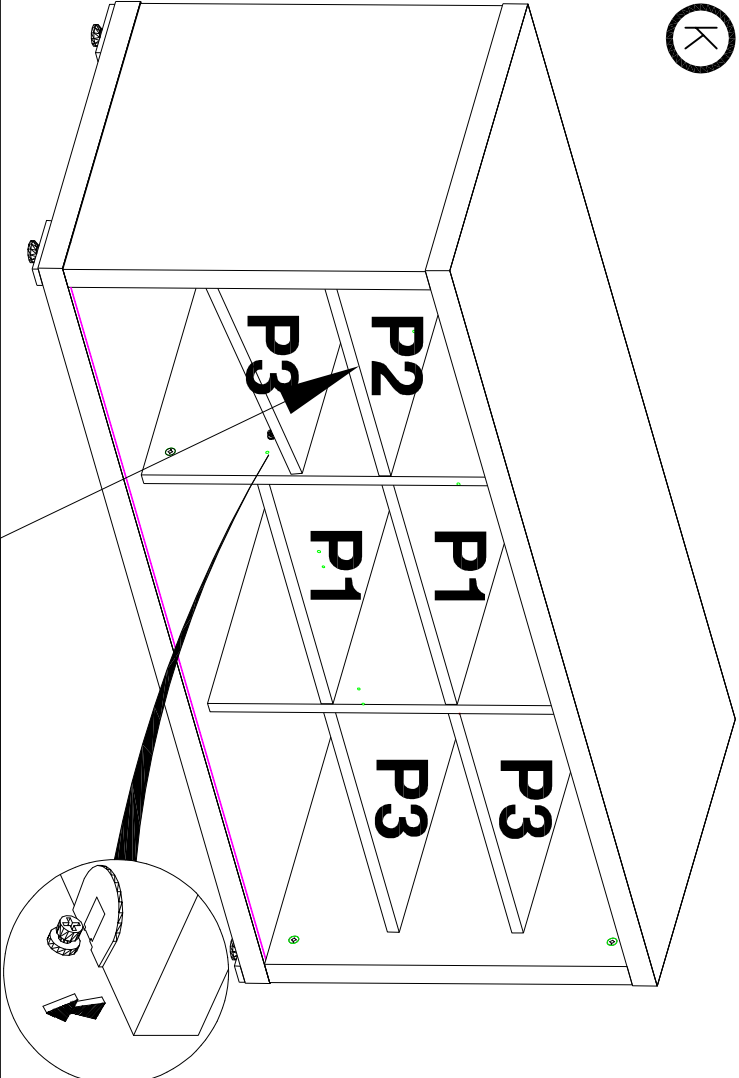

L

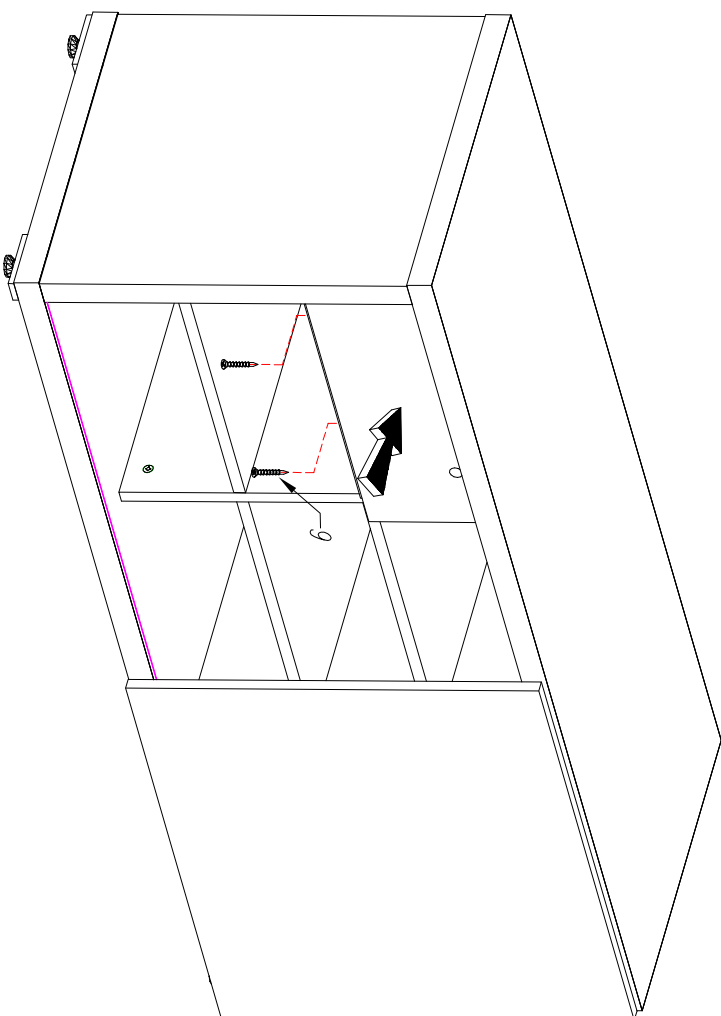

-Przykręcić śruby z
małą siłą.
-Put the screws gently.
-Anschrauben die
Schrauben zierlich.

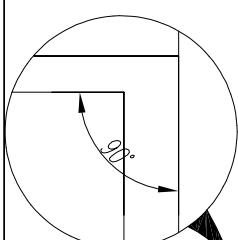
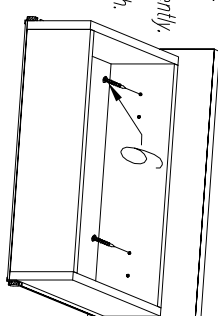

-Przykręcić śruby z
dużą siłą.
-Put the screws strongly.
-Anschrauben die
Schrauben stierlich.

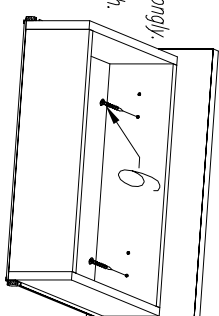

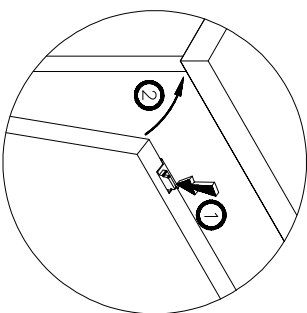
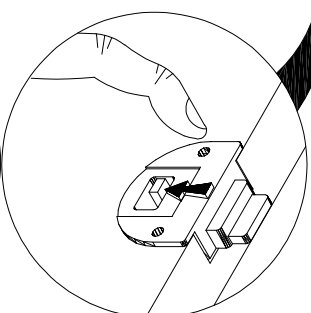
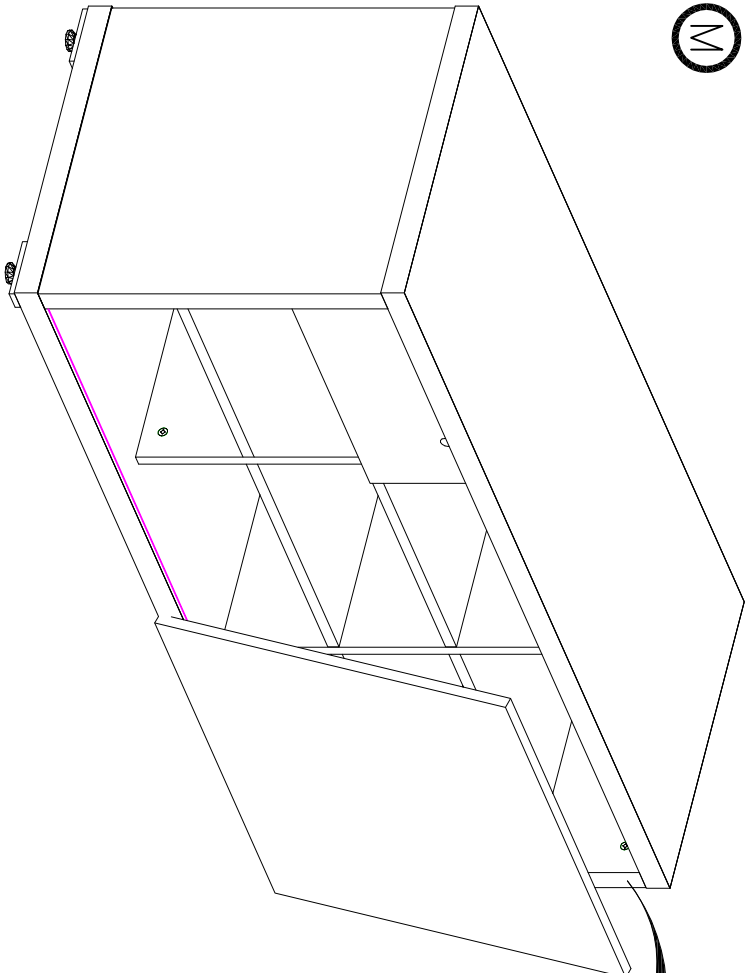

M

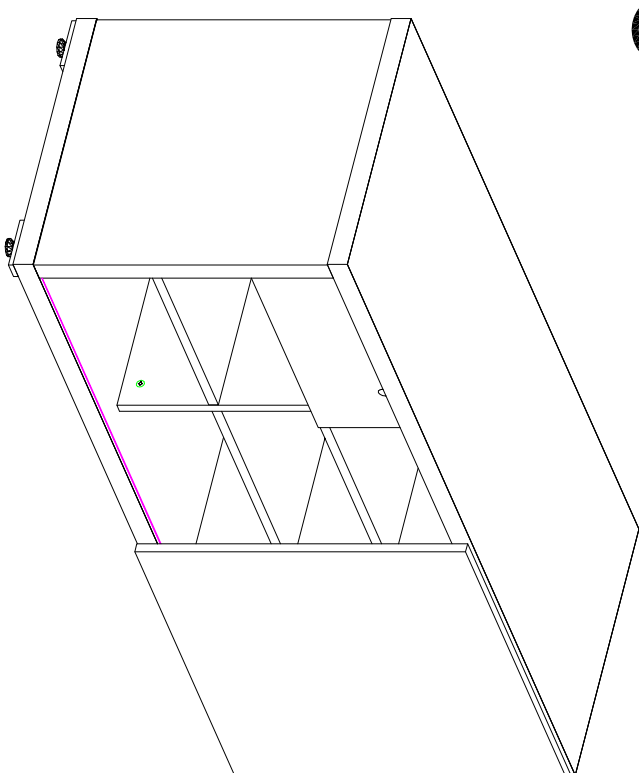

N

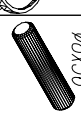
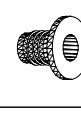
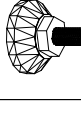
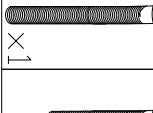
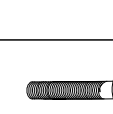
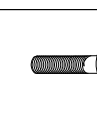
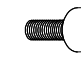

1		1/4
2		ø8x36
3		x3
4		x2
5		M6x100
6		M6x60
7		M6x50
8		M6x30
9		M6x14

KOLEJNOŚĆ MONTAŻU
MONTASZRODOK.
THE FITTINGS SEQUENCE OF THE
CAM.
DIE MONTAGEABFOLGE VON
EXZENTERN.

(A)

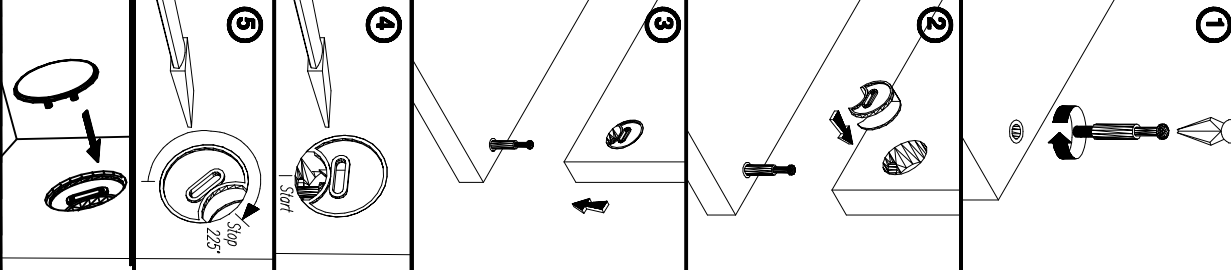
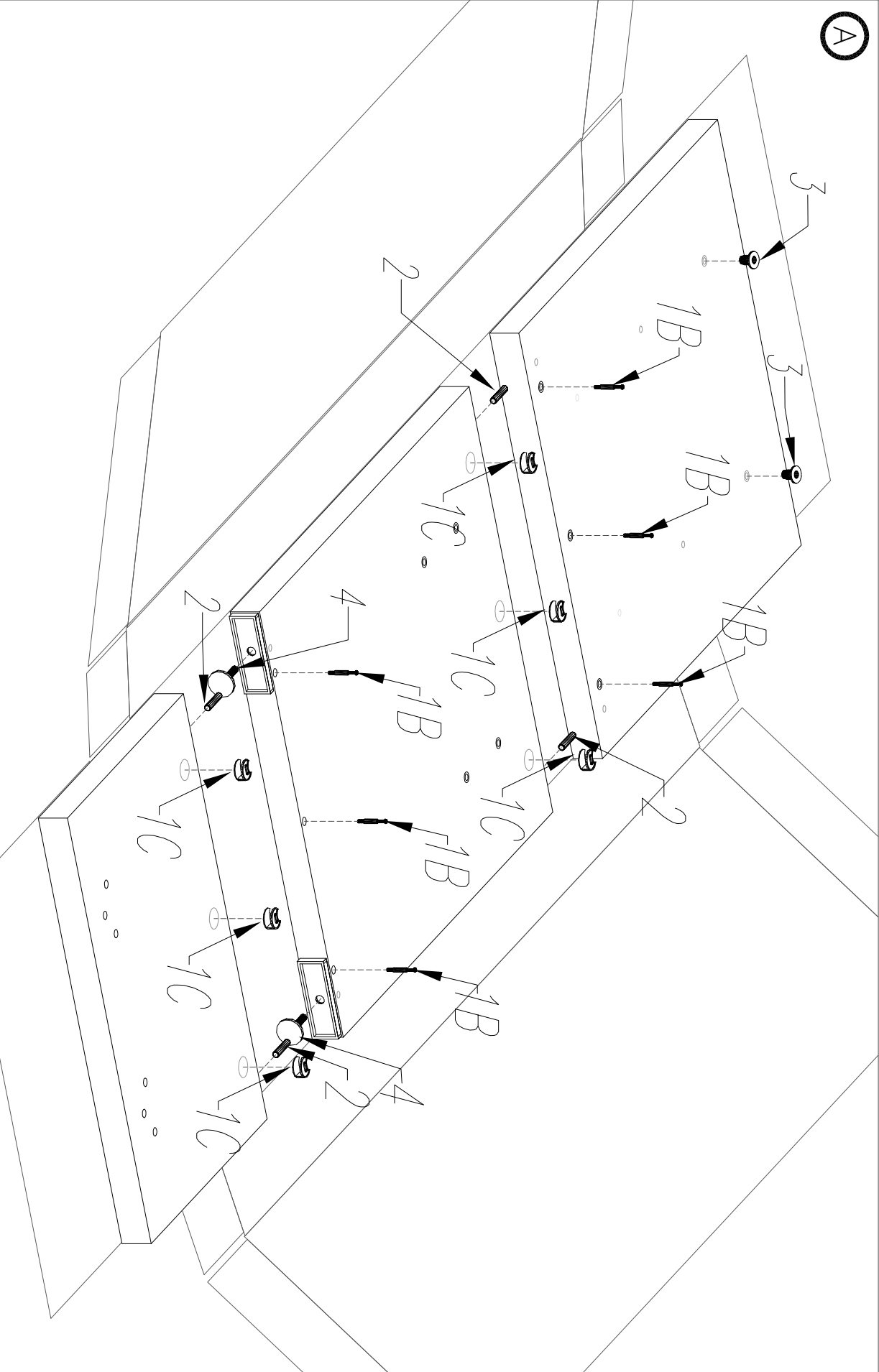

B

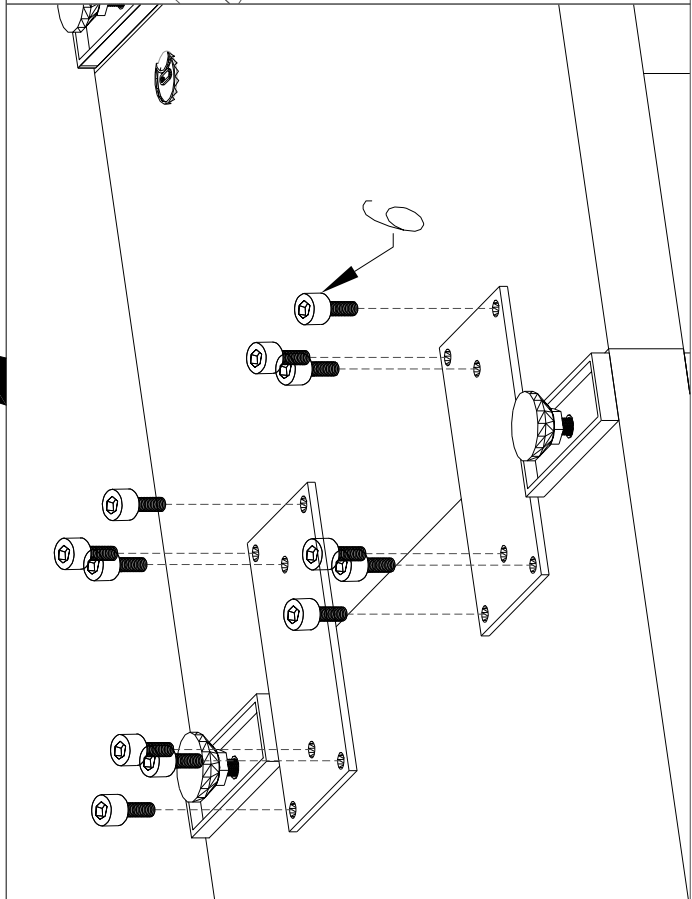
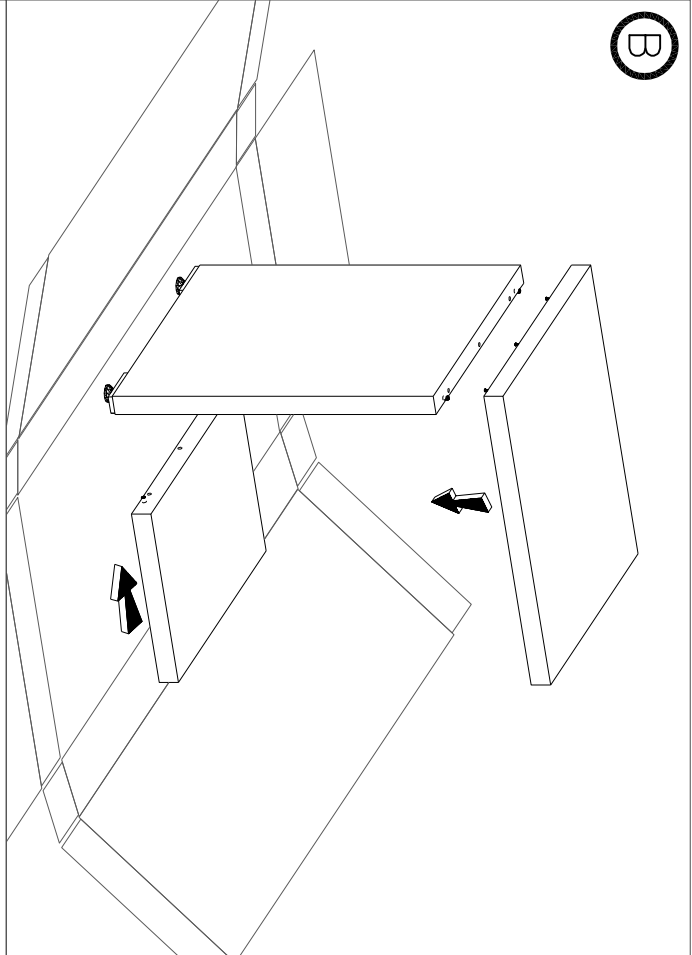

MIT5

C

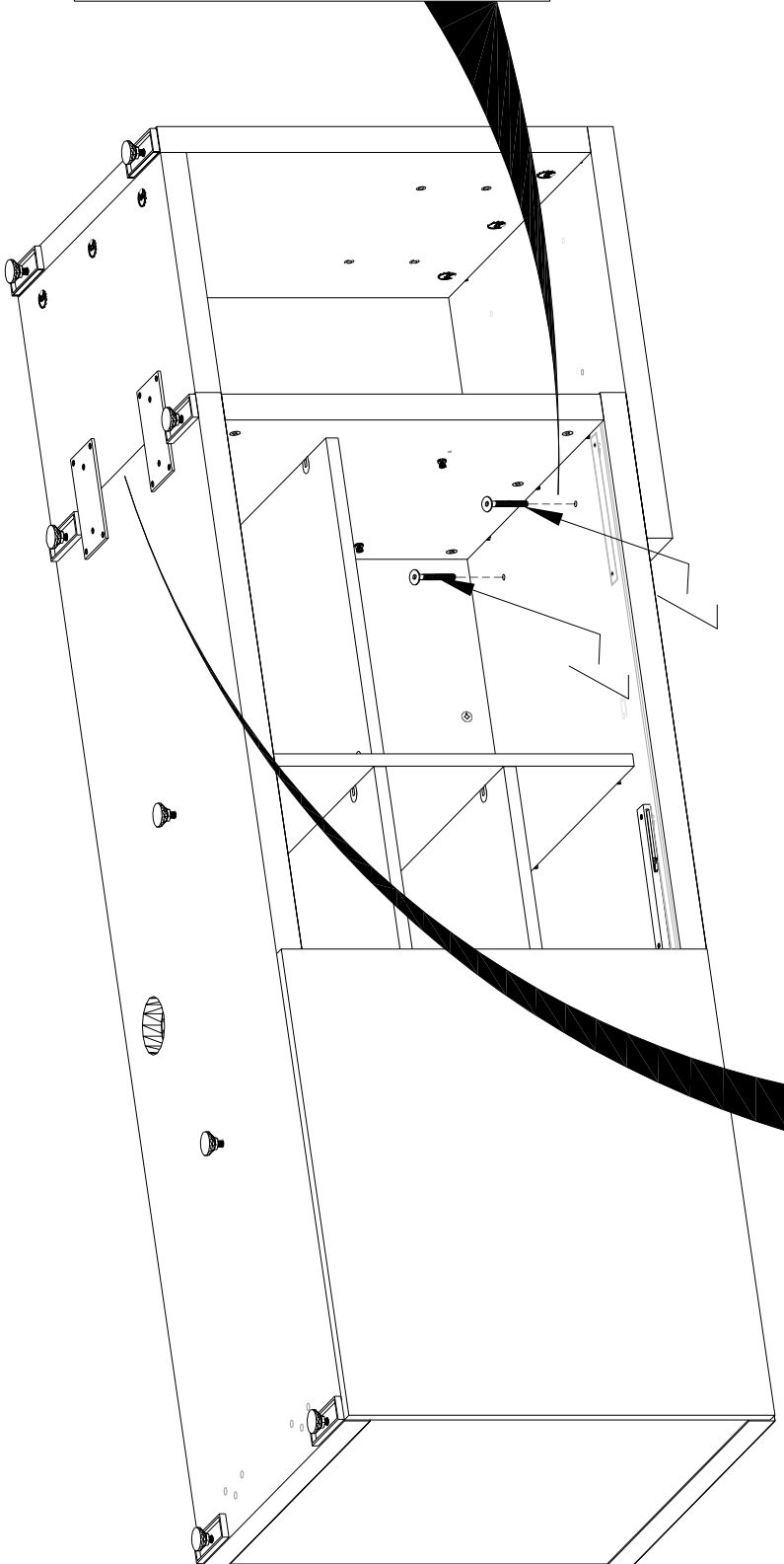
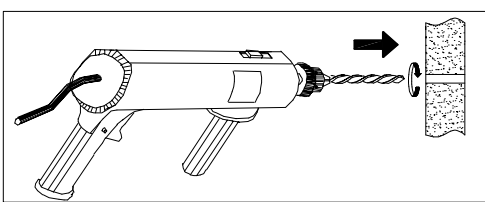

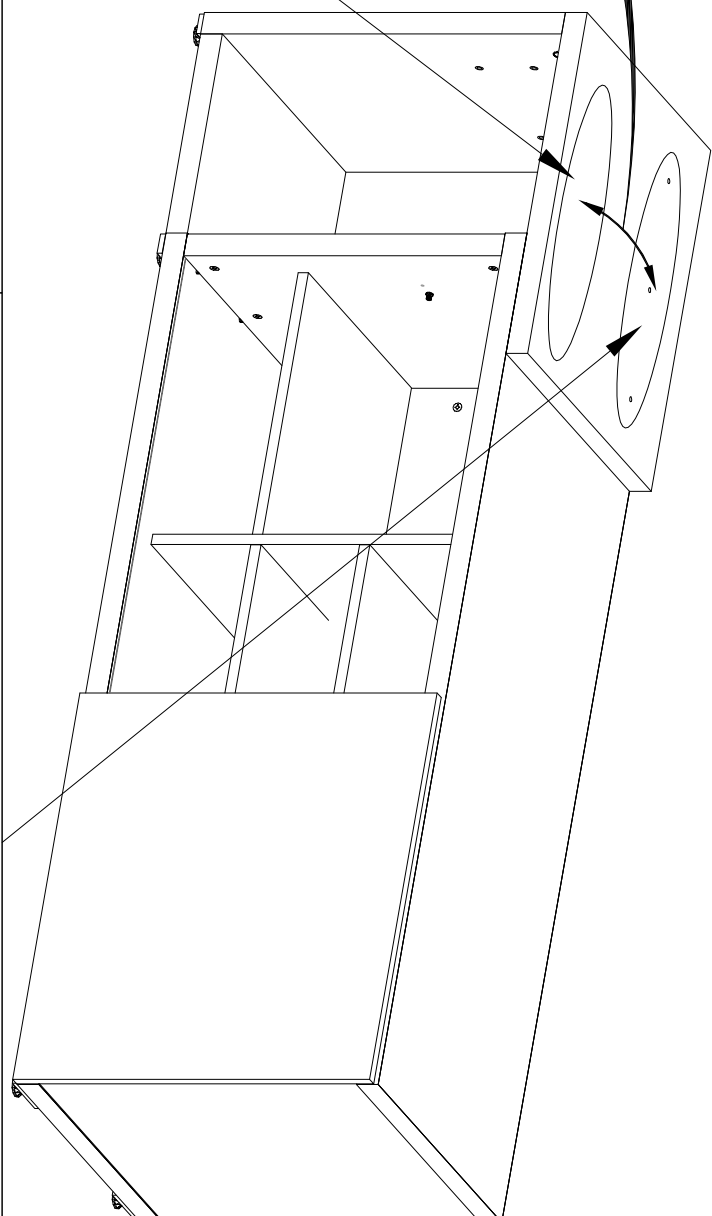
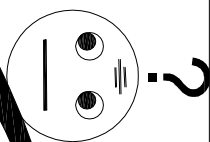
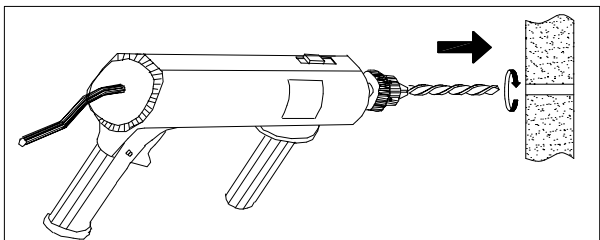

MIT1
MIT2

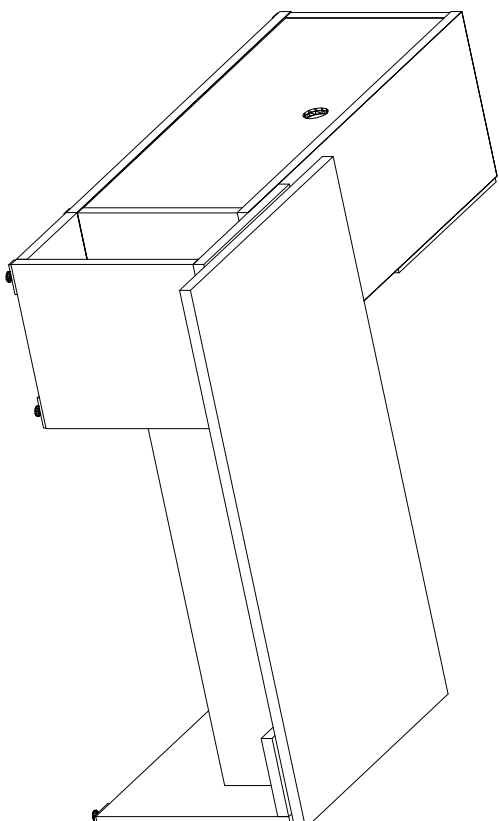
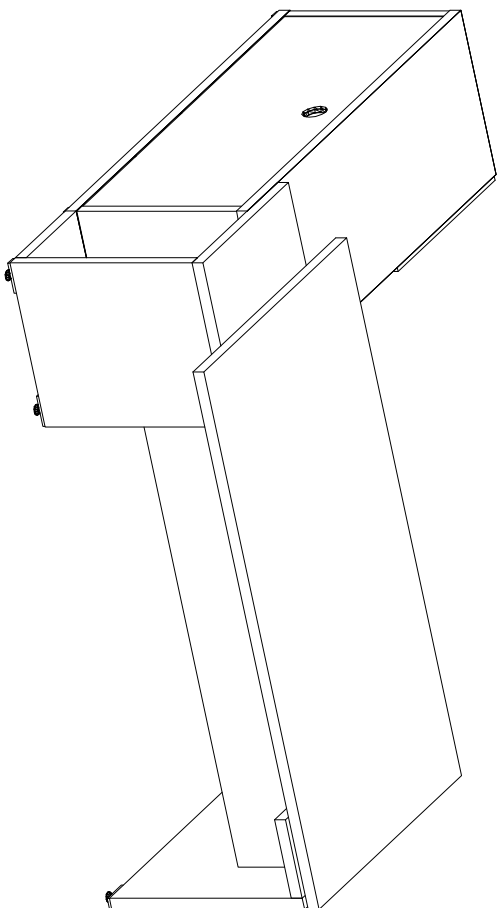



MIT1
MIT2

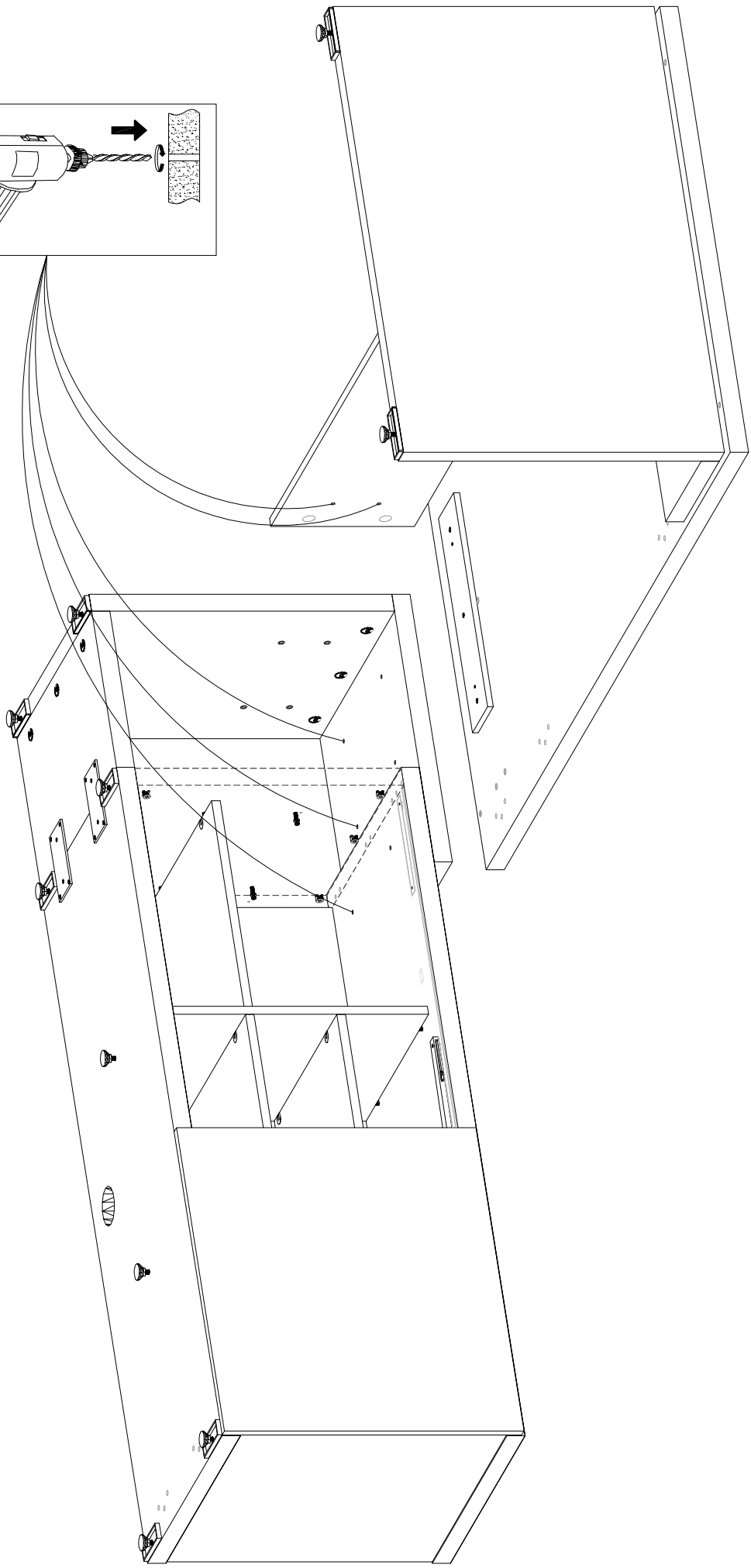
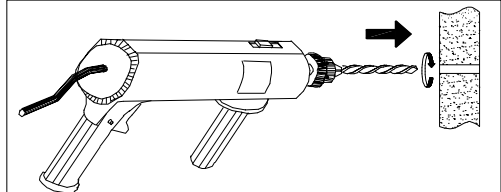

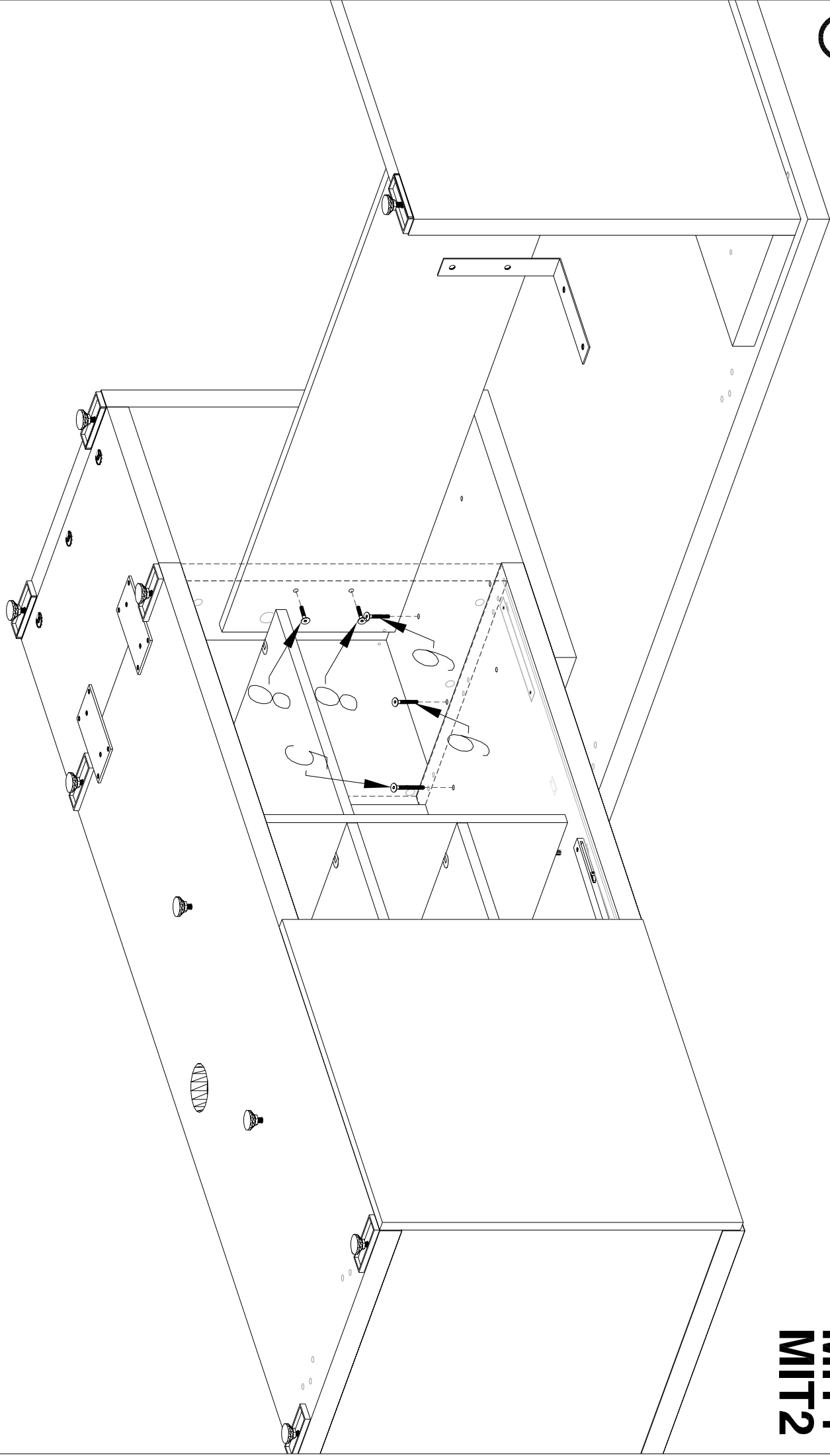

MIT1
MIT2

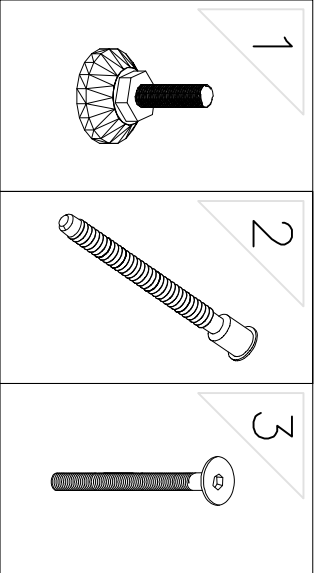

MIT1,2,3,4K

A

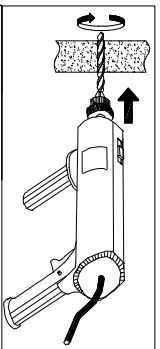
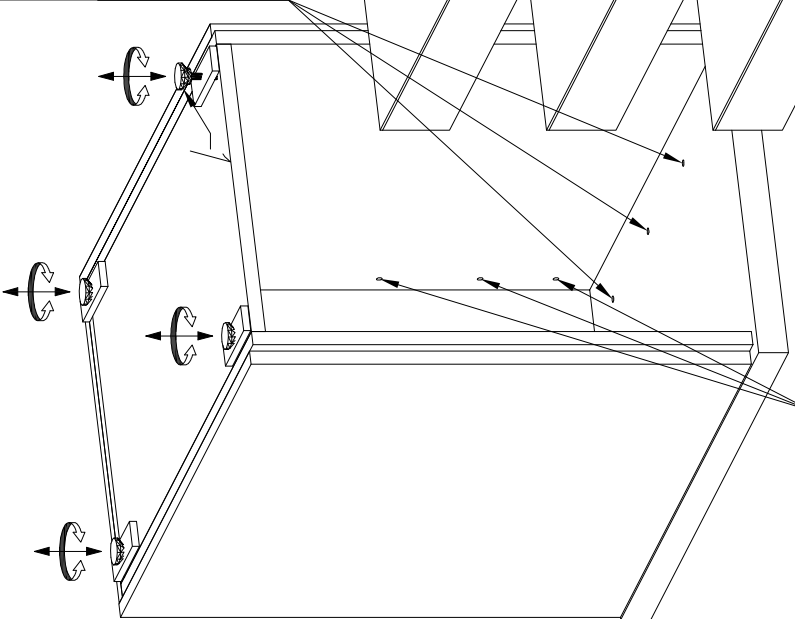
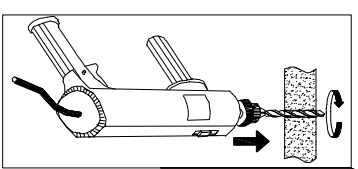

LEFT

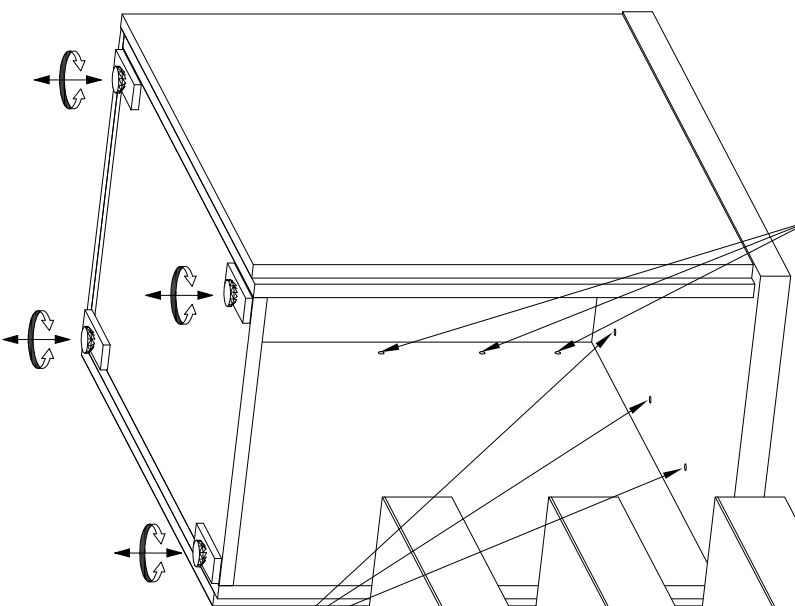
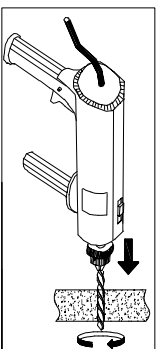
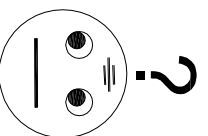

RIGHT

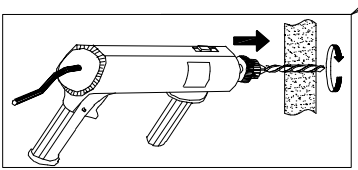

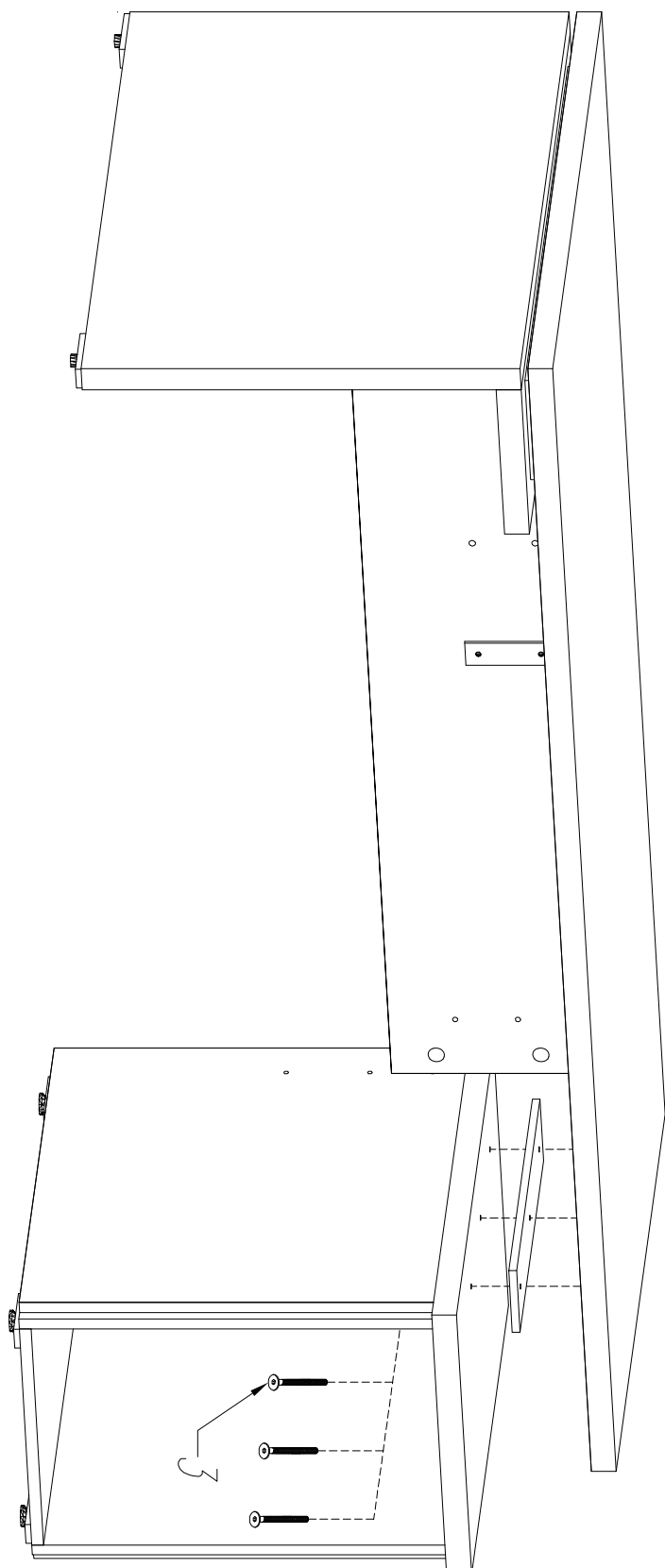
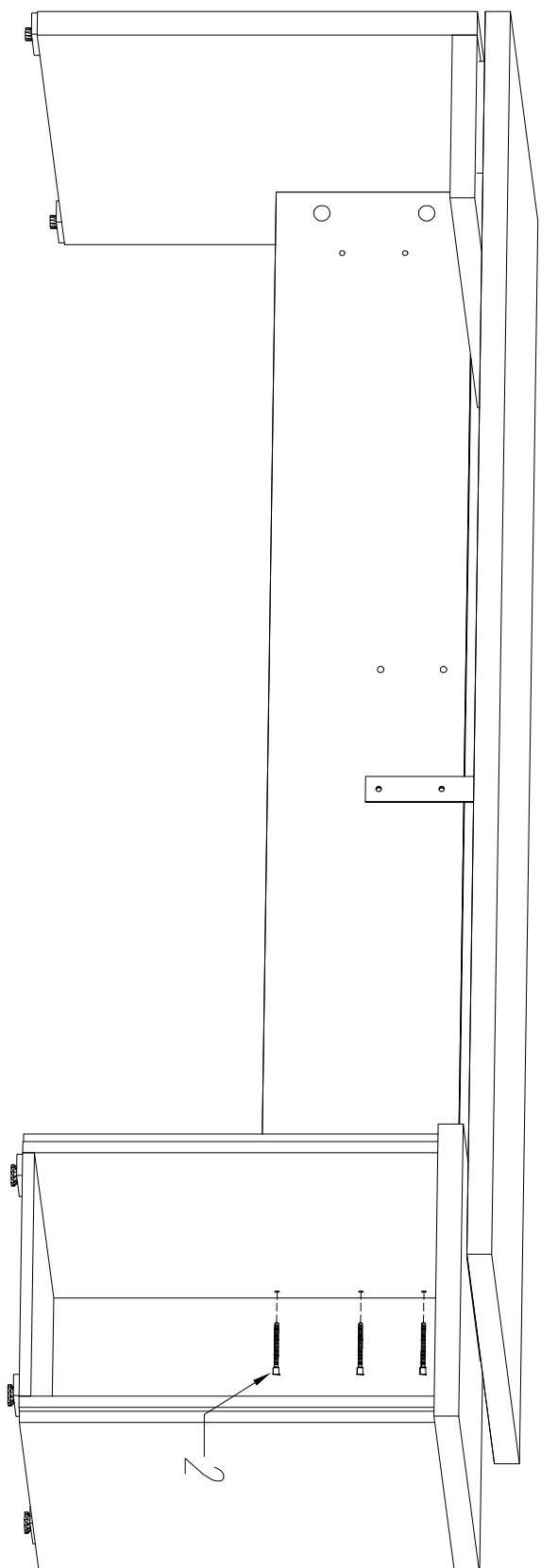

MEDIAPORT

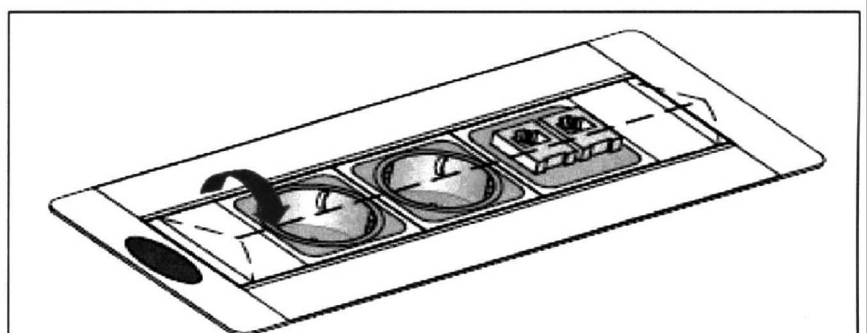
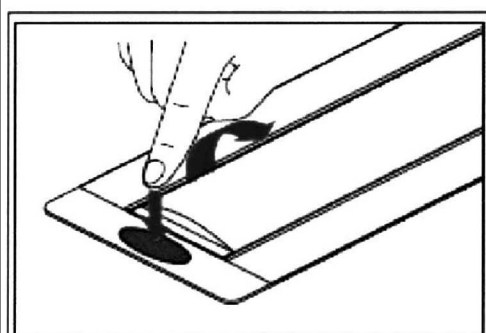
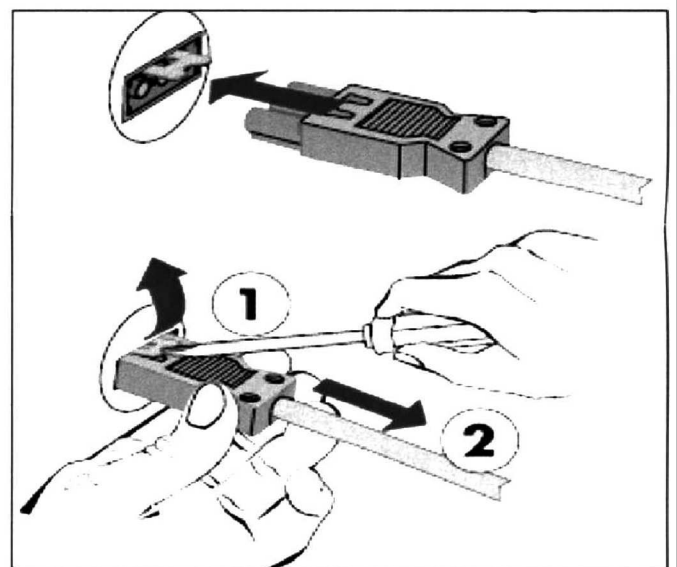
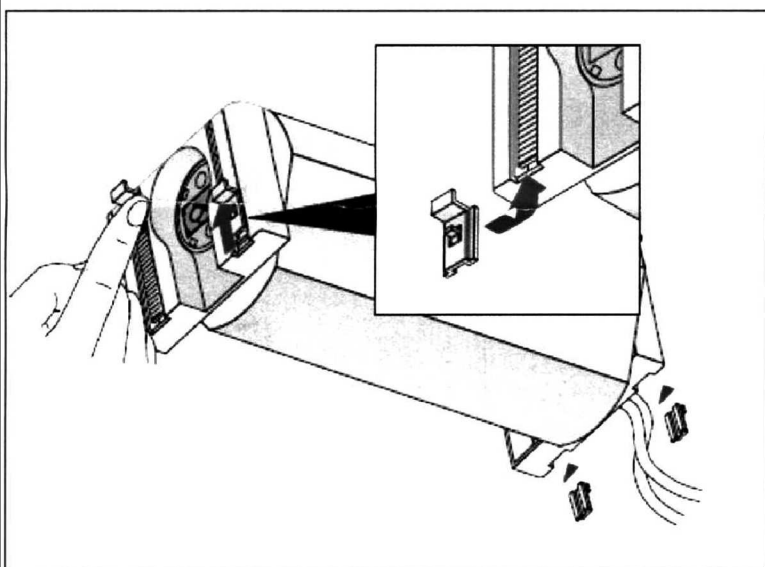
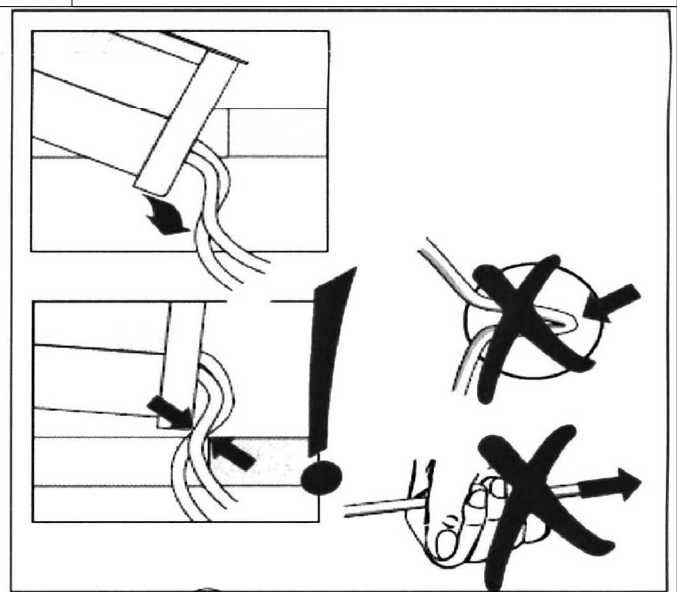
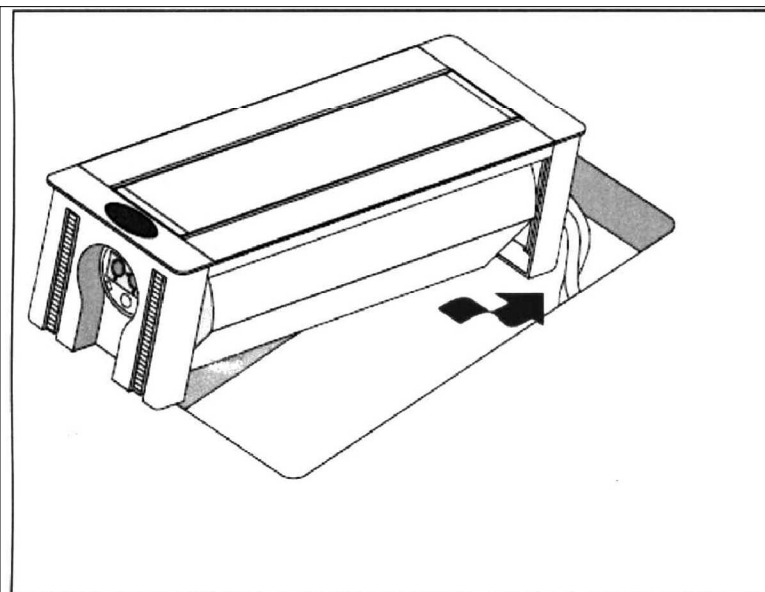

INSTRUKCJA NAPRAWY ZABLOKOWANEGO MEDIAPORTU

W przypadku kiedy mediaport zostanie zablokowany w pozycji niepełnego otwarcia należy:

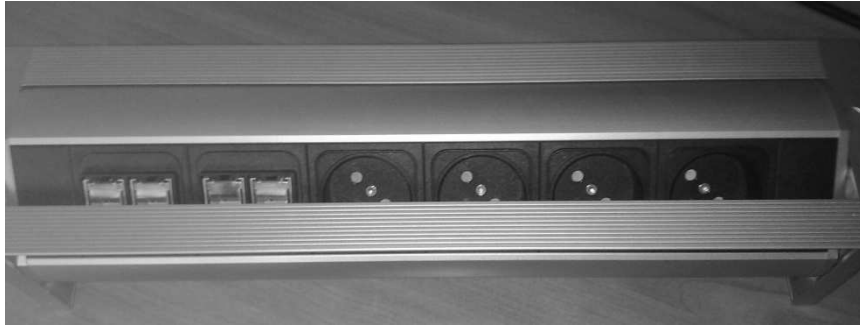

1. Zdemontować pokrywę boczną, a następnie upewnić się, że drut sprężynowy jest poprawnie zamontowany w pokrywie bocznej (jak na zdjęciu)



2. Zmontować mediaport tak aby dolna część drutu sprężynowego przychodziła pomiędzy dwa trzpienie wystające z korpusu (jak poniżej rysowana linia)



Wrysowana linia przedstawia poprawne ułożenie drutu sprężynowego osadzonego w pokrywie bocznej względem trzpieni wystających z korpusu. Montując pokrywę boczną, w której osadzony jest drut sprężynowy należy upewnić się, że drut jest w położeniu odpowiadającym wrysowanej linii na zdjęciu z lewej strony.