

1	
2	
3	
4	
5	
6	
7	
8	
9	
10	
11	

MIT3\_4\_9



KOLEŃNOŚĆ MONTAŻU  
IMMOBILIZACJI  
DIE FITTINGS SEQUENCE OF THE  
CAMS.  
DIE MONTAGEABFOLGE VON  
EXZENTERN.

(A)

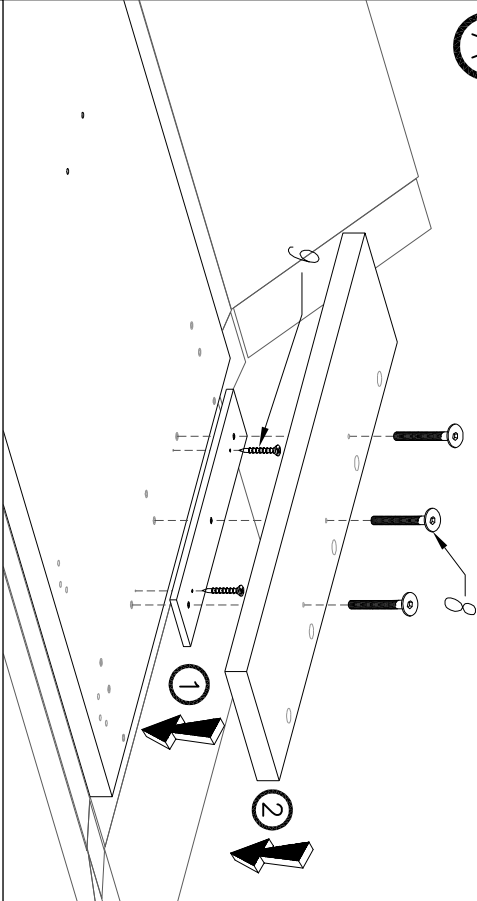

(C)

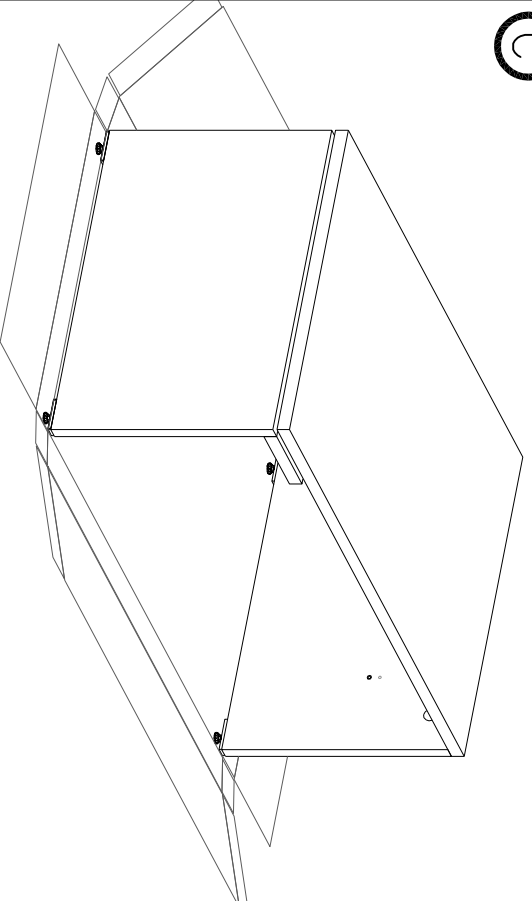

(B)

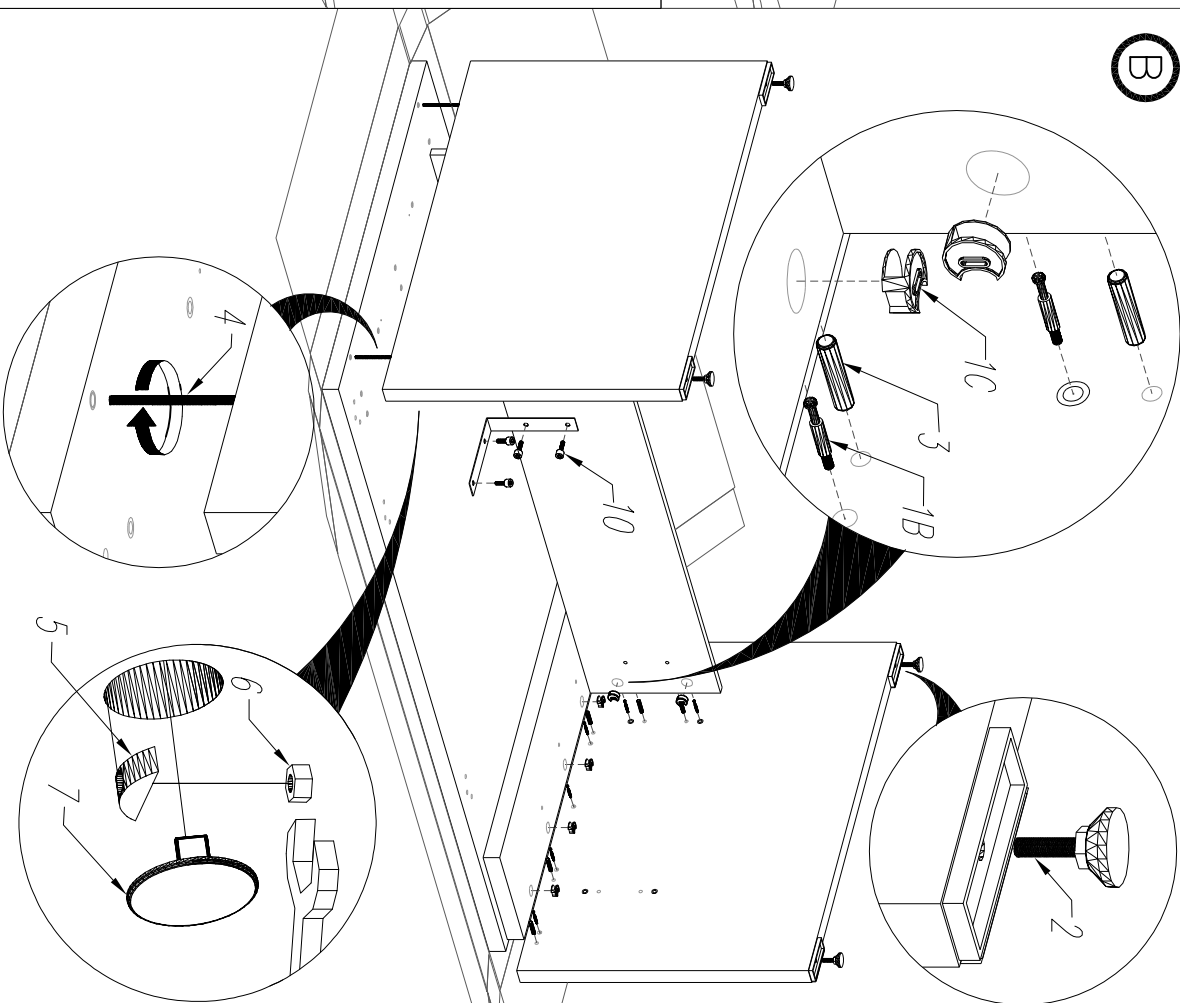

①

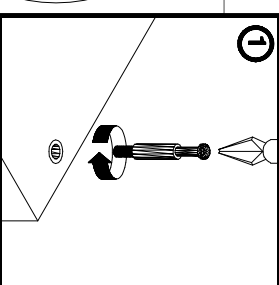

②

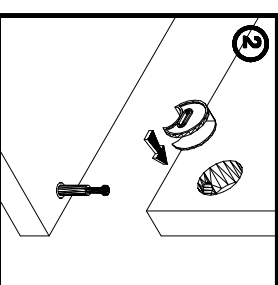

③

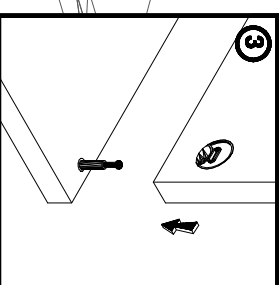

④

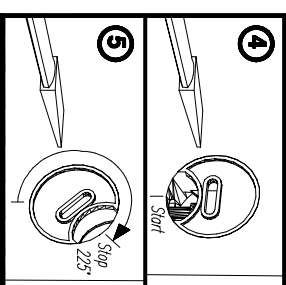

⑤

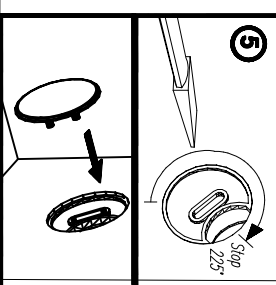

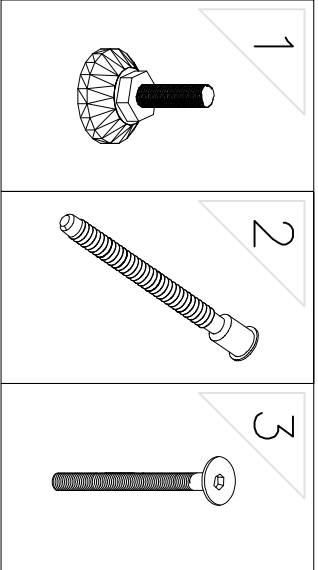

MIT1,2,3,4K

A

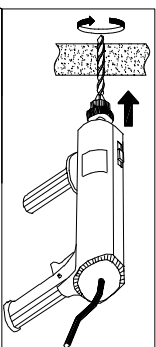
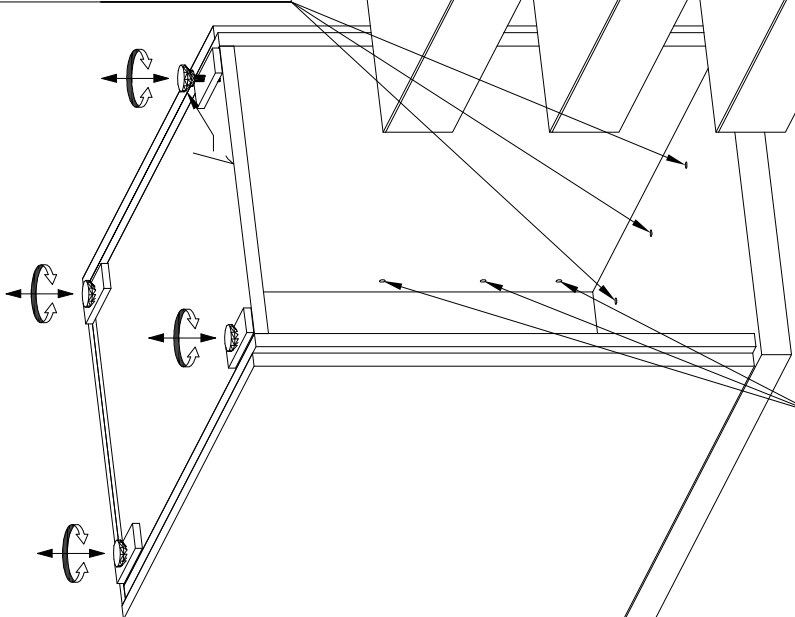
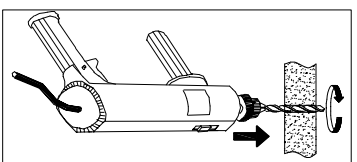

LEFT

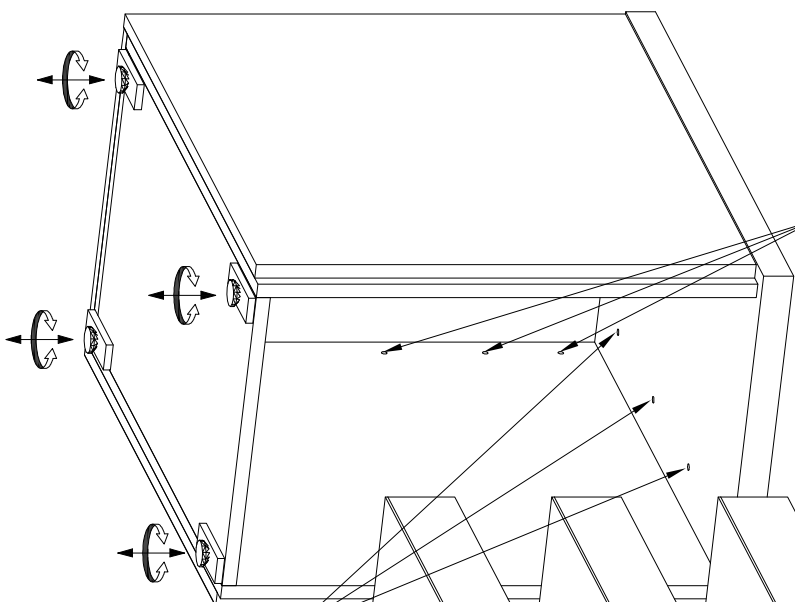
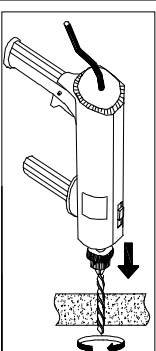
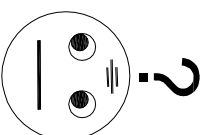

RIGHT

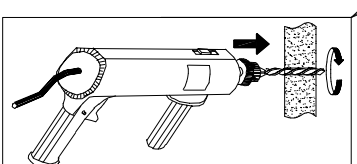

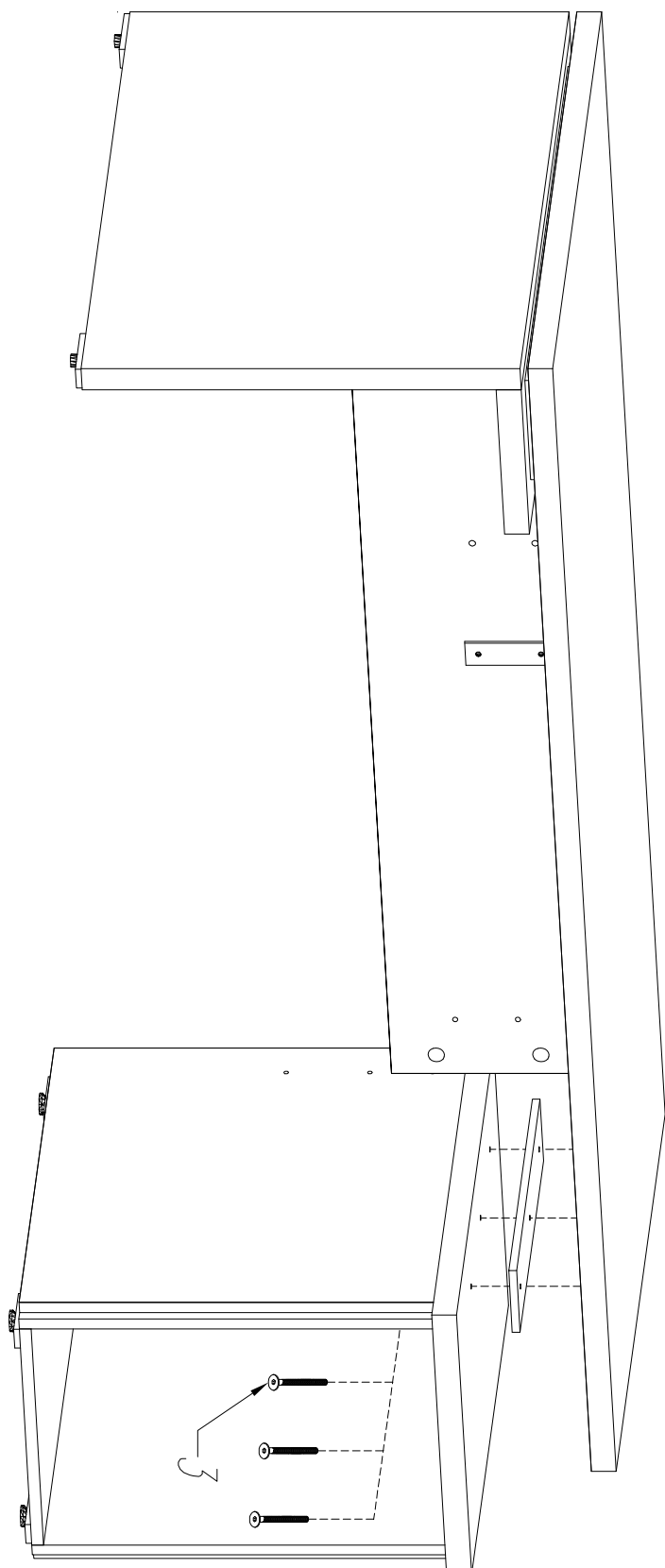
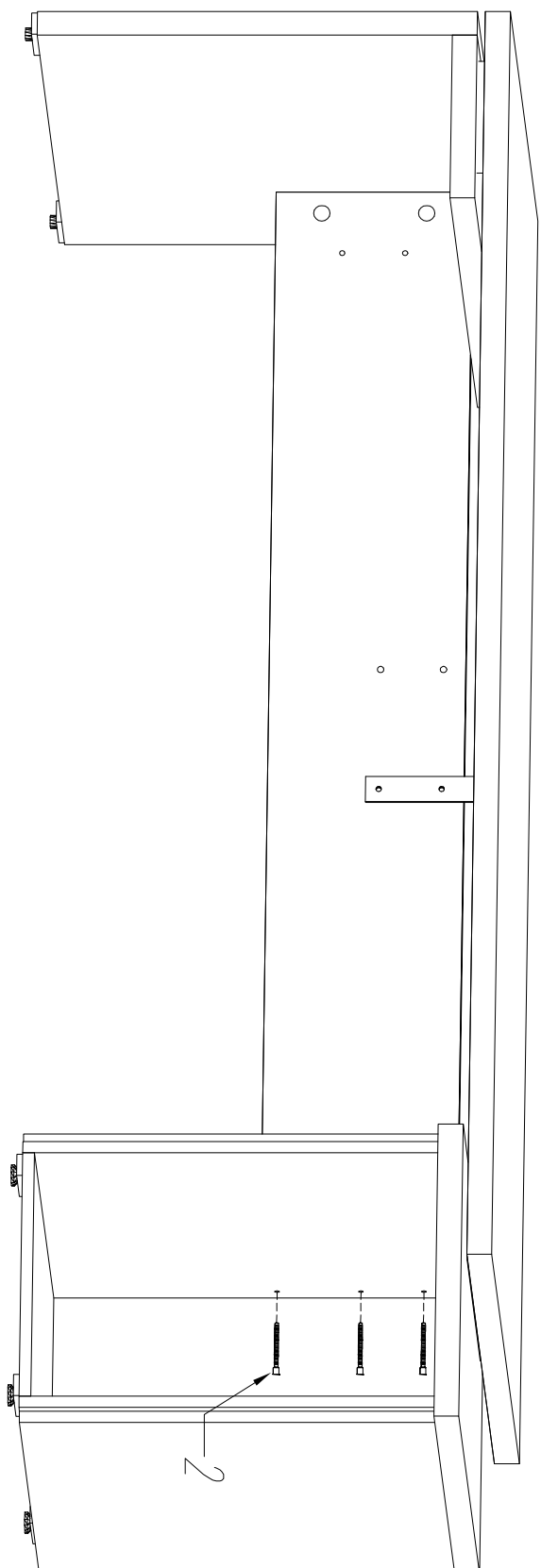

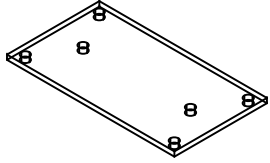

E40

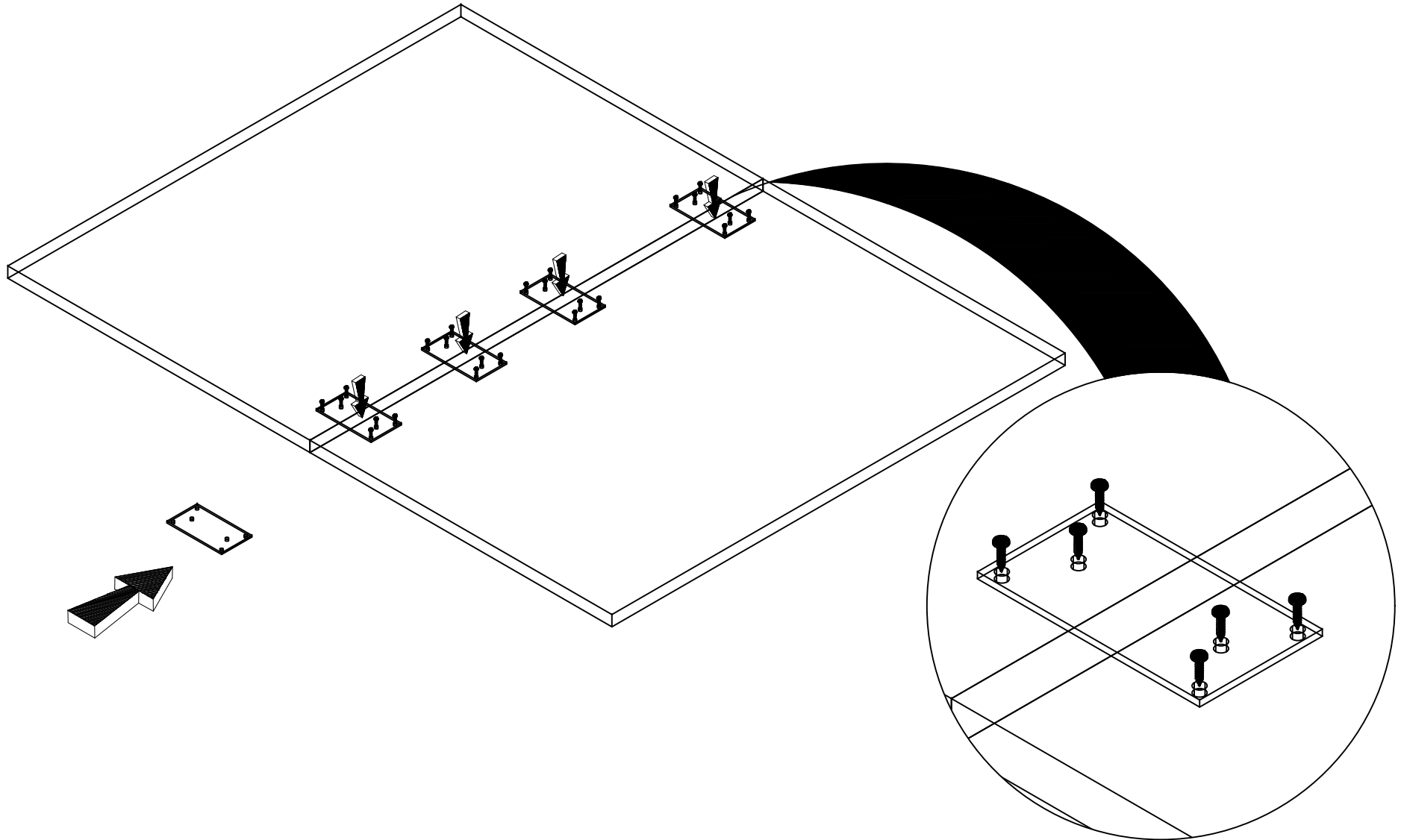

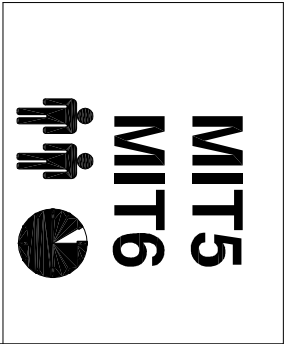

- |    |  |
|----|--|
| 1  |  |
| 2  |  |
| 3  |  |
| 4  |  |
| 5  |  |
| 6  |  |
| 7  |  |
| 8  |  |
| 9  |  |
| 10 |  |

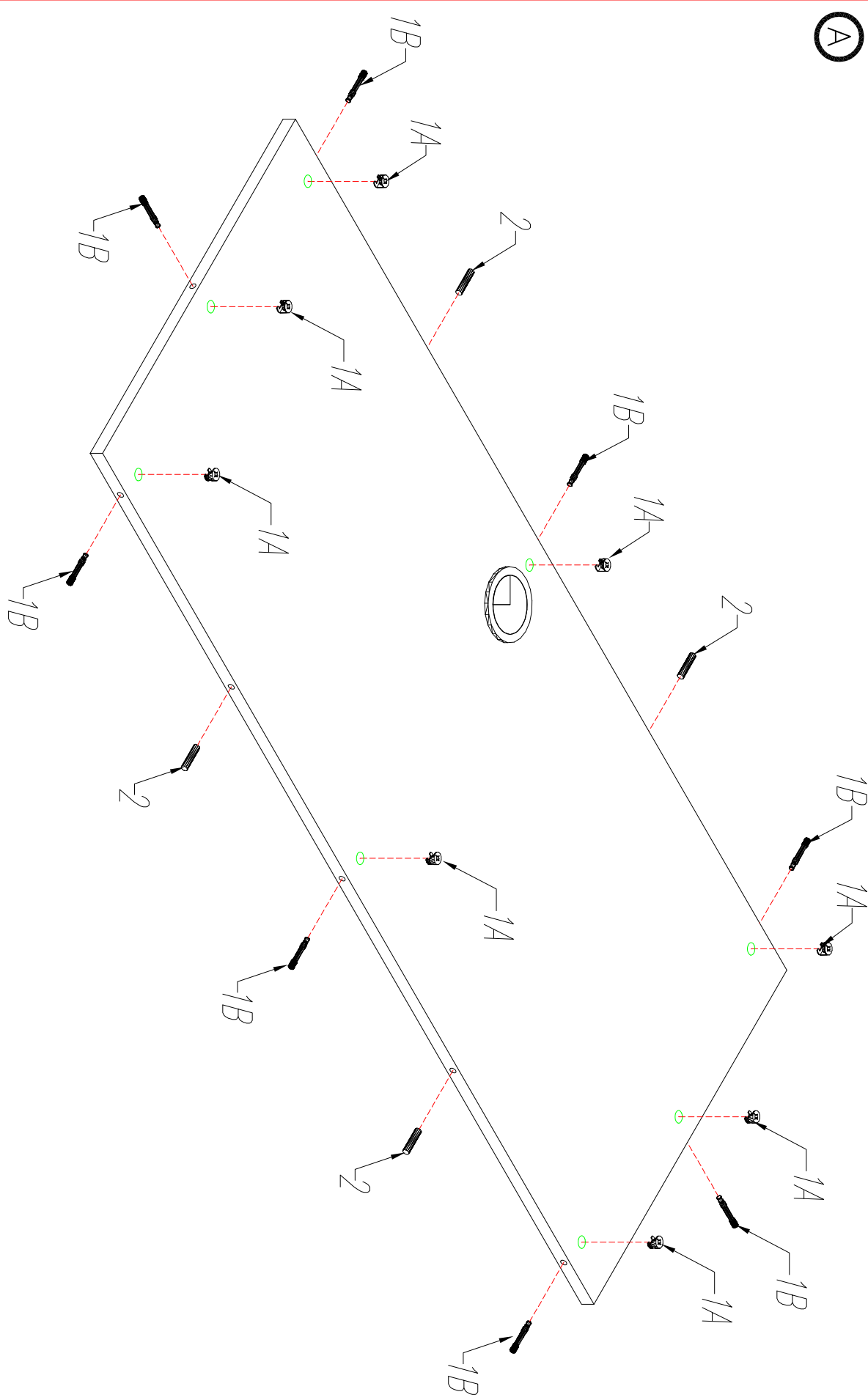

KOLEJNOŚĆ MONTAŻU  
MIMOŚRODKÓW I KOLKÓW.  
THE FITTINGS SEQUENCE OF THE  
CAMS AND DOWELS.  
DIE MONTAGEFOLGE VON  
EXZENTERN UND DUEBELN.

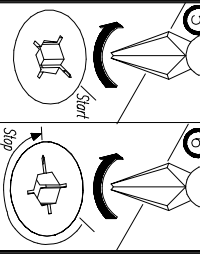
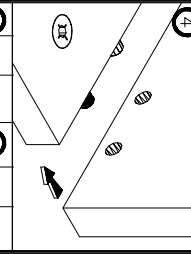
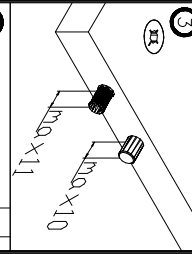
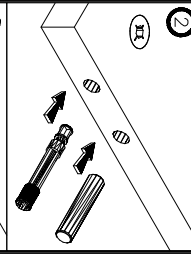
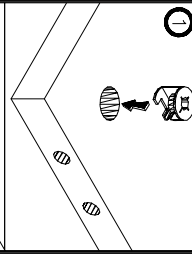

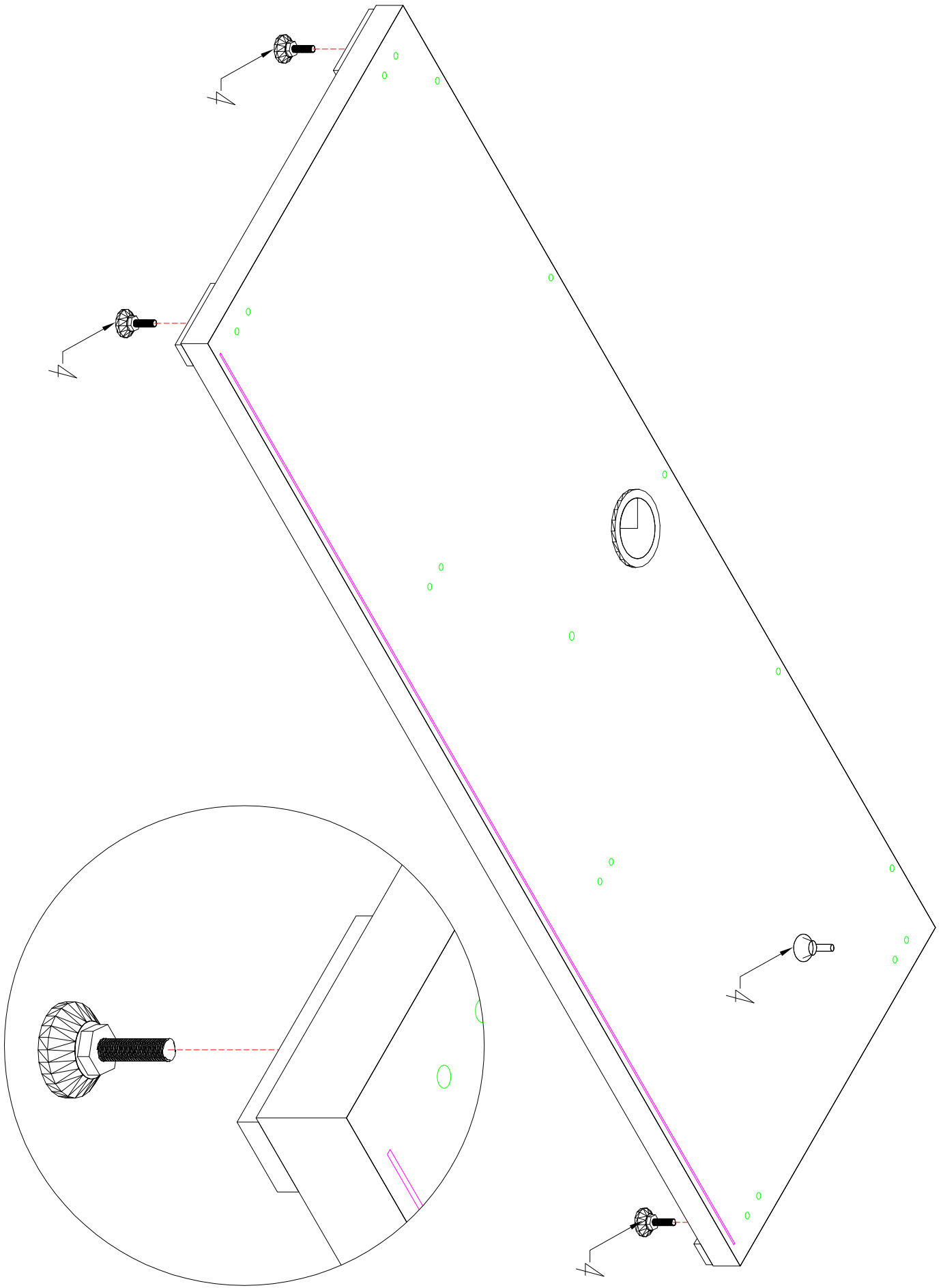

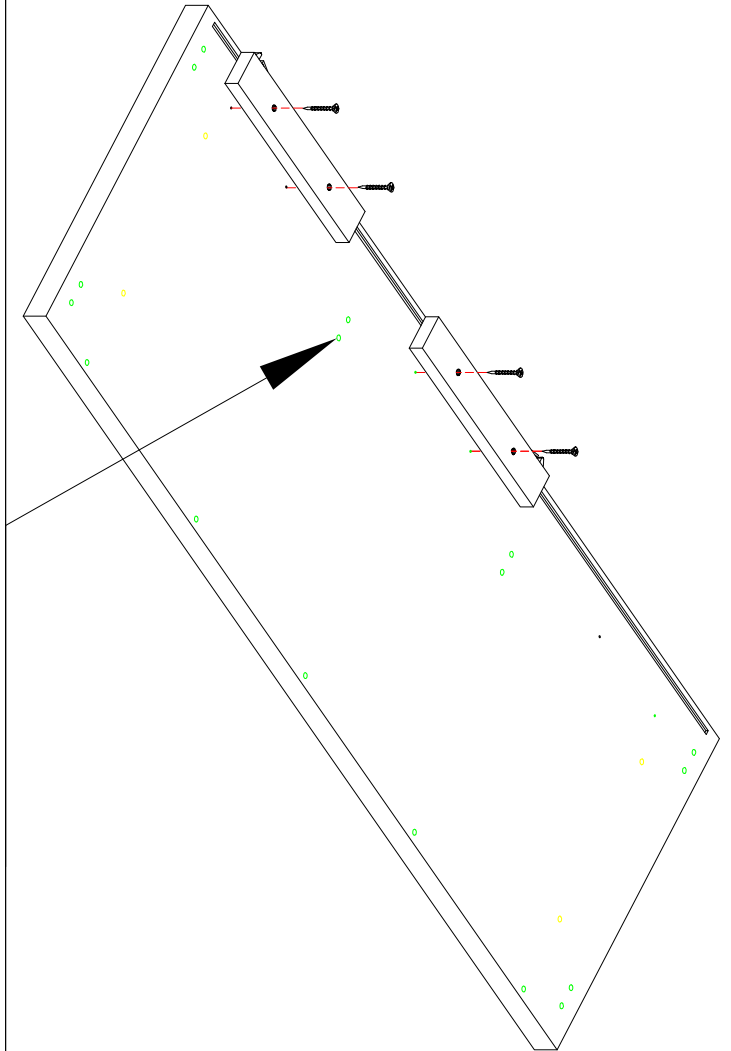
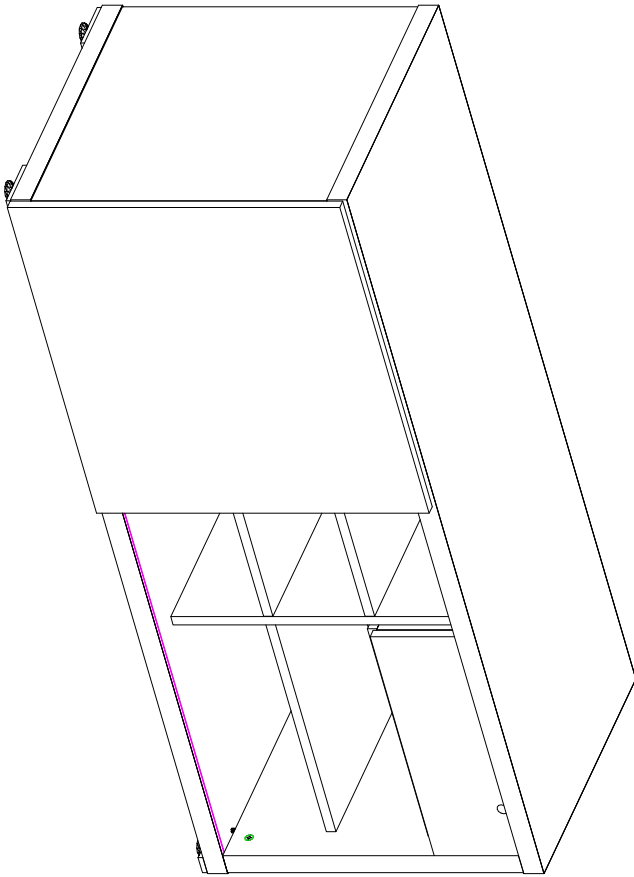
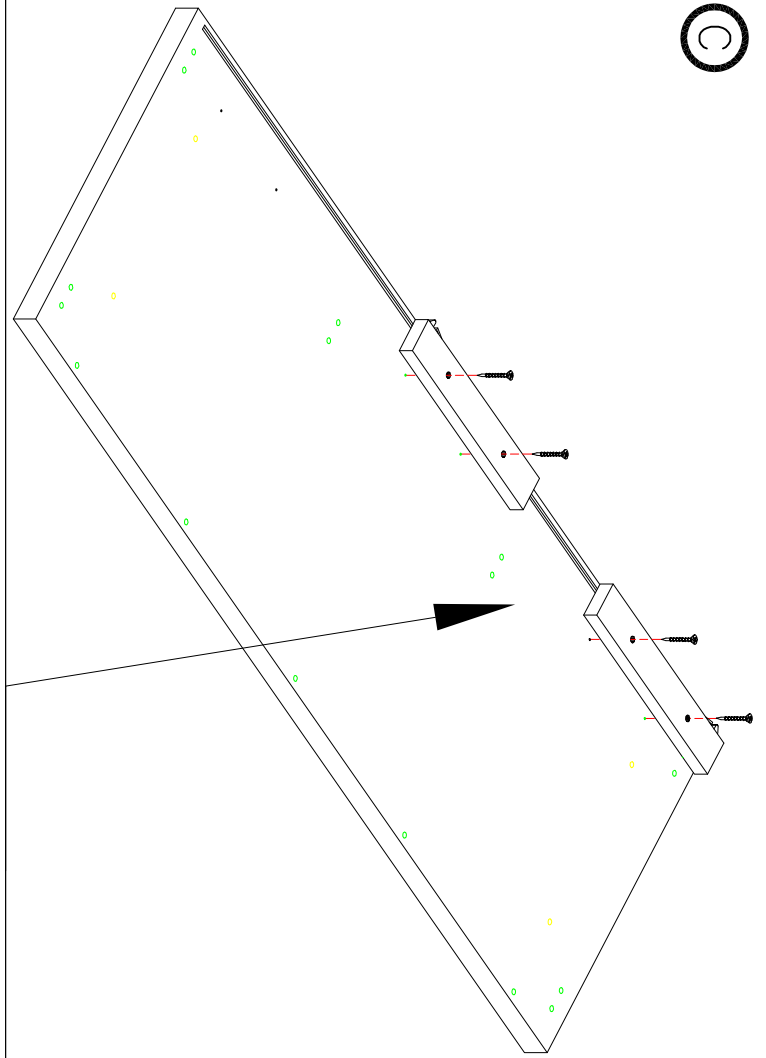
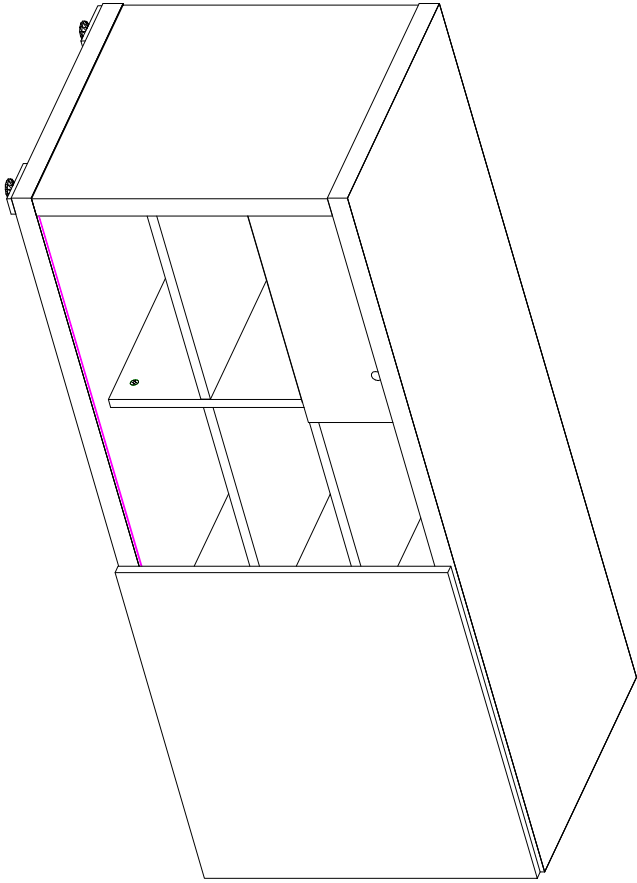

D

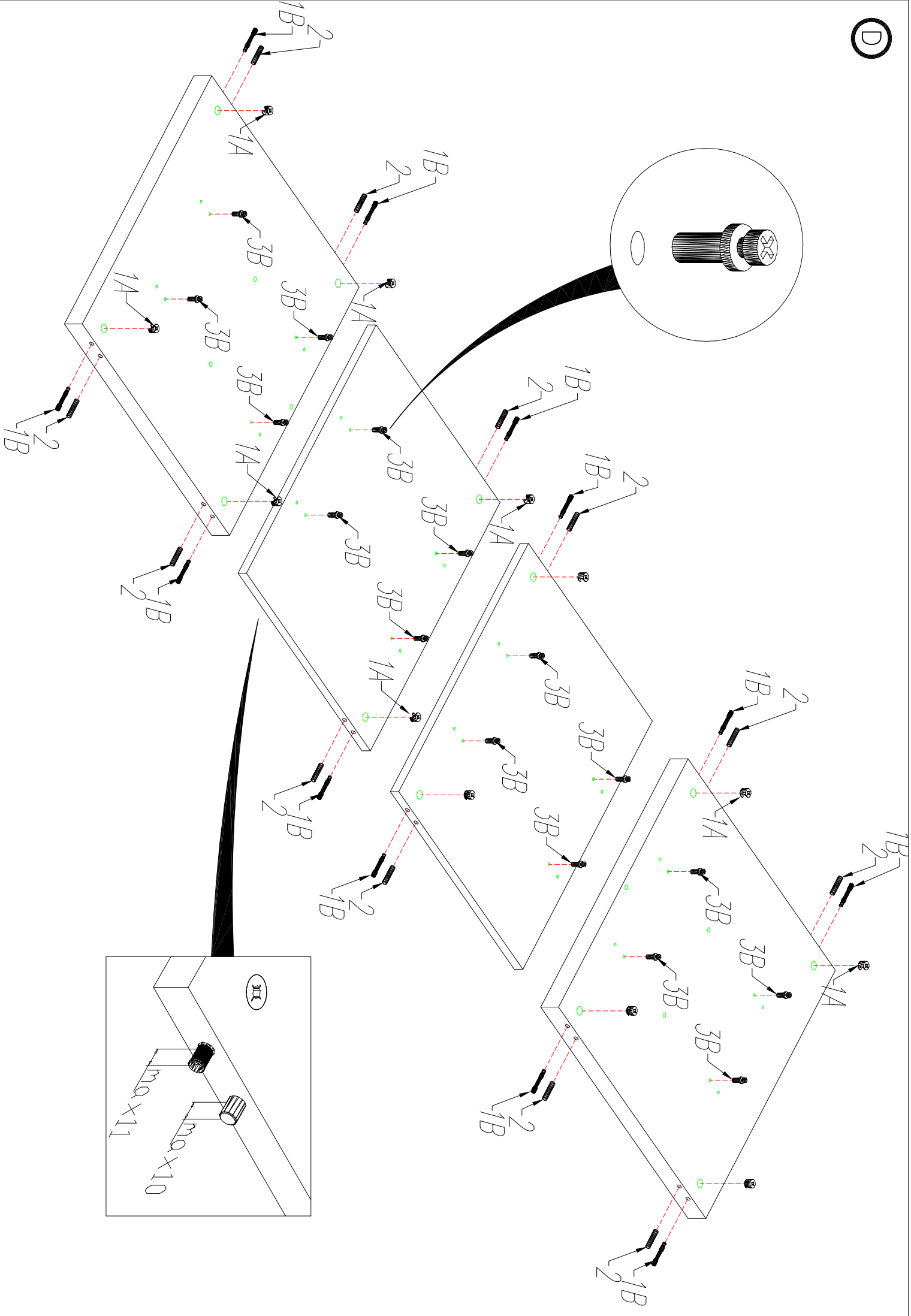



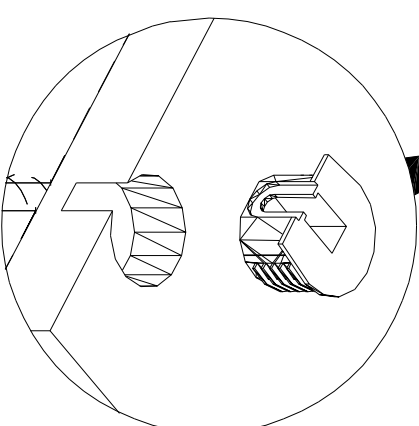
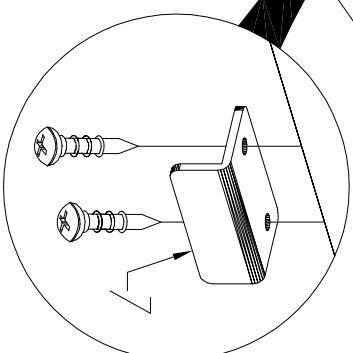
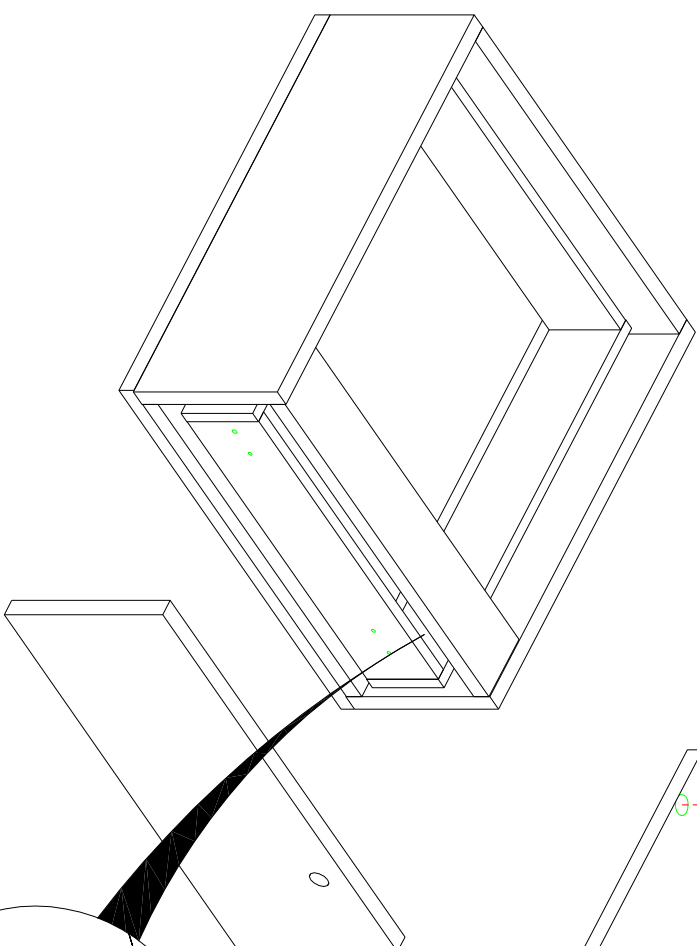
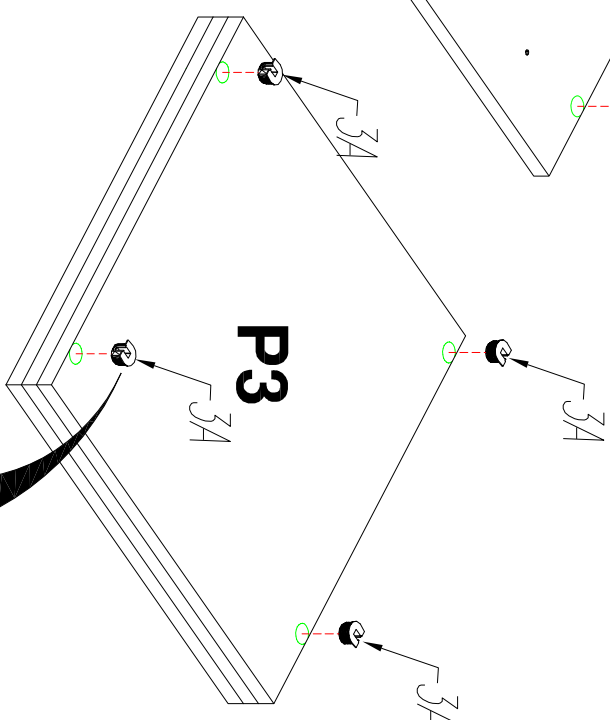
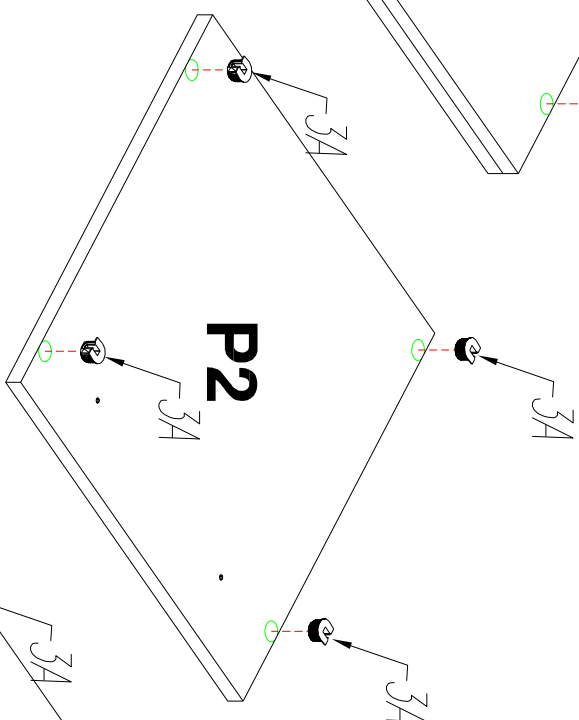
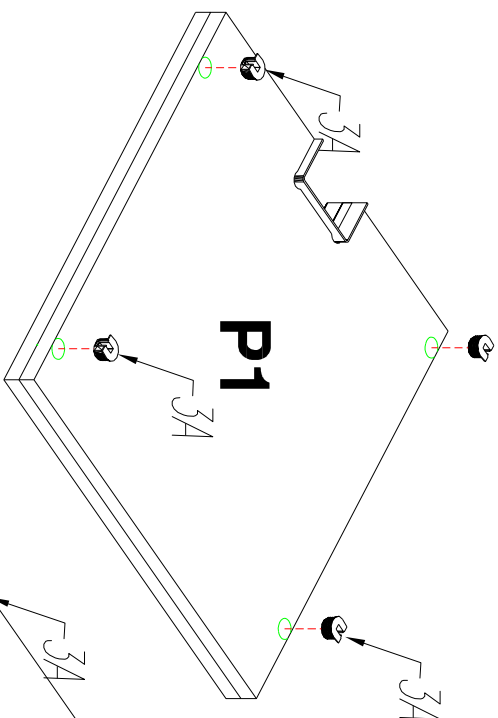

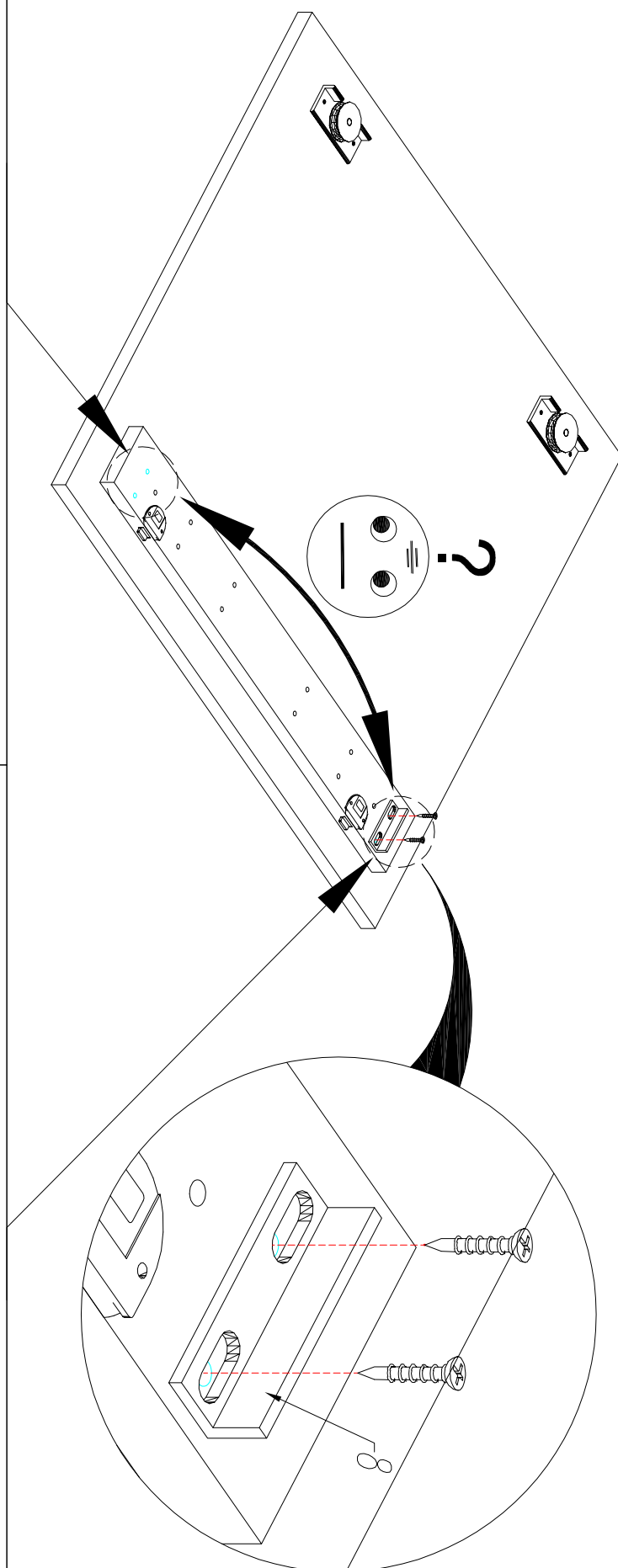
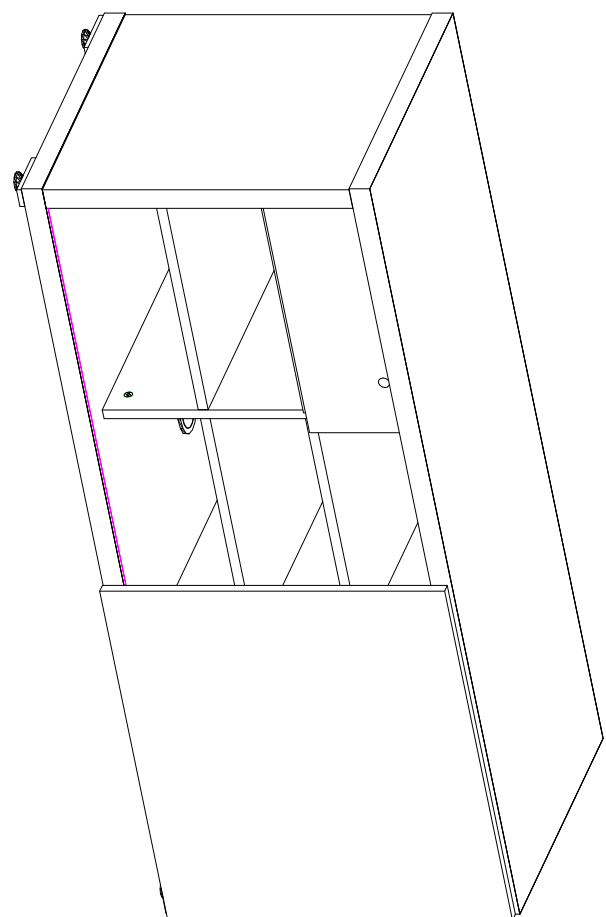
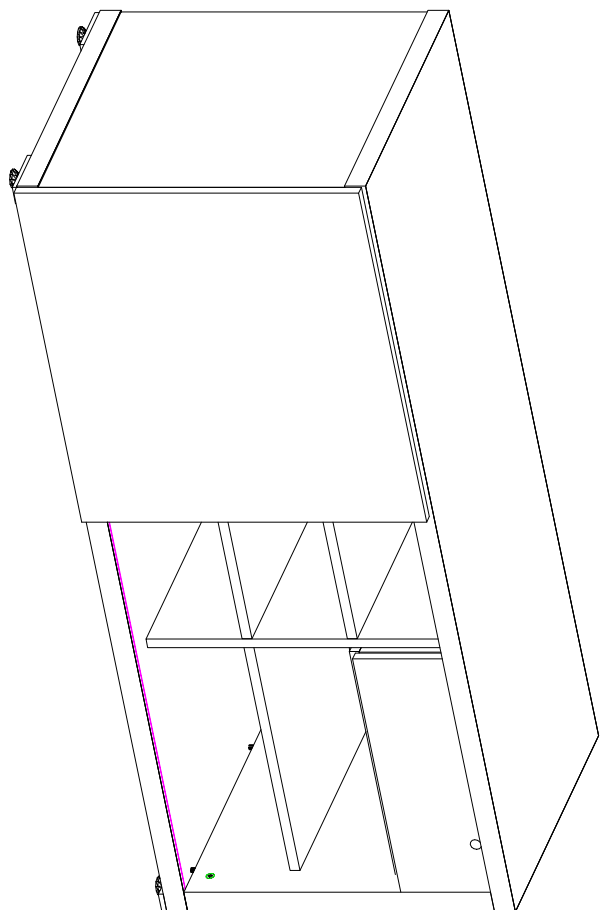

1

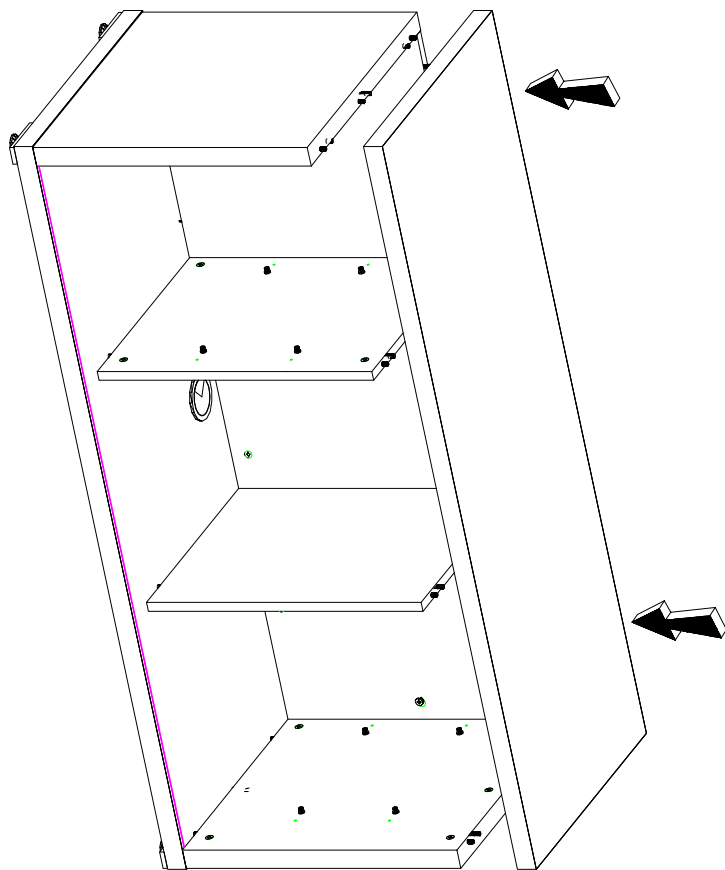

2

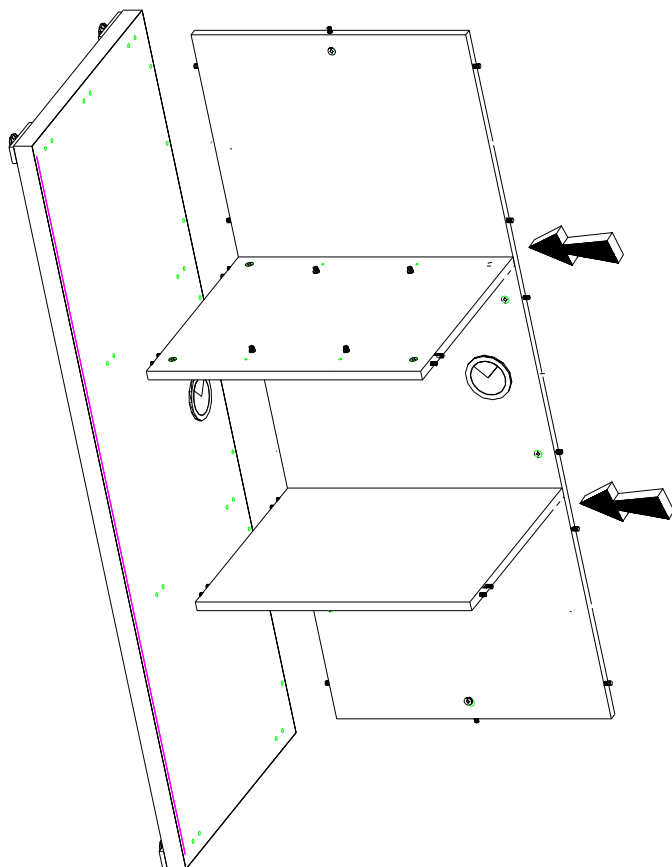

3

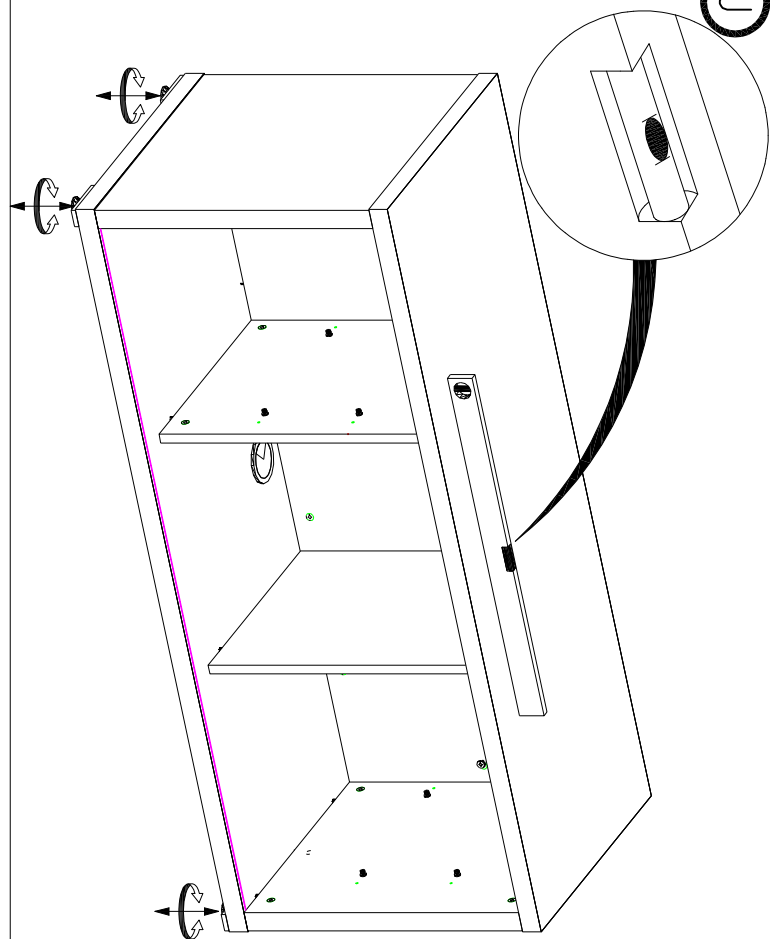

4

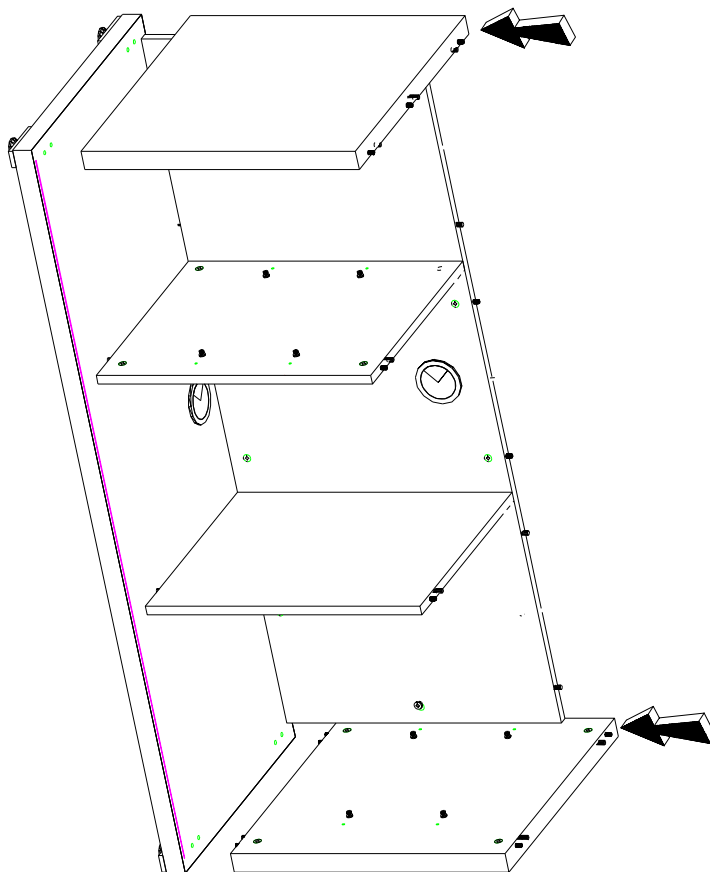

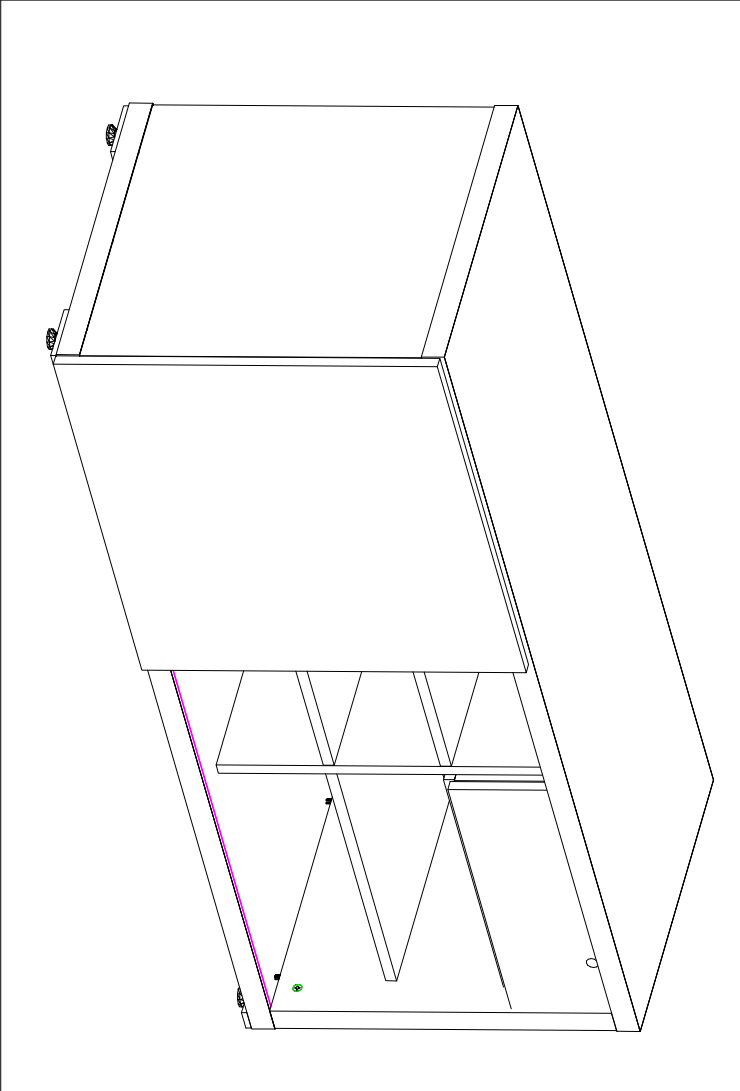
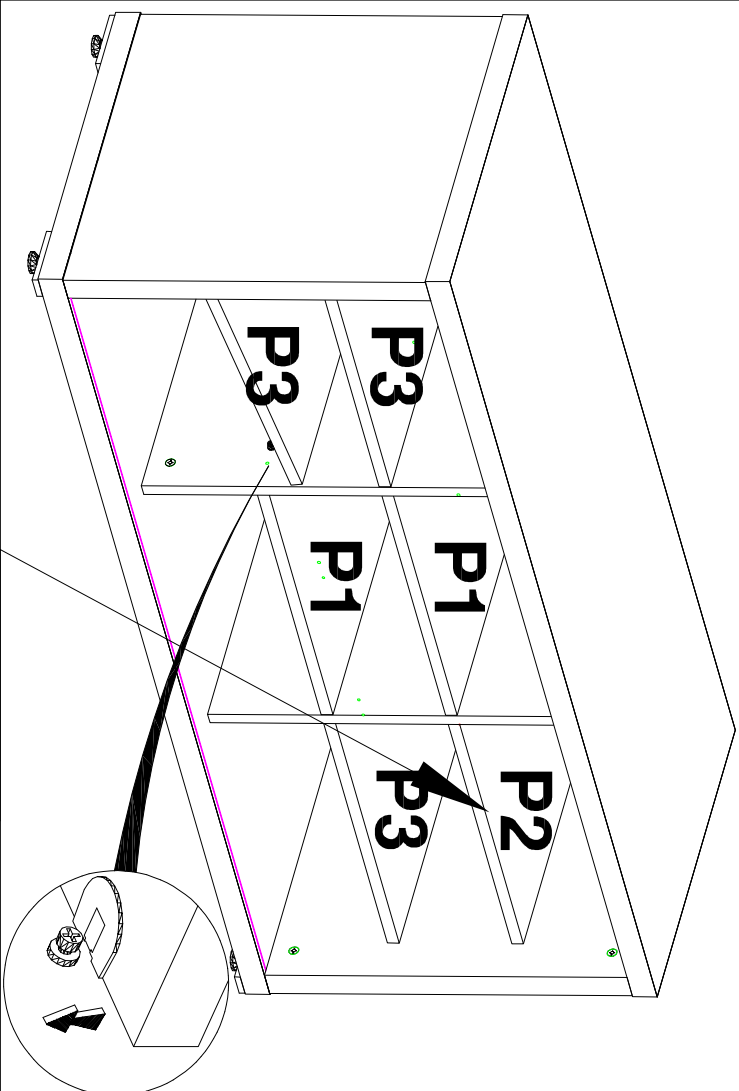
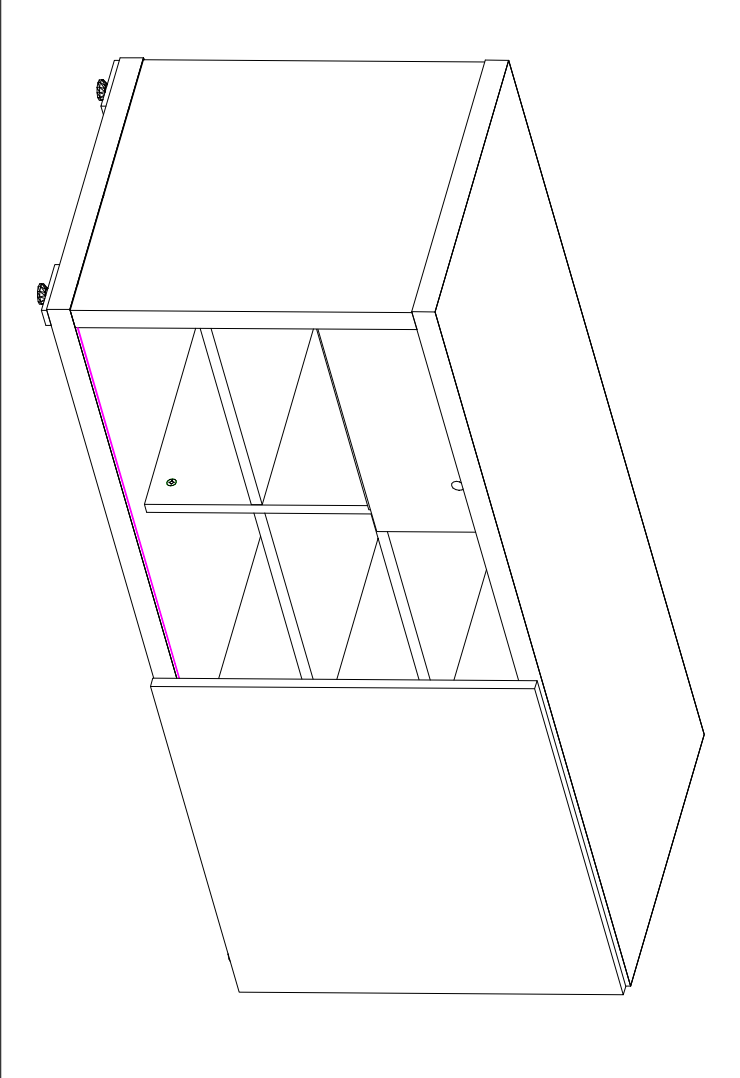
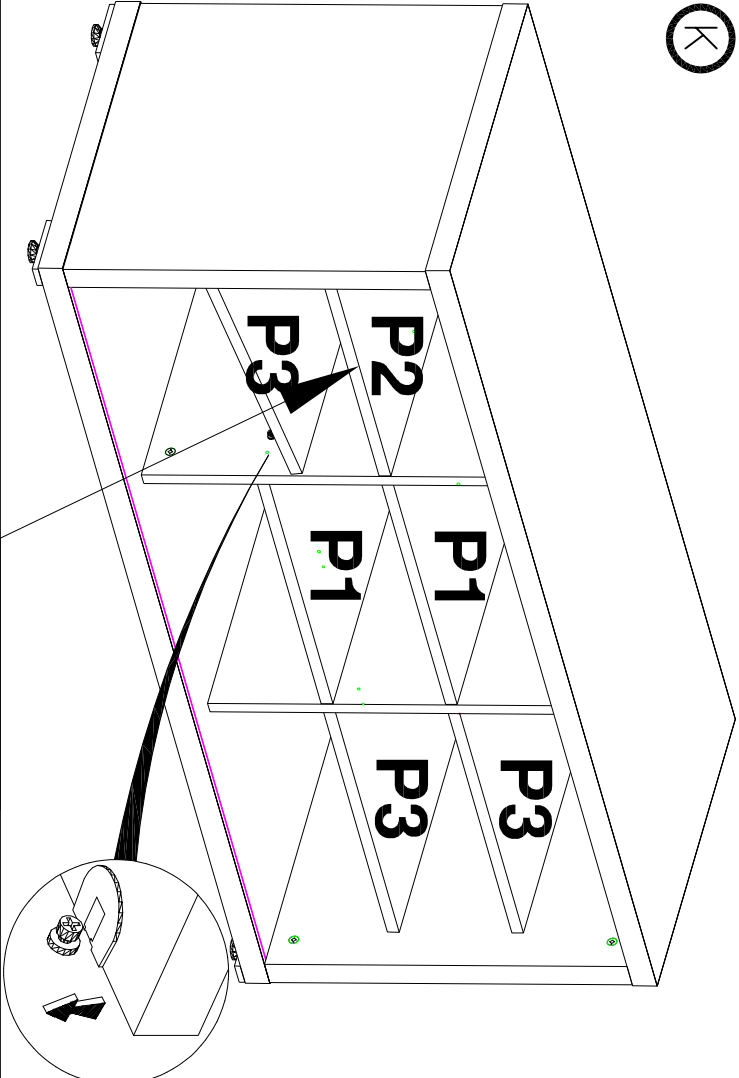

L

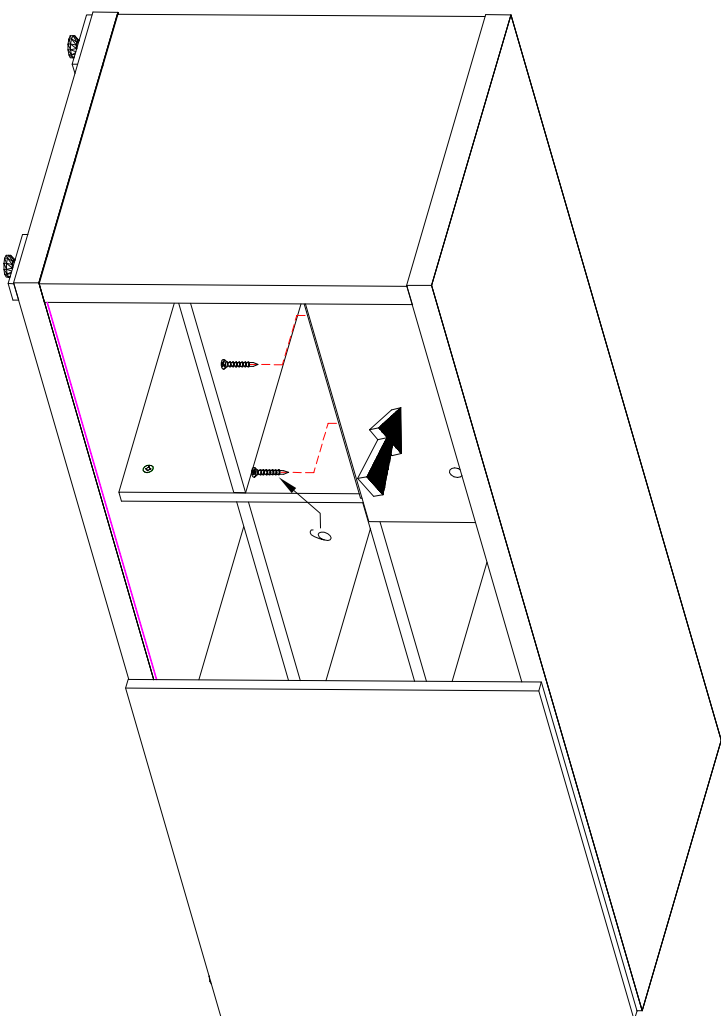

-Przykręcić śruby z  
małą siłą.  
-Put the screws gently.  
-Anschrauben die  
Schrauben zierlich.

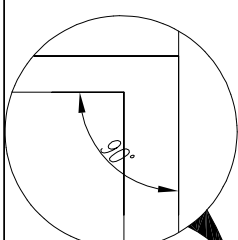
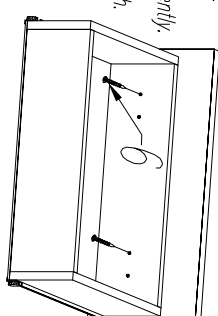

-Przykręcić śruby z  
dużą siłą.  
-Put the screws strongly.  
-Anschrauben die  
Schrauben stierlich.

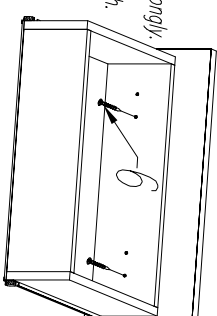

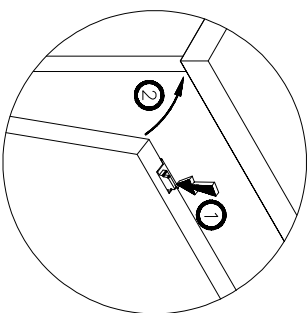
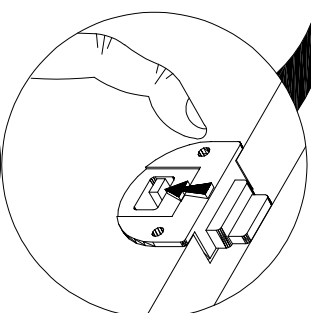
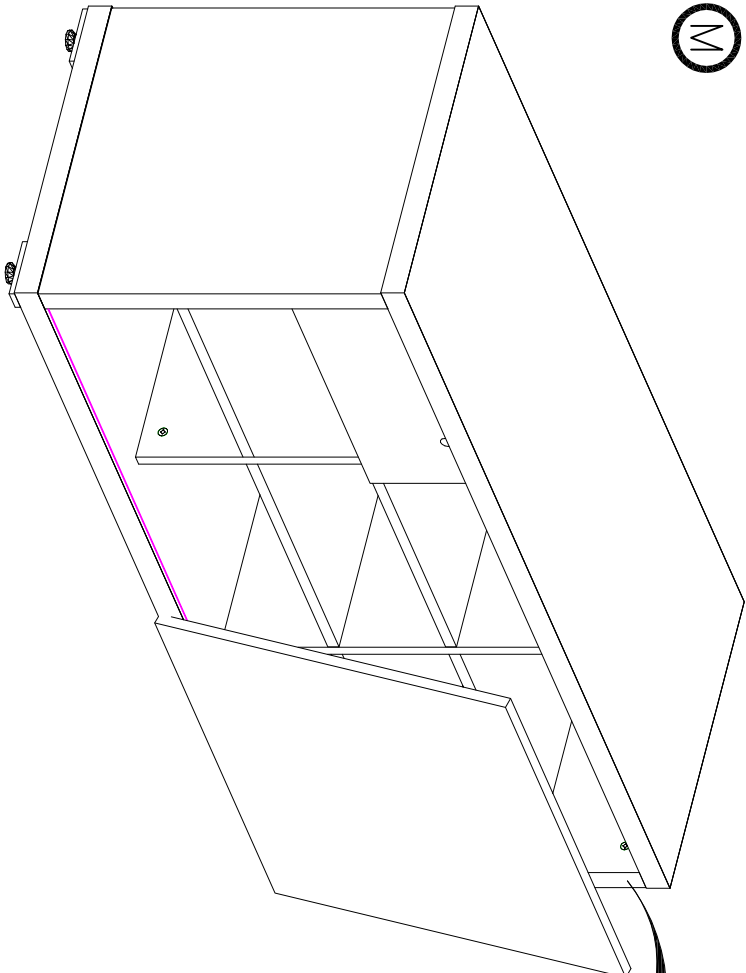

M

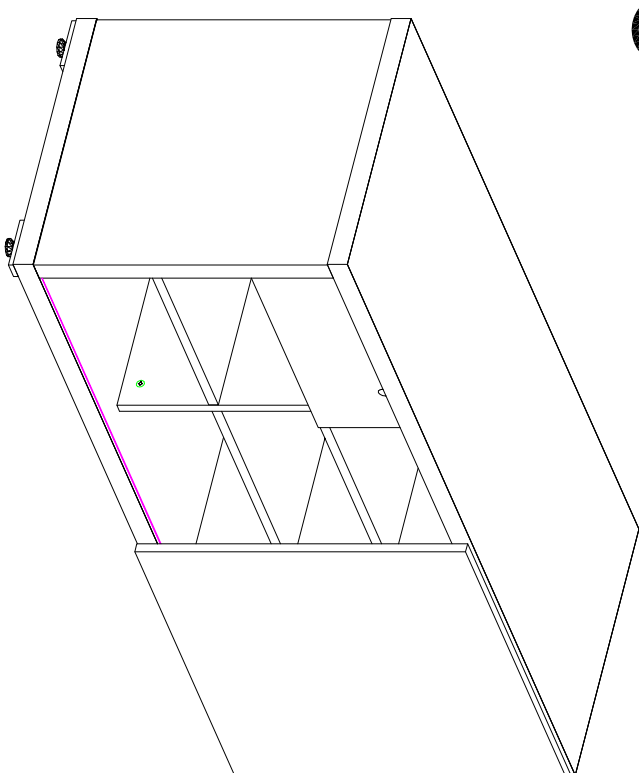

N

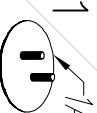

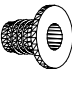
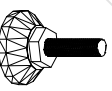
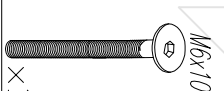
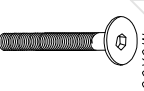
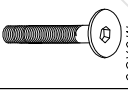
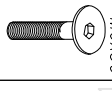
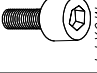
1		1/14
2		ø8x36
3		
4		
5		M6x100
6		M6x60
7		M6x50
8		M6x30
9		M6x14

KOLEJNOŚĆ MONTAŻU

МОНТАЖНОЕ ПОРЯДОК.

THE FITTINGS SEQUENCE OF THE

GAMS.

DIE MONTAGEABFOLGE VON

EXZENTERN.

A

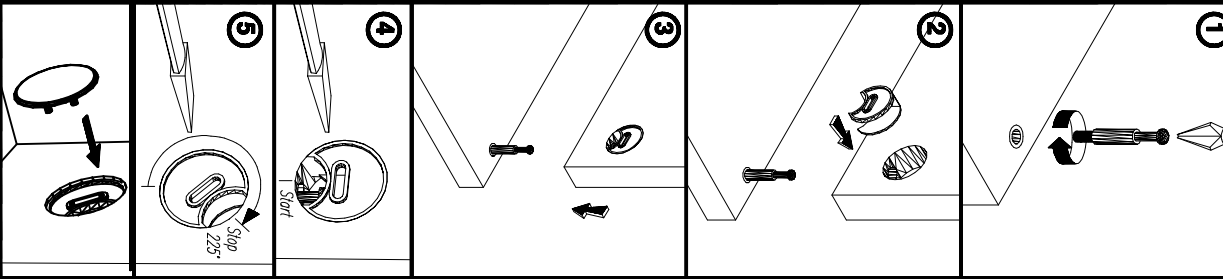
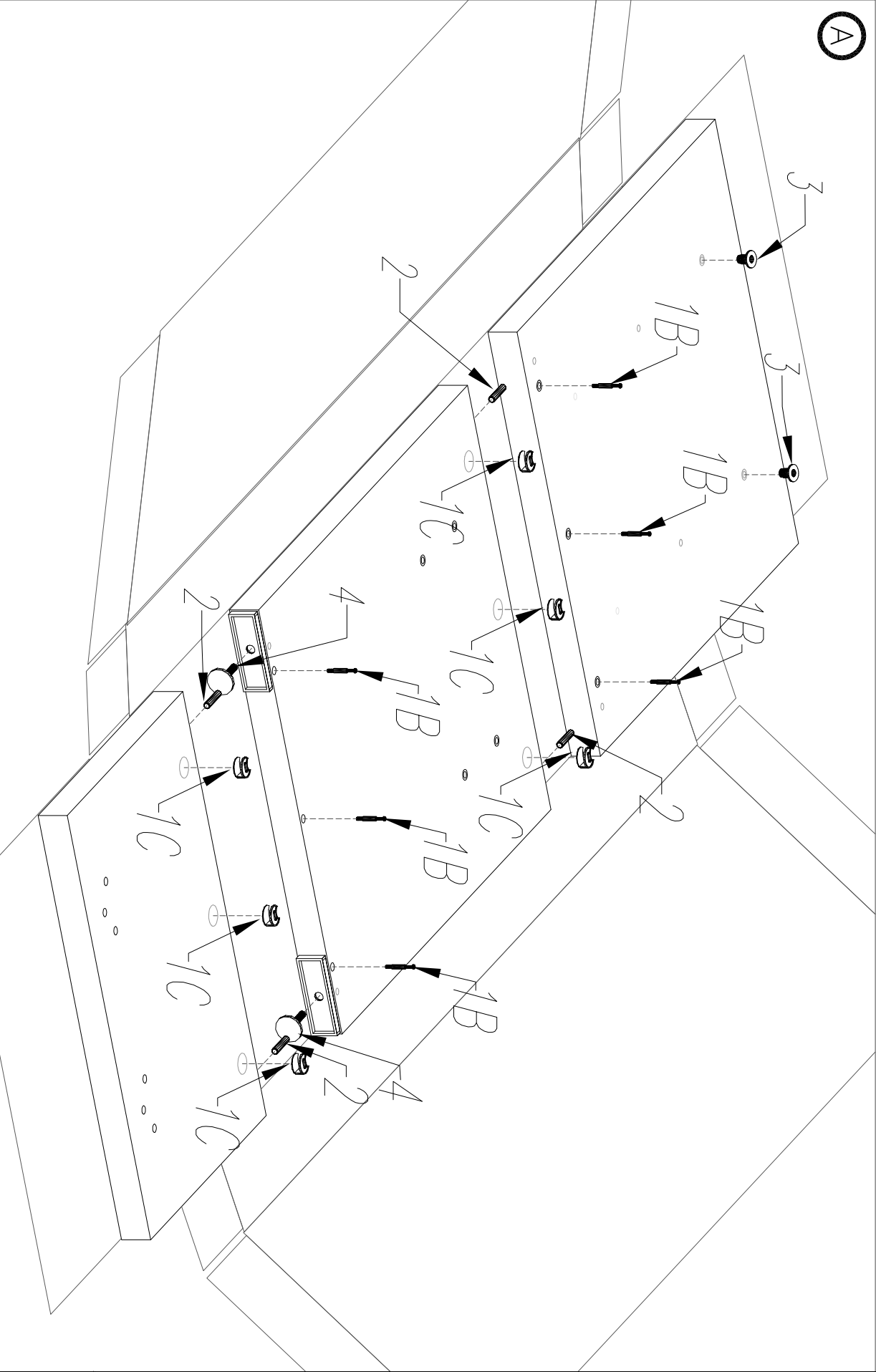

B

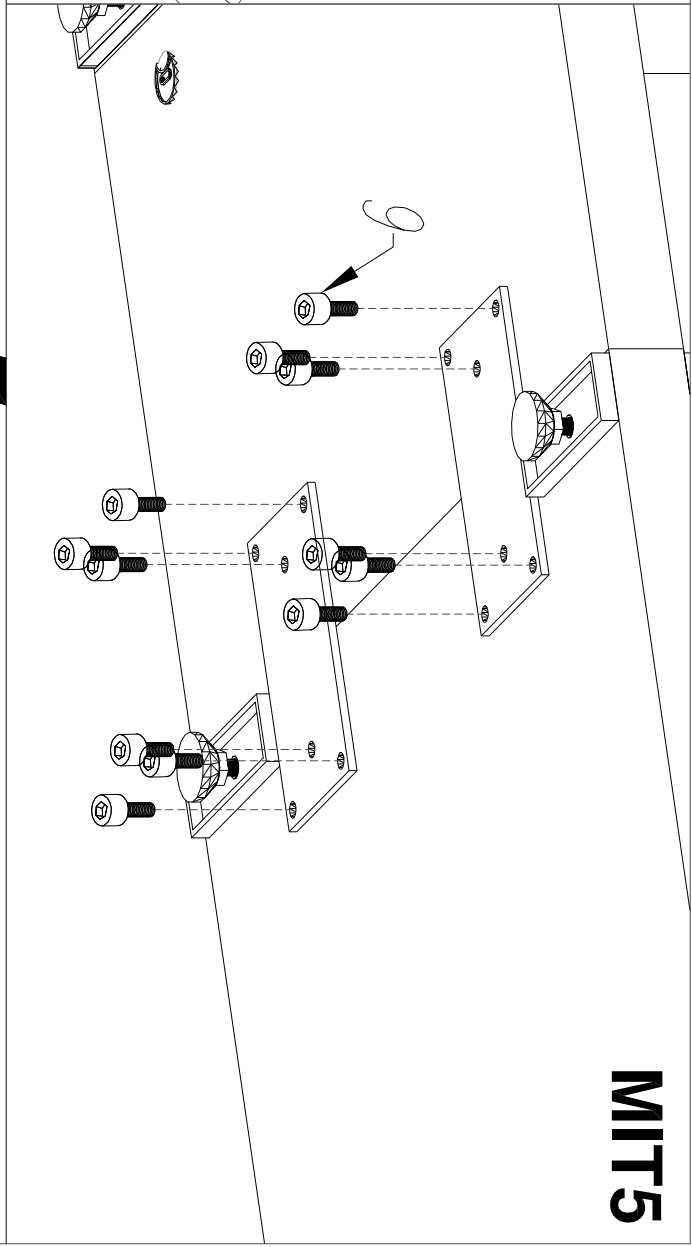
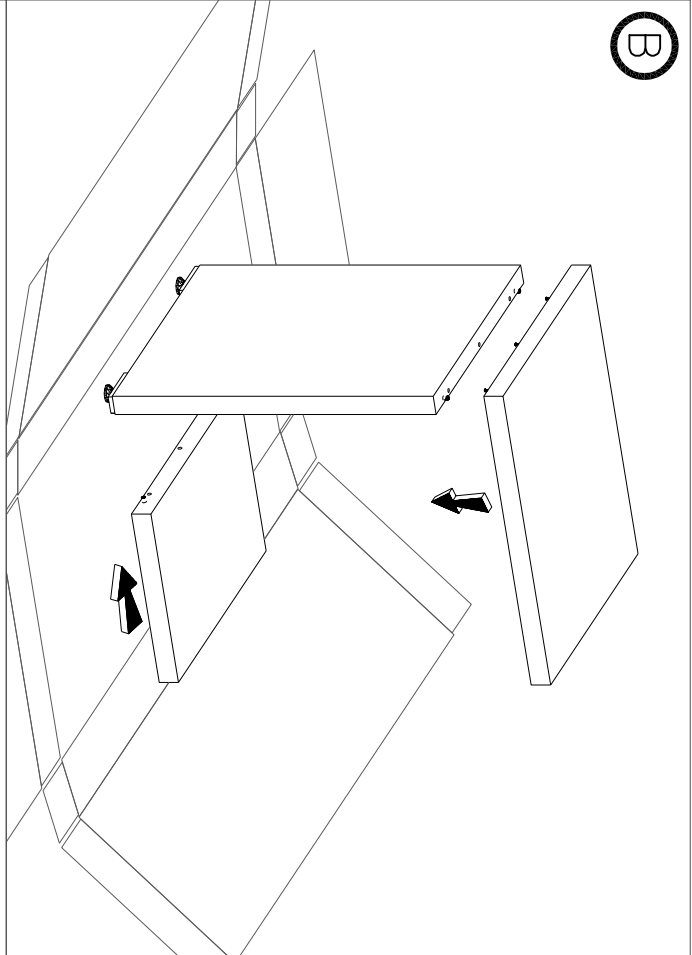

C

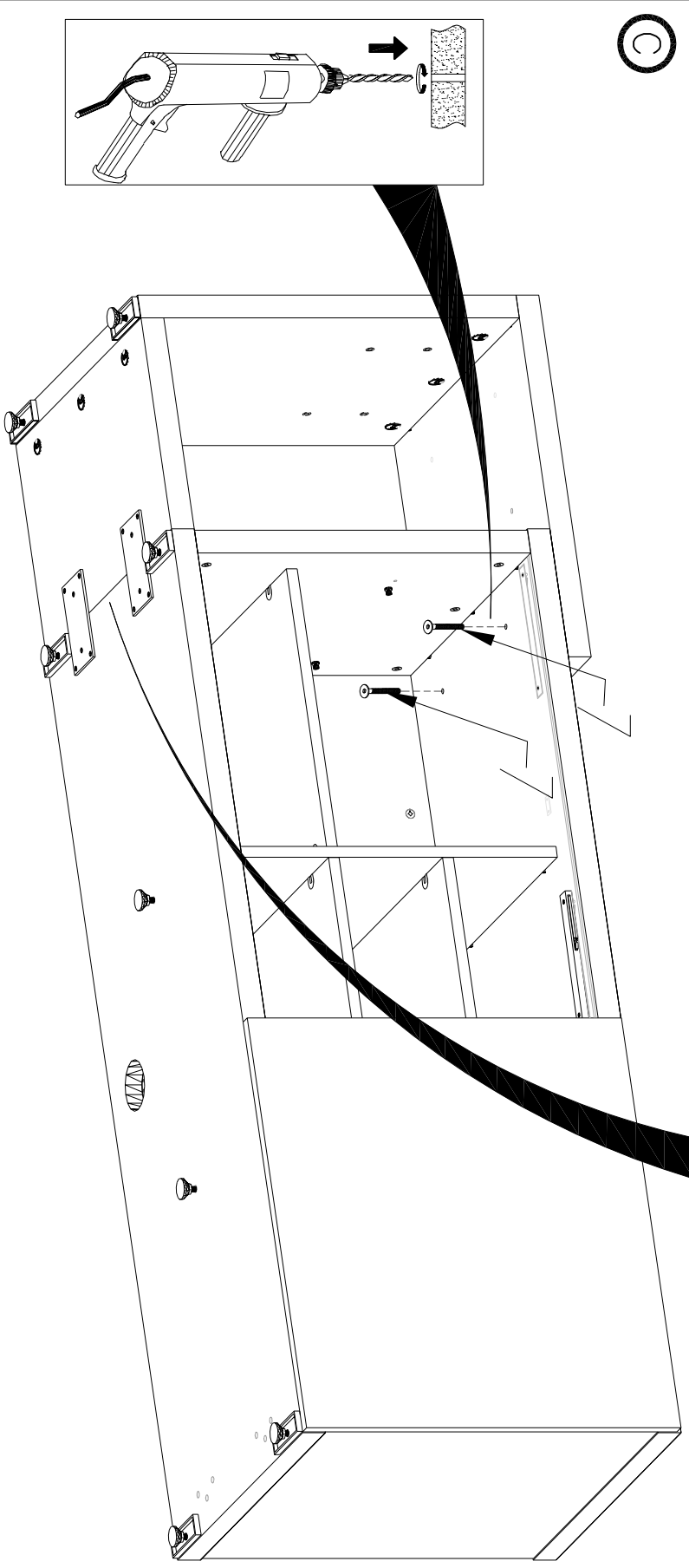
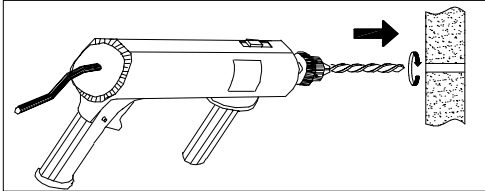

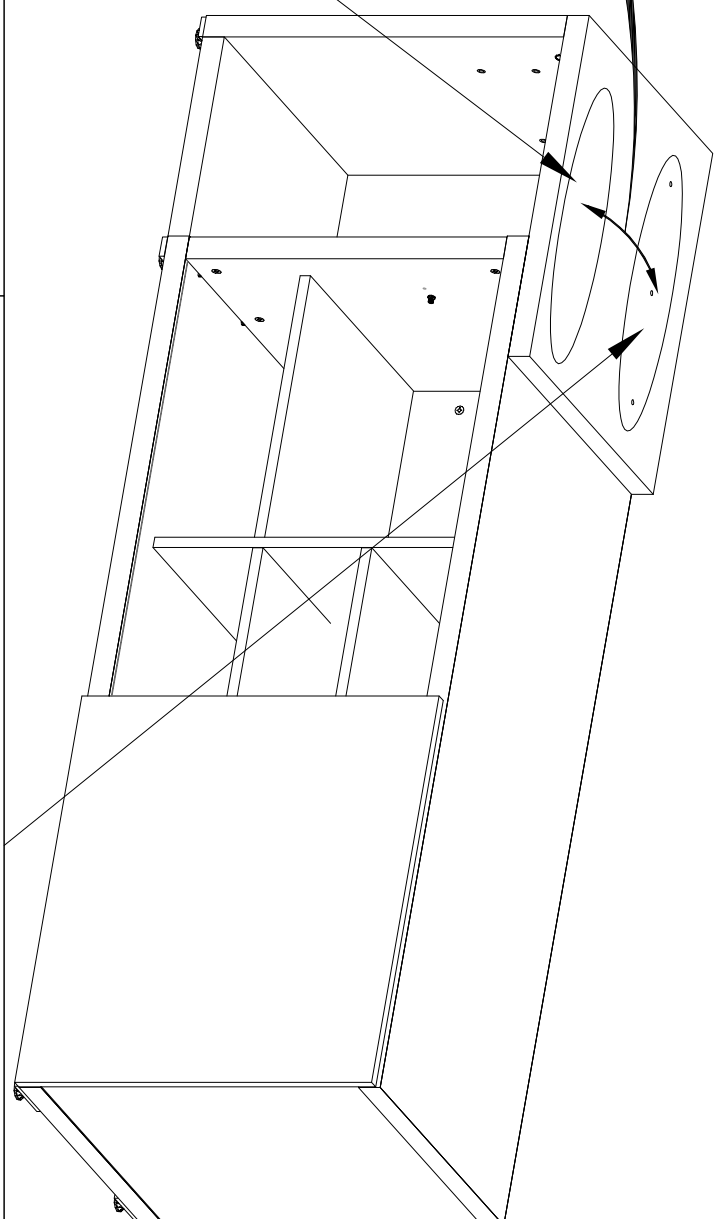
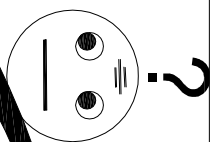
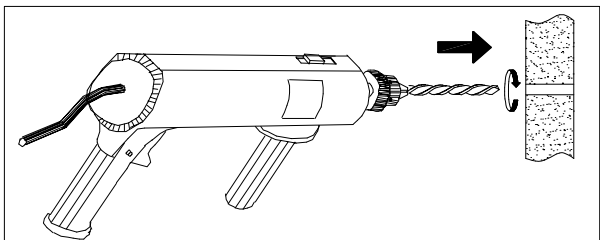

MIT1  
MIT2

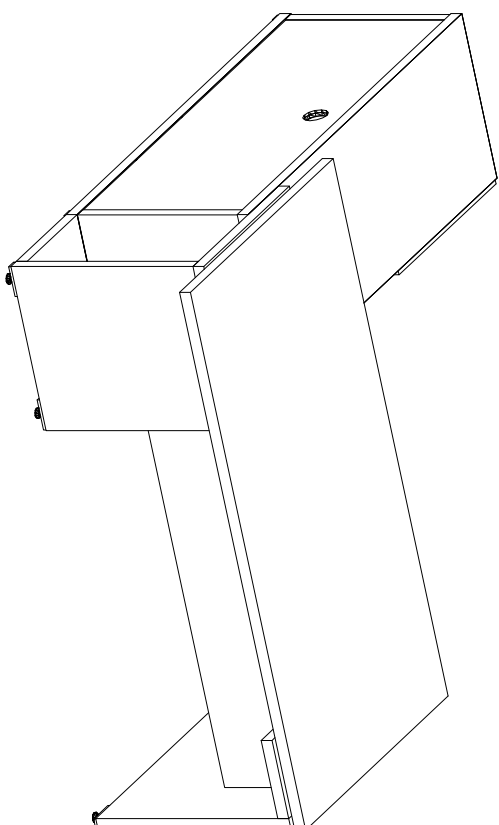
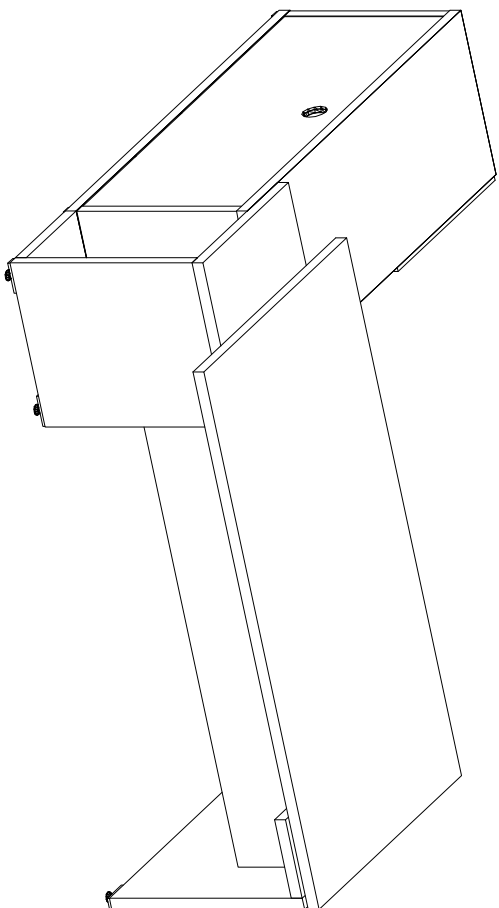





**MIT1**  
**MIT2**

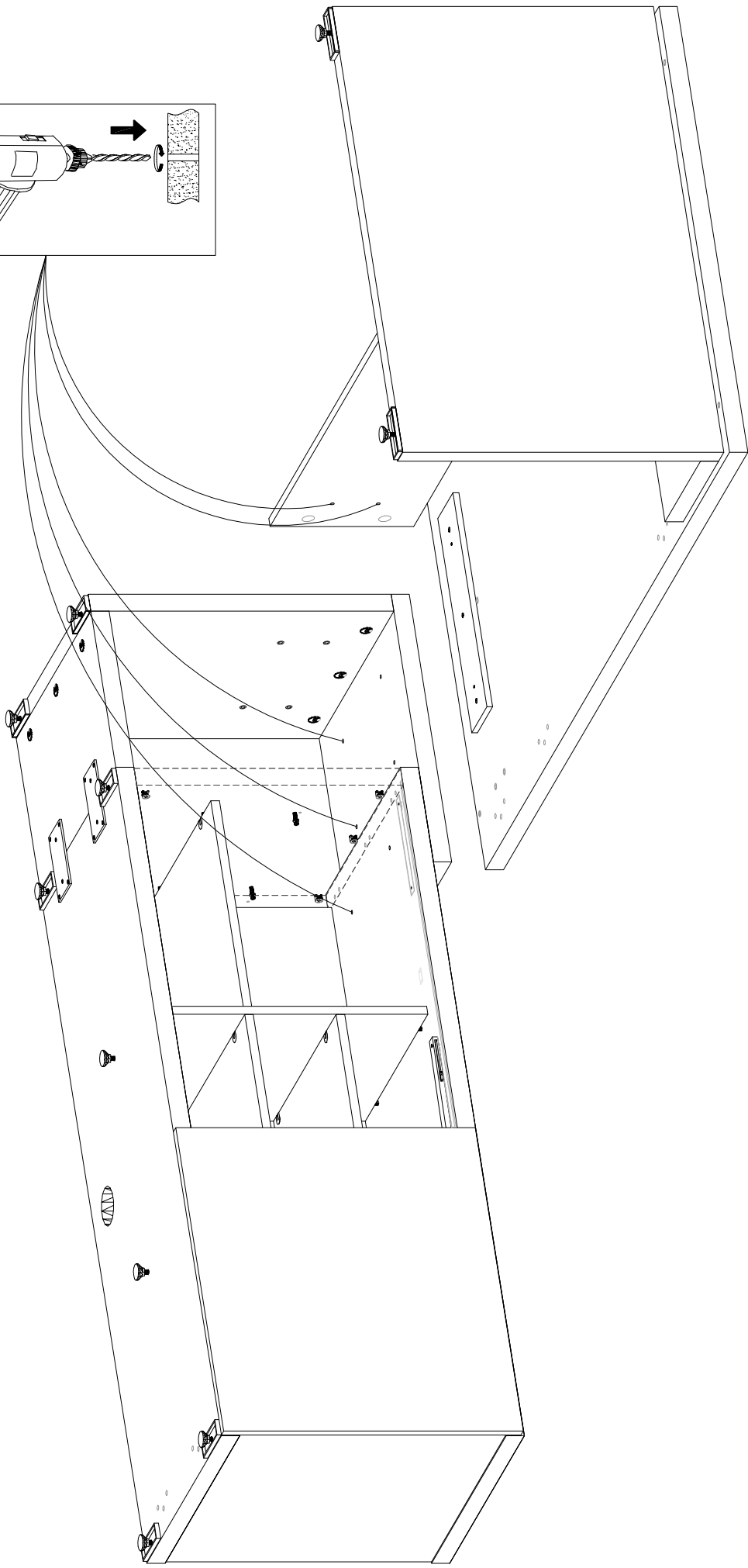
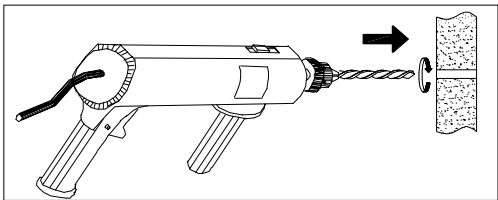

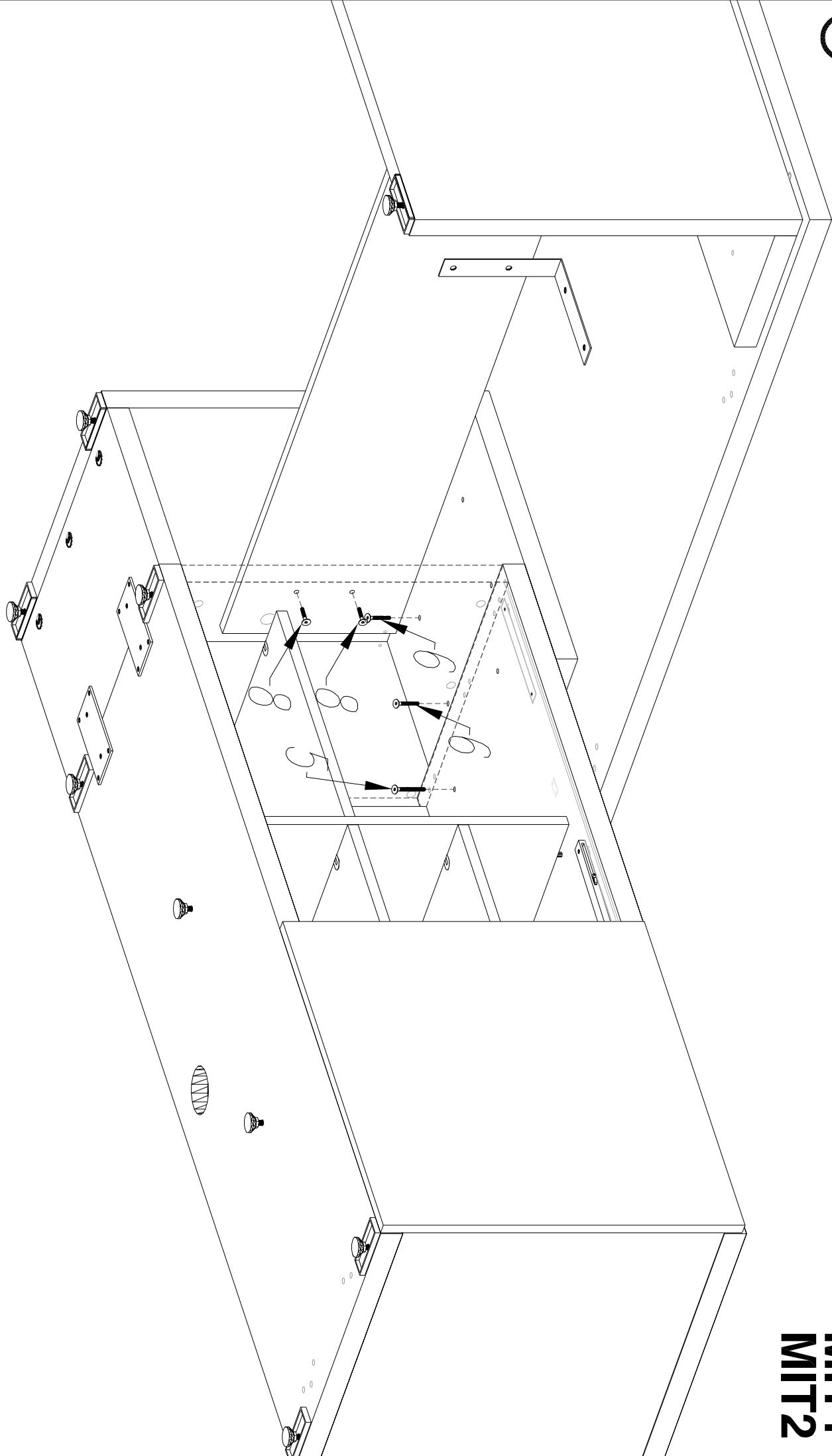

**MIT1**  
**MIT2**

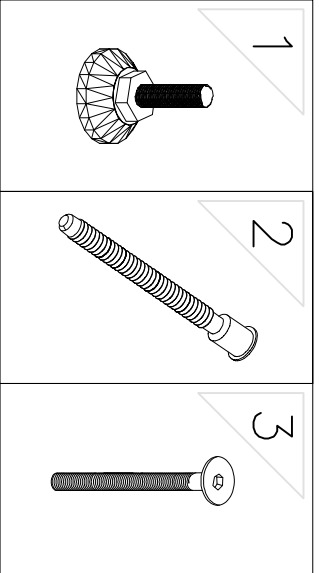

MIT1,2,3,4K

A

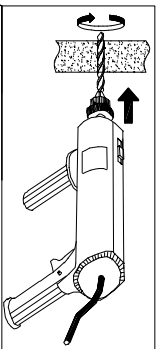
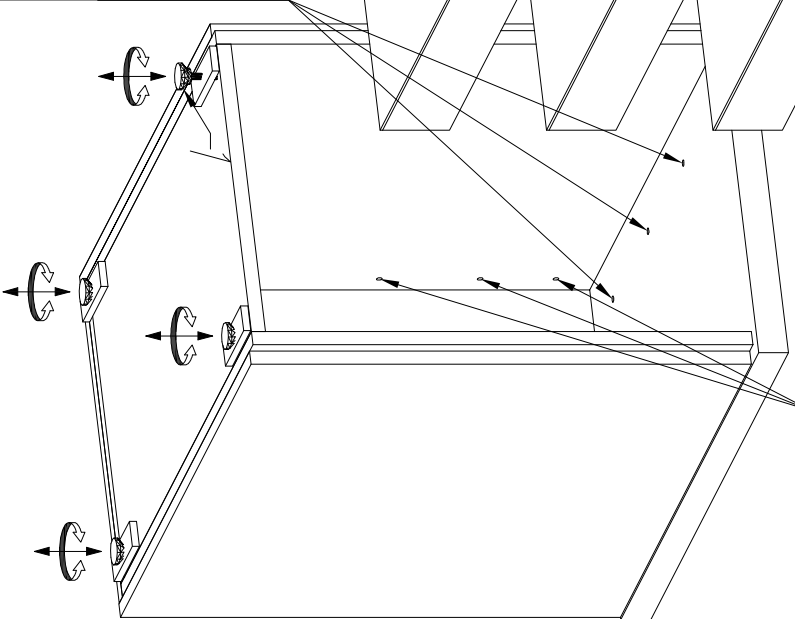
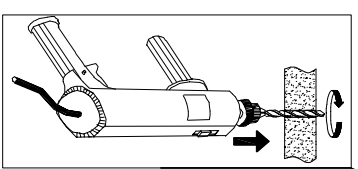

LEFT

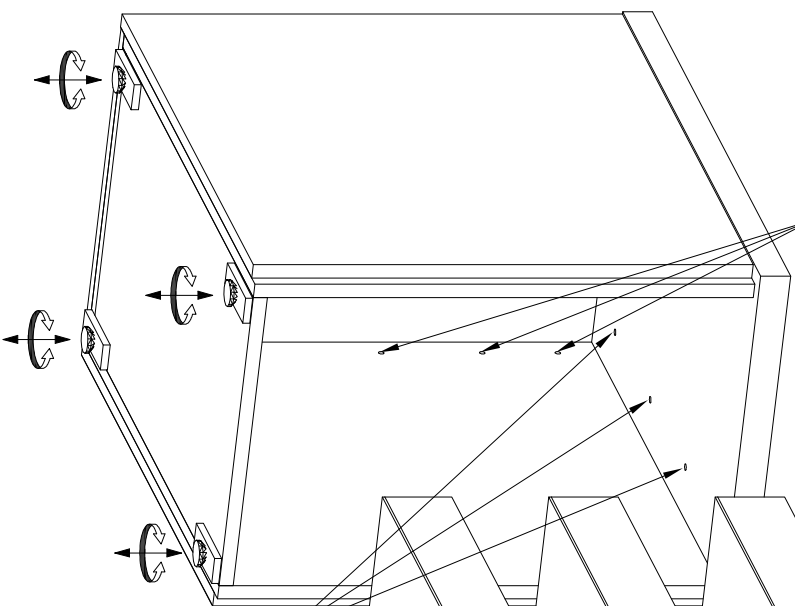
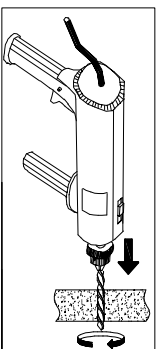
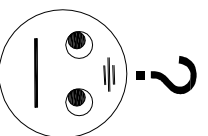

RIGHT

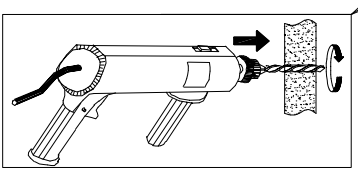

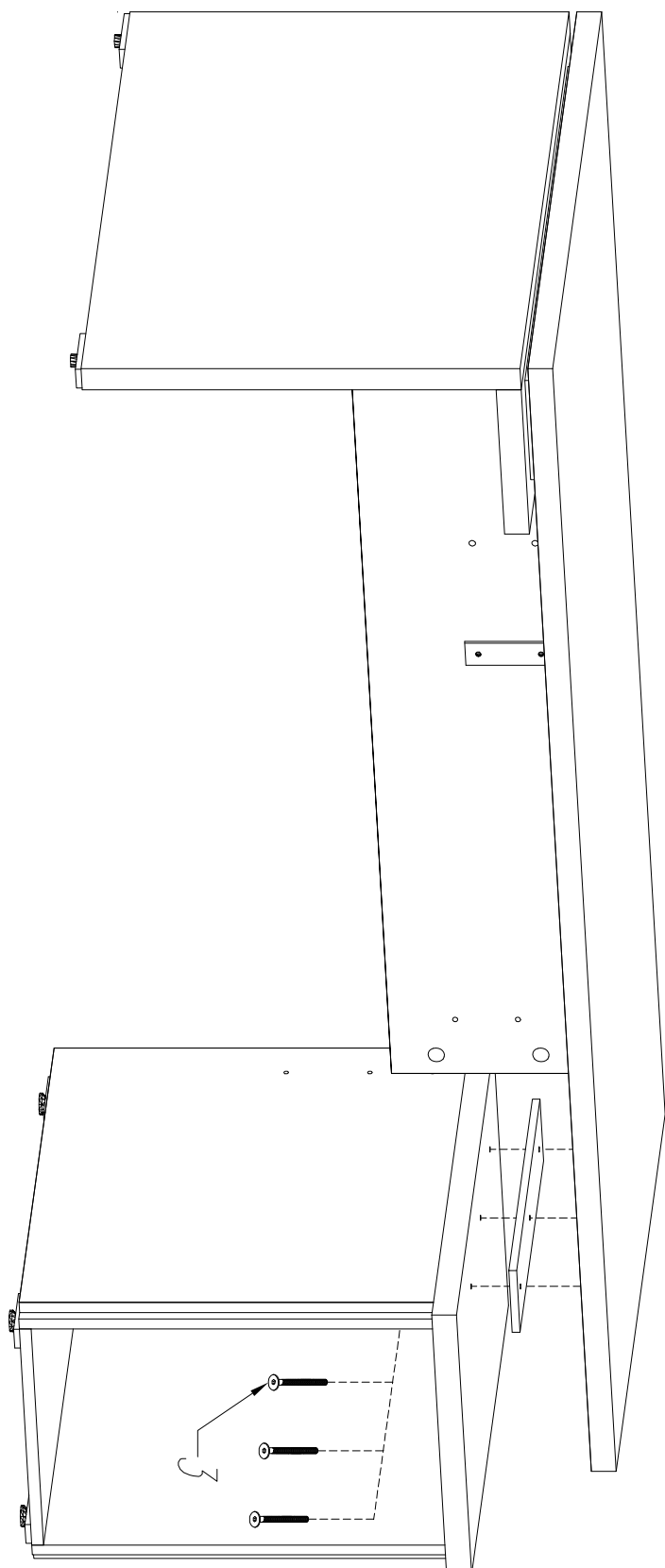
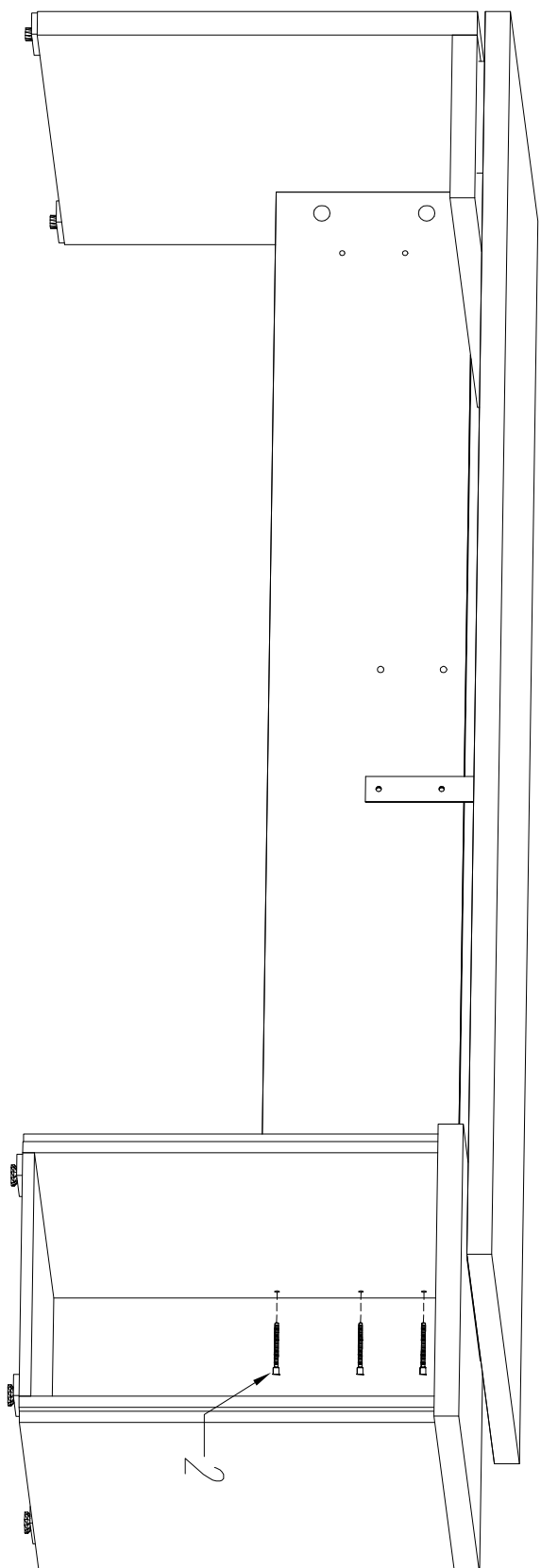

# MEDIAPORT

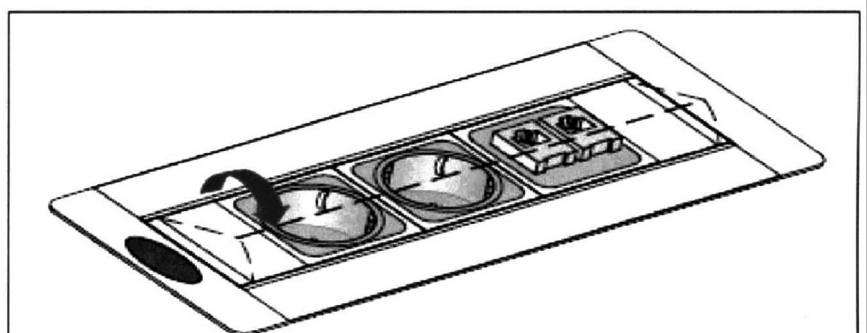
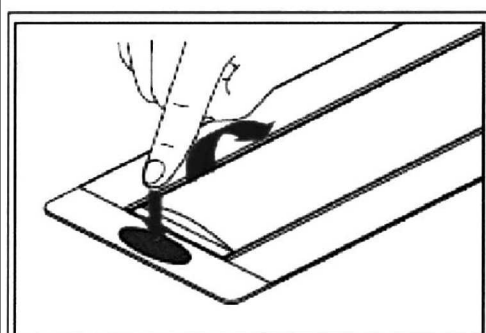
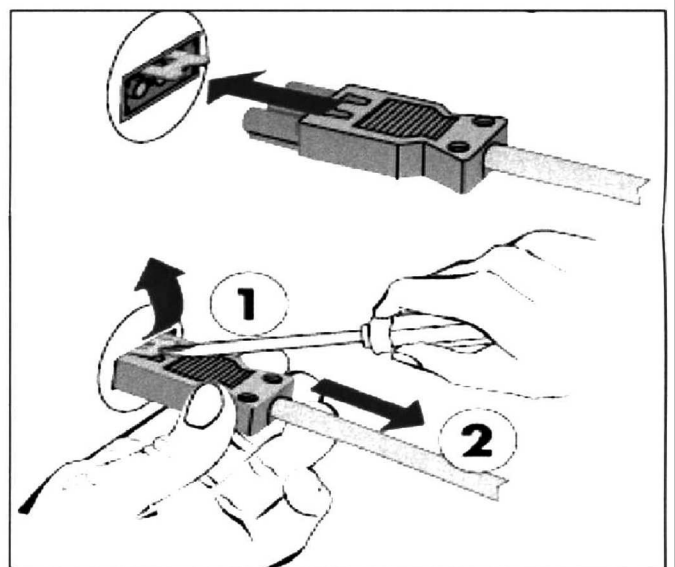
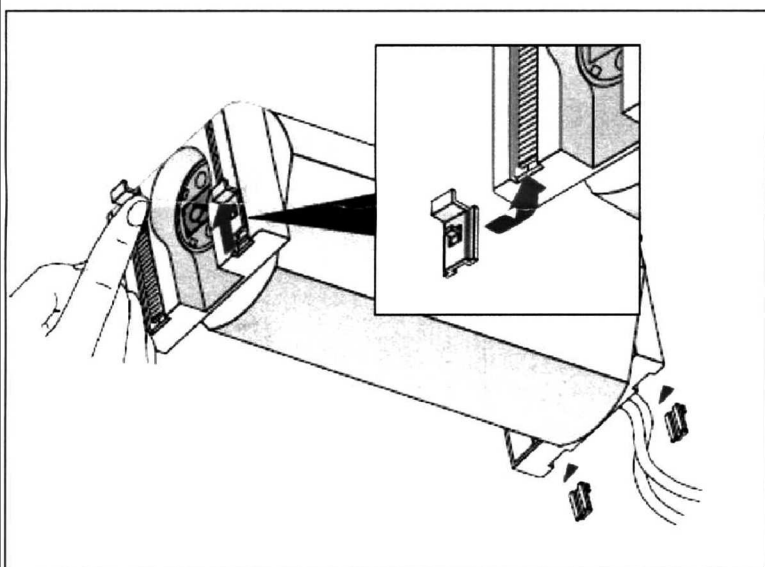
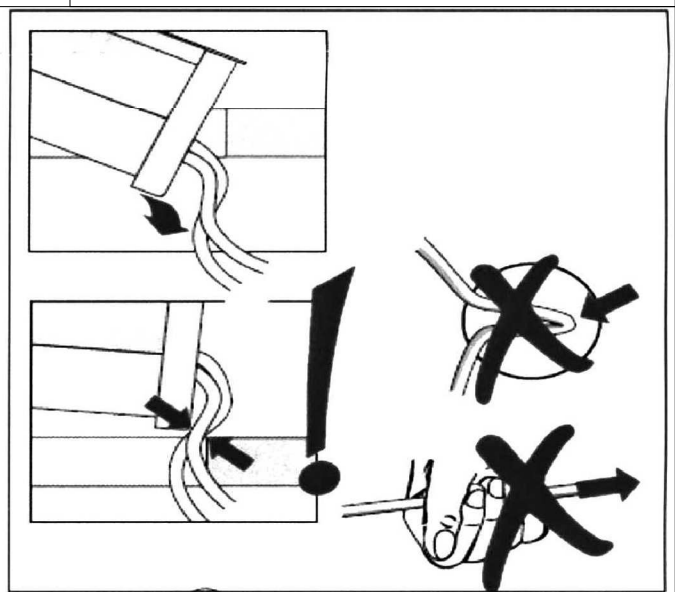
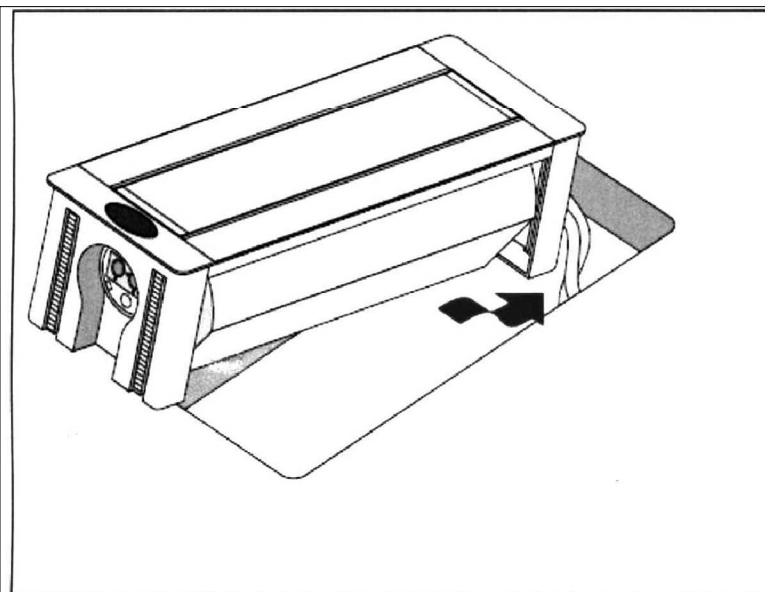

## INSTRUKCJA NAPRAWY ZABLOKOWANEGO MEDIAPORTU

W przypadku kiedy mediaport zostanie zablokowany w pozycji niepełnego otwarcia należy:

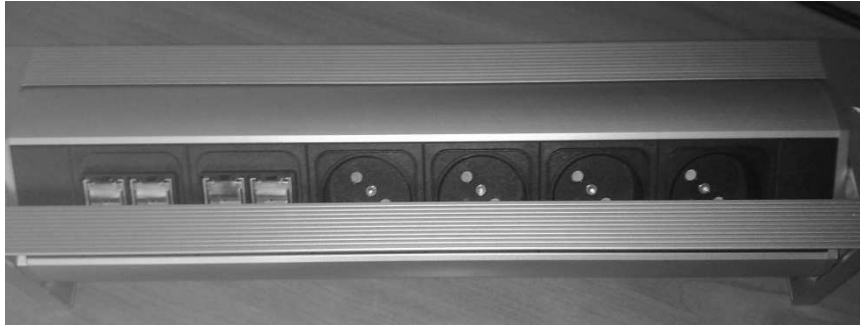

**1.** Zdemontować pokrywę boczną, a następnie upewnić się, że drut sprężynowy jest poprawnie zamontowany w pokrywie bocznej (jak na zdjęciu)



**2.** Zmontować mediaport tak aby dolna część drutu sprężynowego przychodziła pomiędzy dwa trzcienie wystające z korpusu (jak poniżej rysowana linia)

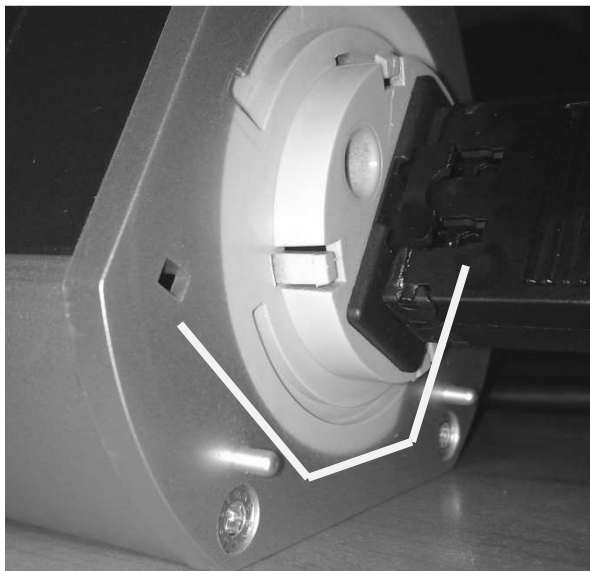

Wrysowana linia przedstawia poprawne ułożenie drutu sprężynowego osadzonego w pokrywie bocznej względem trzpieni wystających z korpusu. Montując pokrywę boczną, w której osadzony jest drut sprężynowy należy upewnić się, że drut jest w położeniu odpowiadającym rysowanej linii na zdjęciu z lewej strony.